

Schwarzplan

⌚ M1:10000

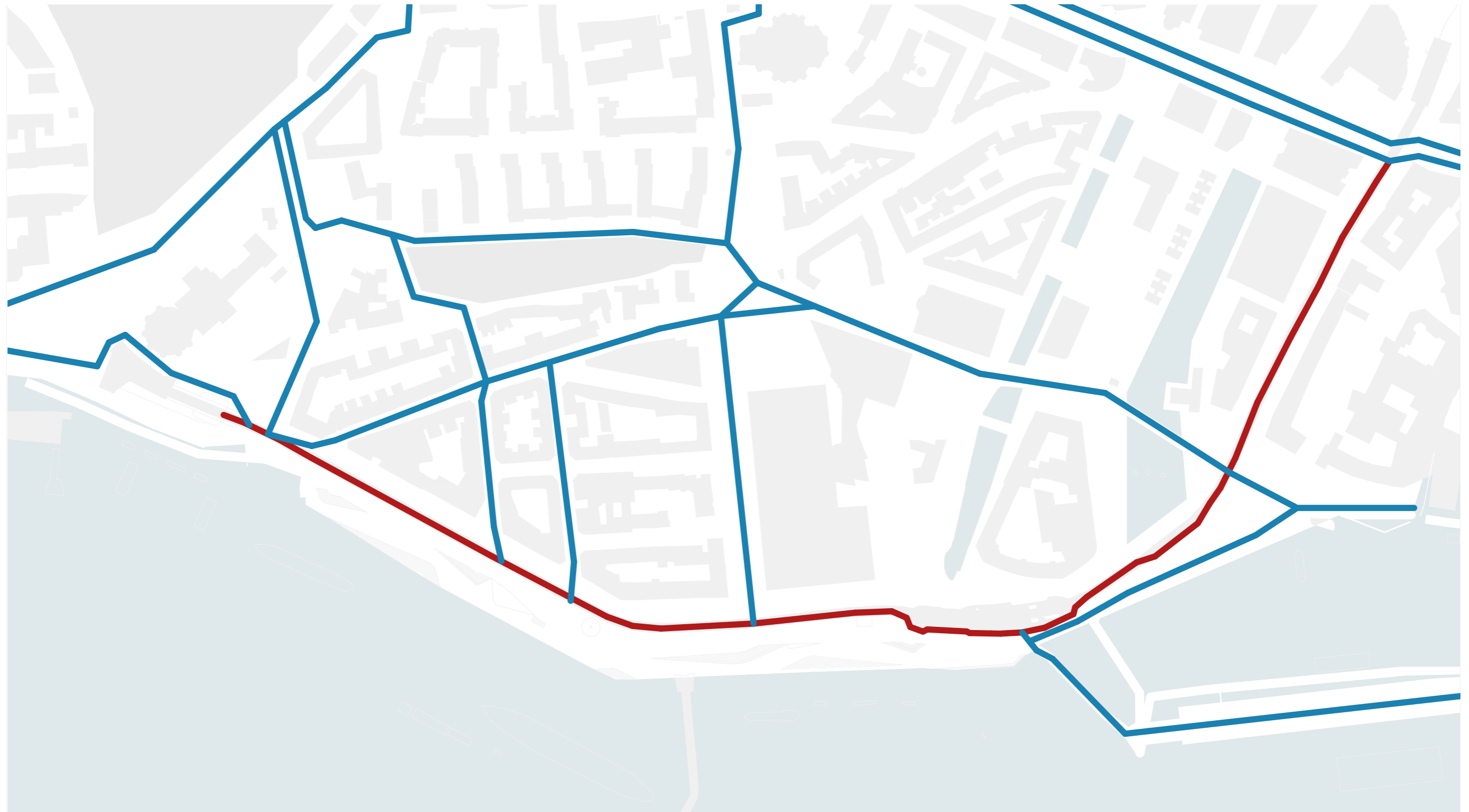

Anschluss an Veloroute



■ Vorhandene Velorouten

■ Ergänzung

Entwurfsidee



RADSCHNELLWEG

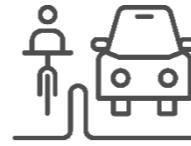

SICHERES RADFAHREN



OUTDOOR SPORT



BAUEN IM BESTAND

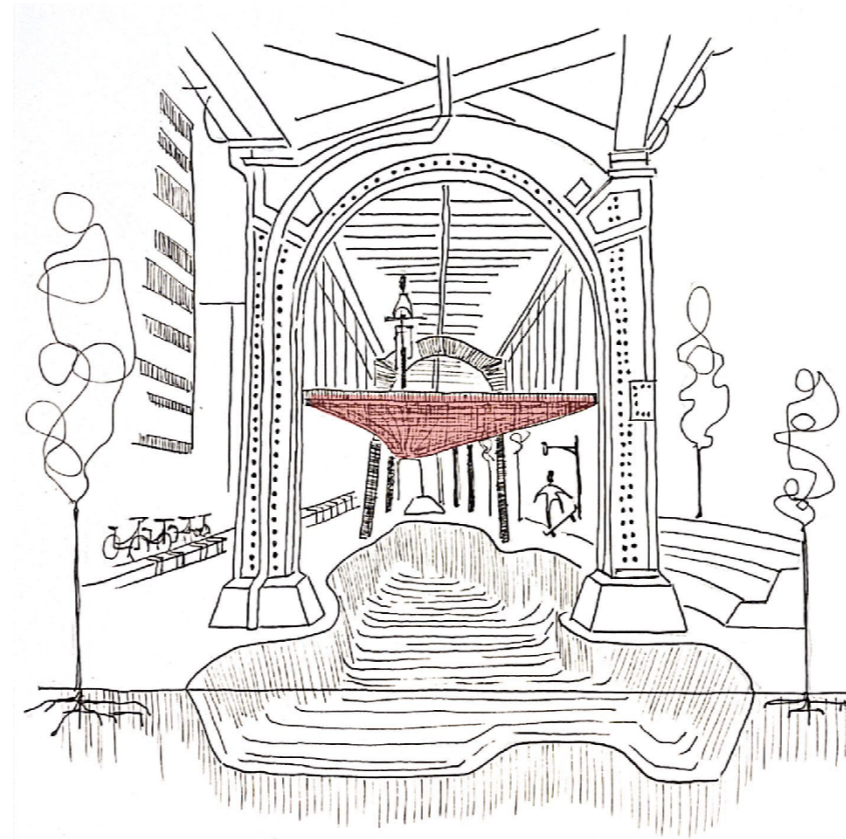

FAHRRAD - LERN - STRECKE



WETTERGESCHÜTZT



ATTRAKTION



GRÜNRAUM IN DER STADT

Lageplan

🕒 M1:7500

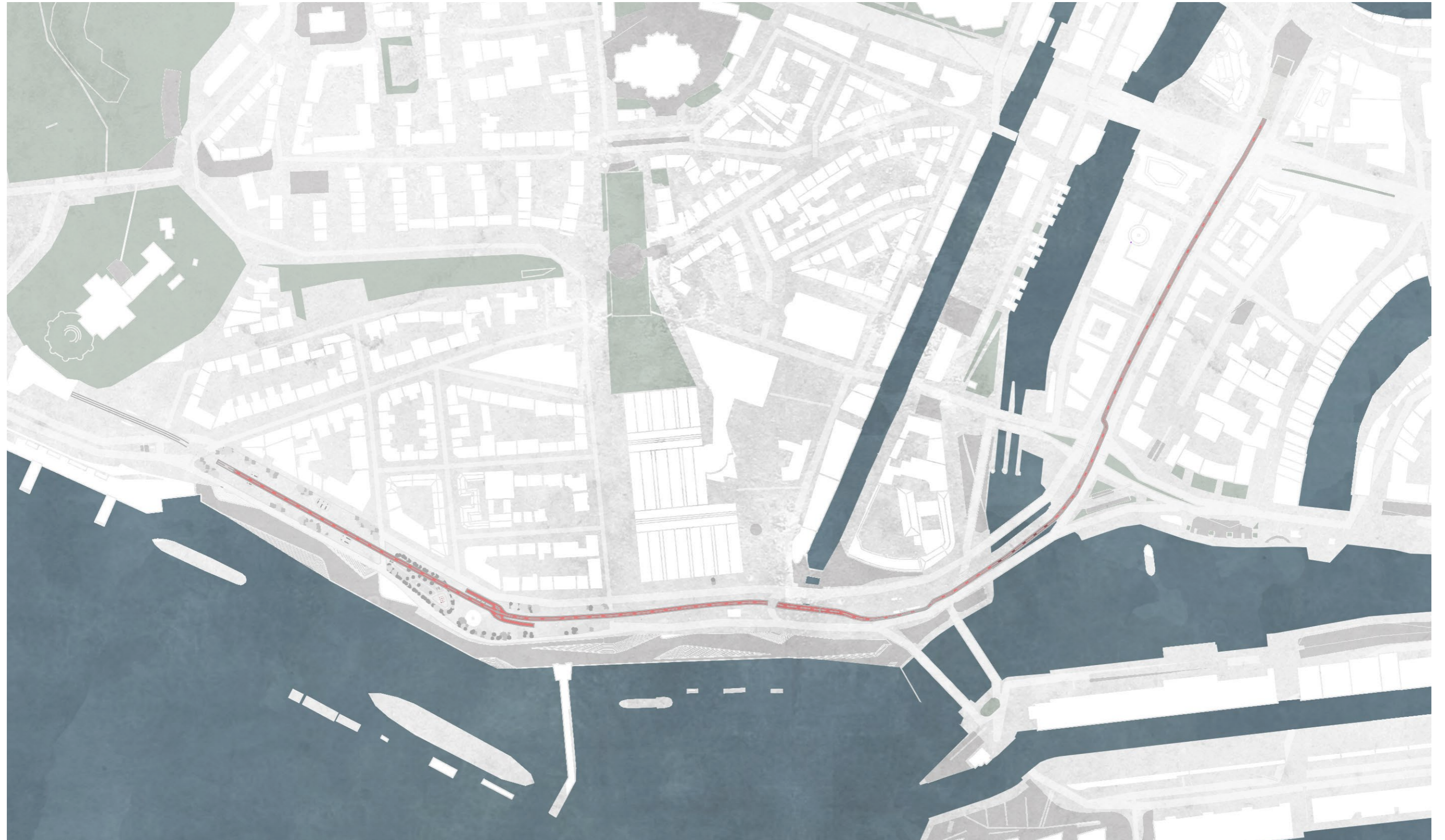

Ansichten Abschnitt I

M1:500

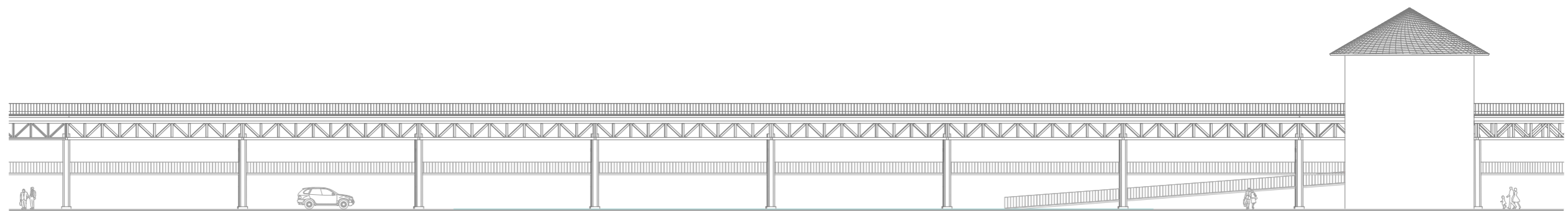
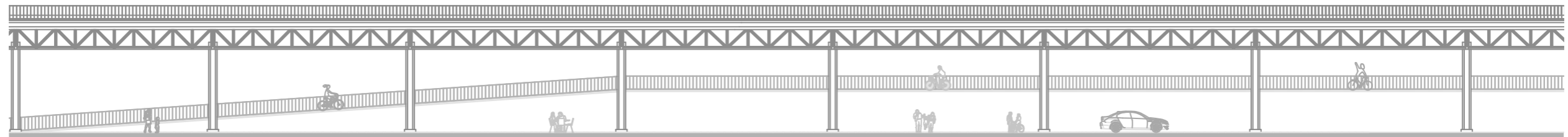

Ansichten Abschnitt I

M1:500

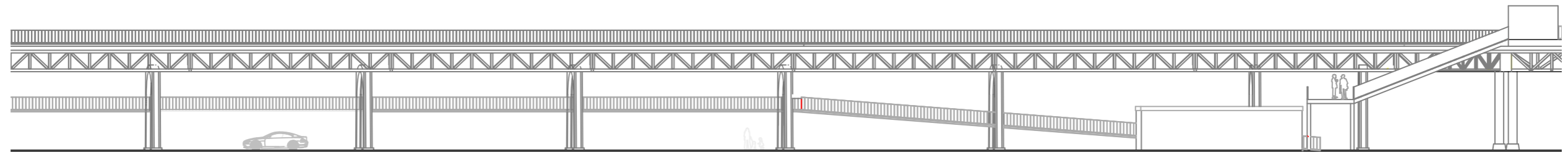
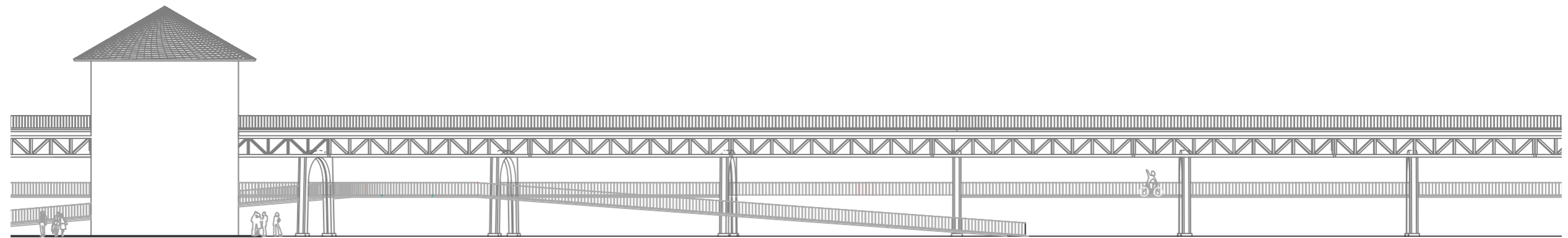

Konstruktion

Abgehängte Brücke

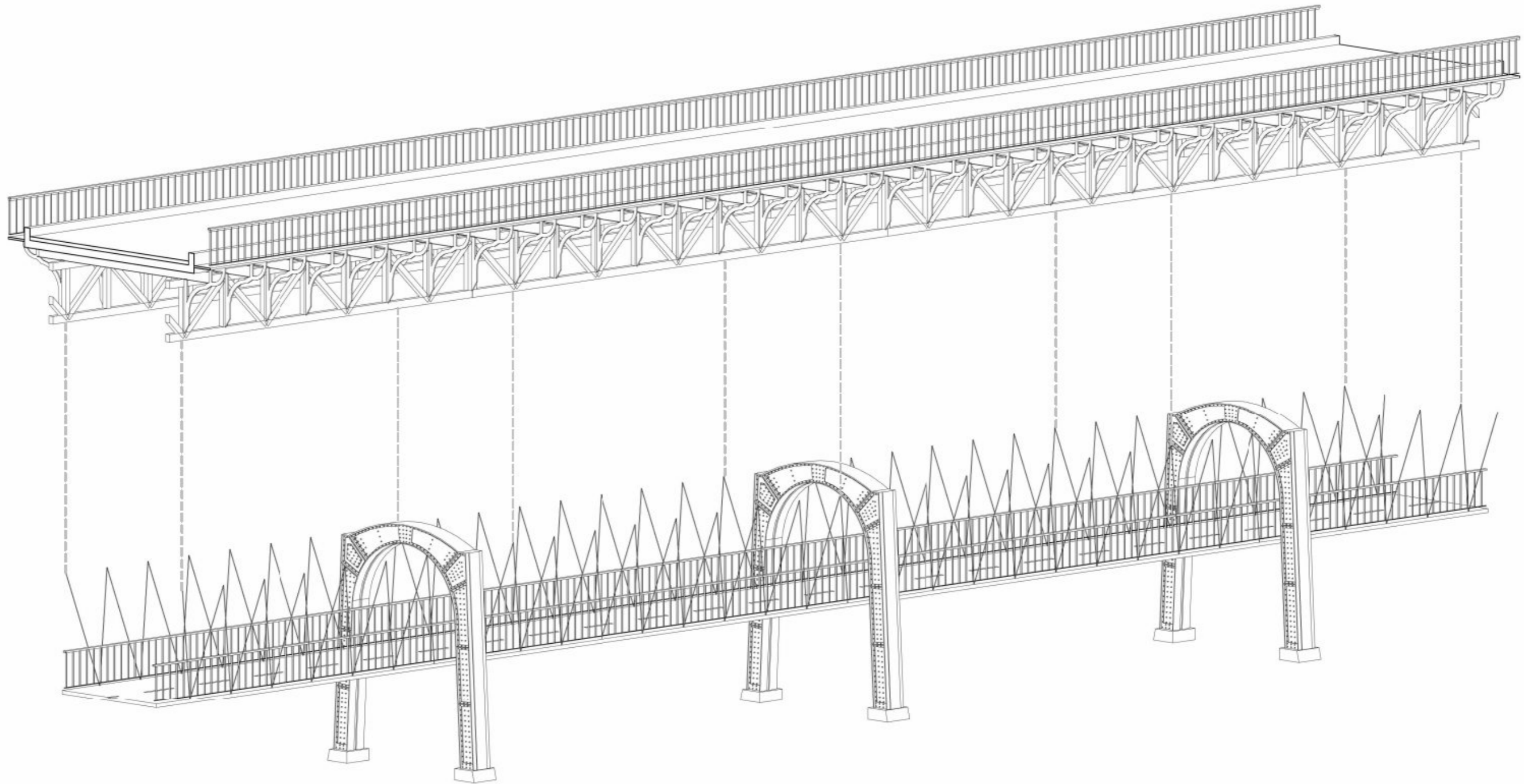

Konstruktion

Abgehängte Brücke

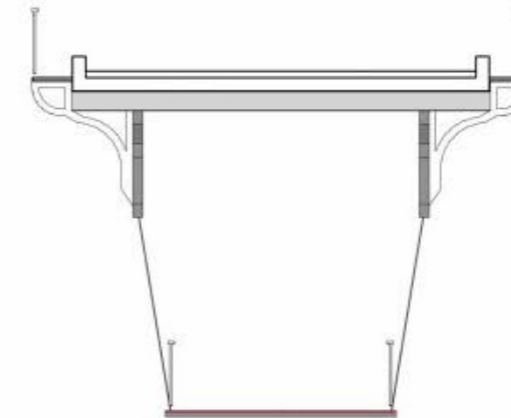
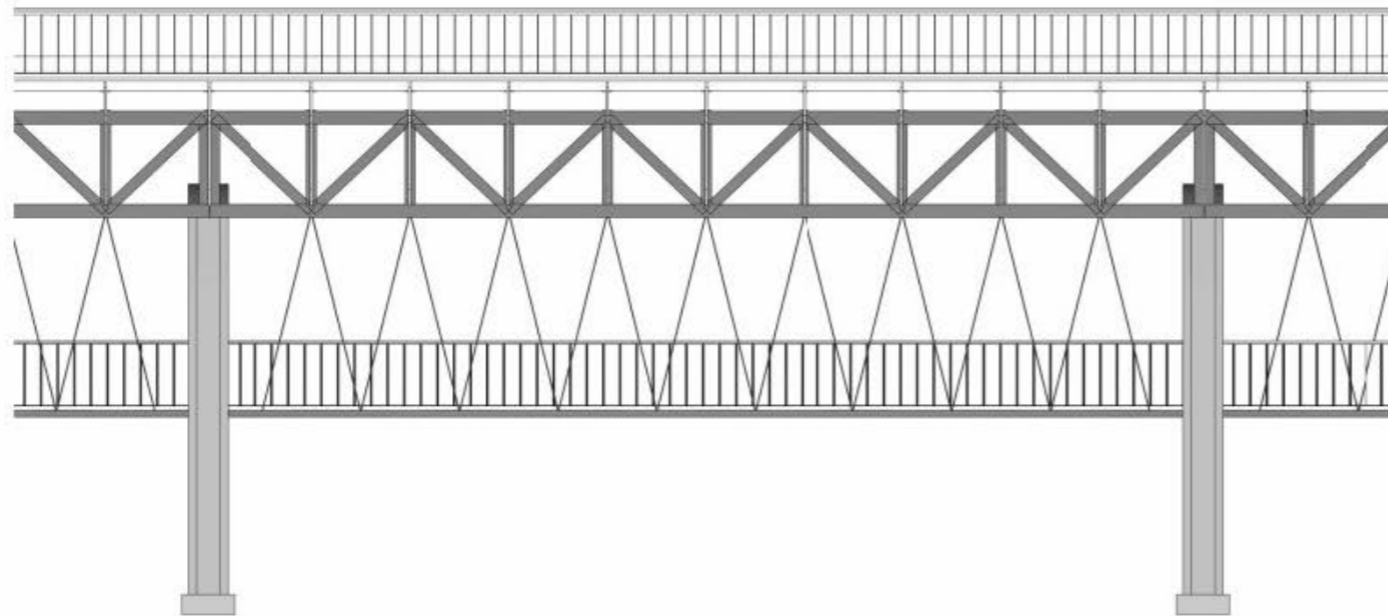
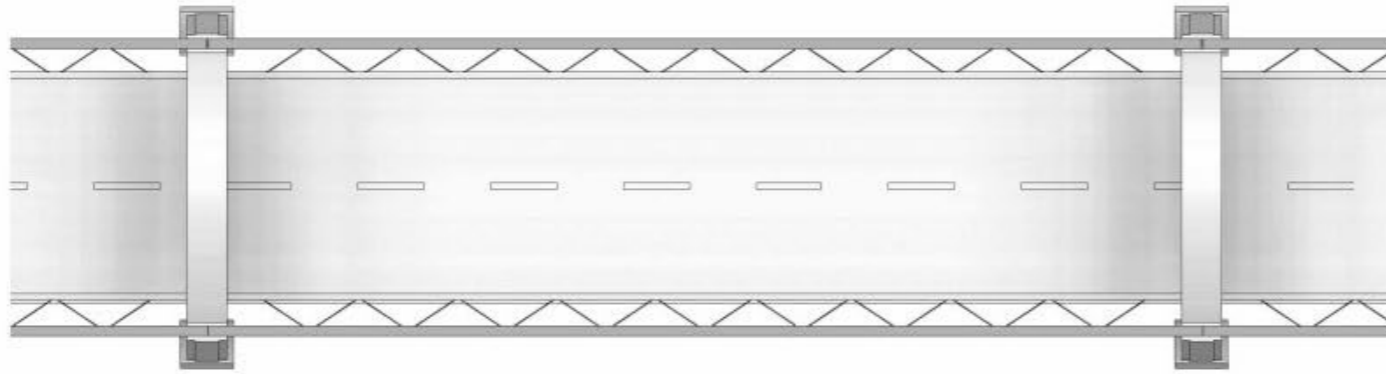

Auffahrt/Steigung

Abgehängte Brücke

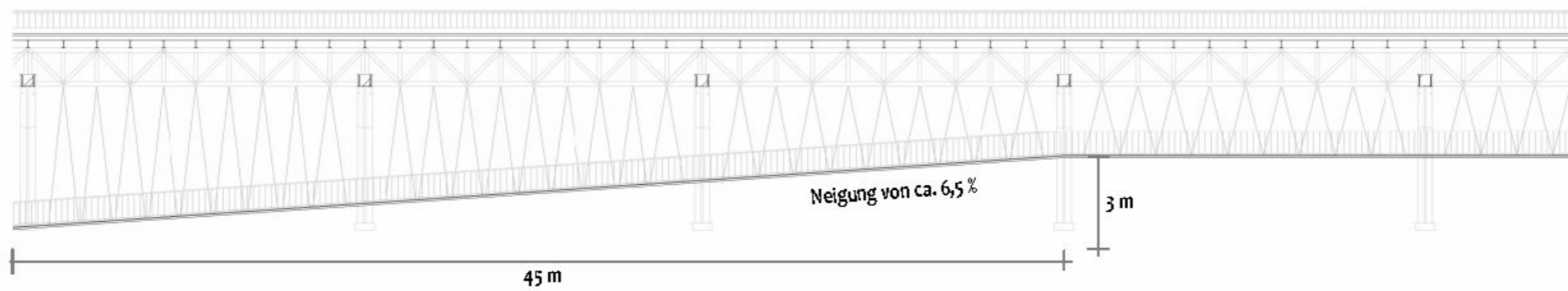
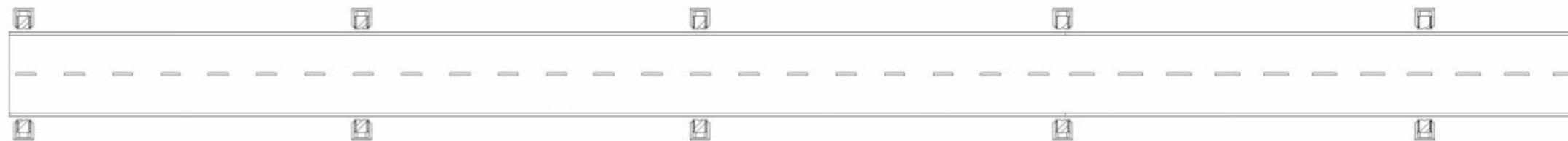
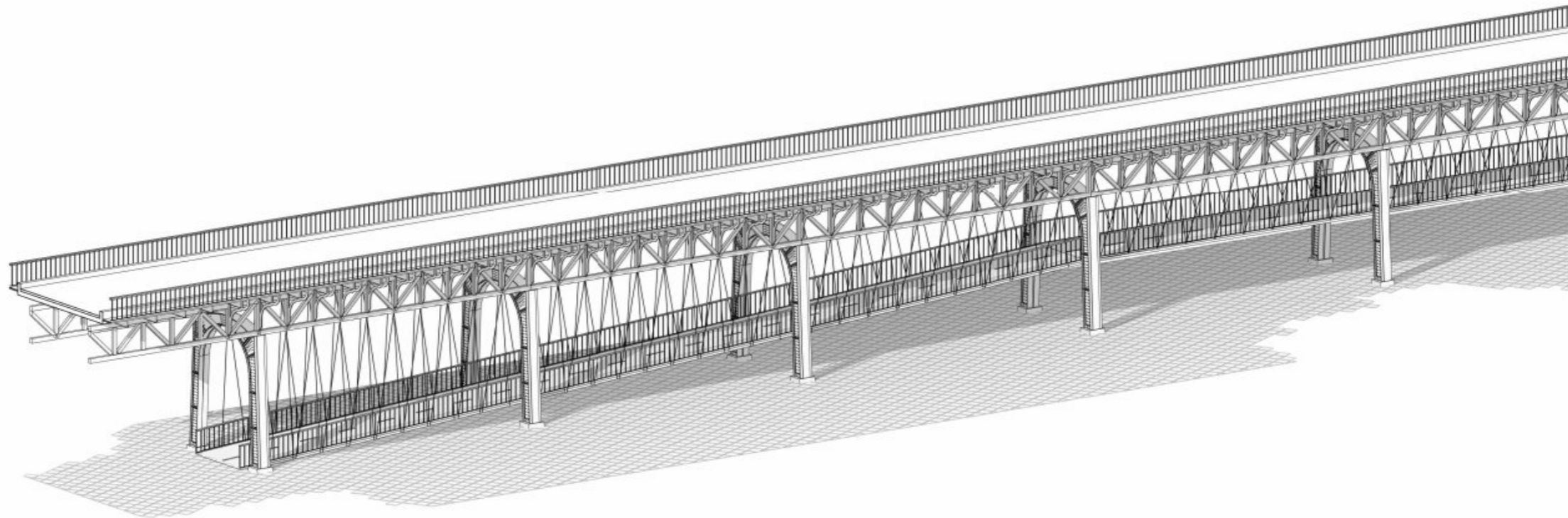

Grundriss Verteilerplatz

⌚ M1:500



Aufsicht Verteilerplatz

🕒 M1:500



Ansicht Verteilerplatz

M1:500



Perspektive Verteilerplatz

M1:500



Grundriss Traffic Park

⌚ M1:500

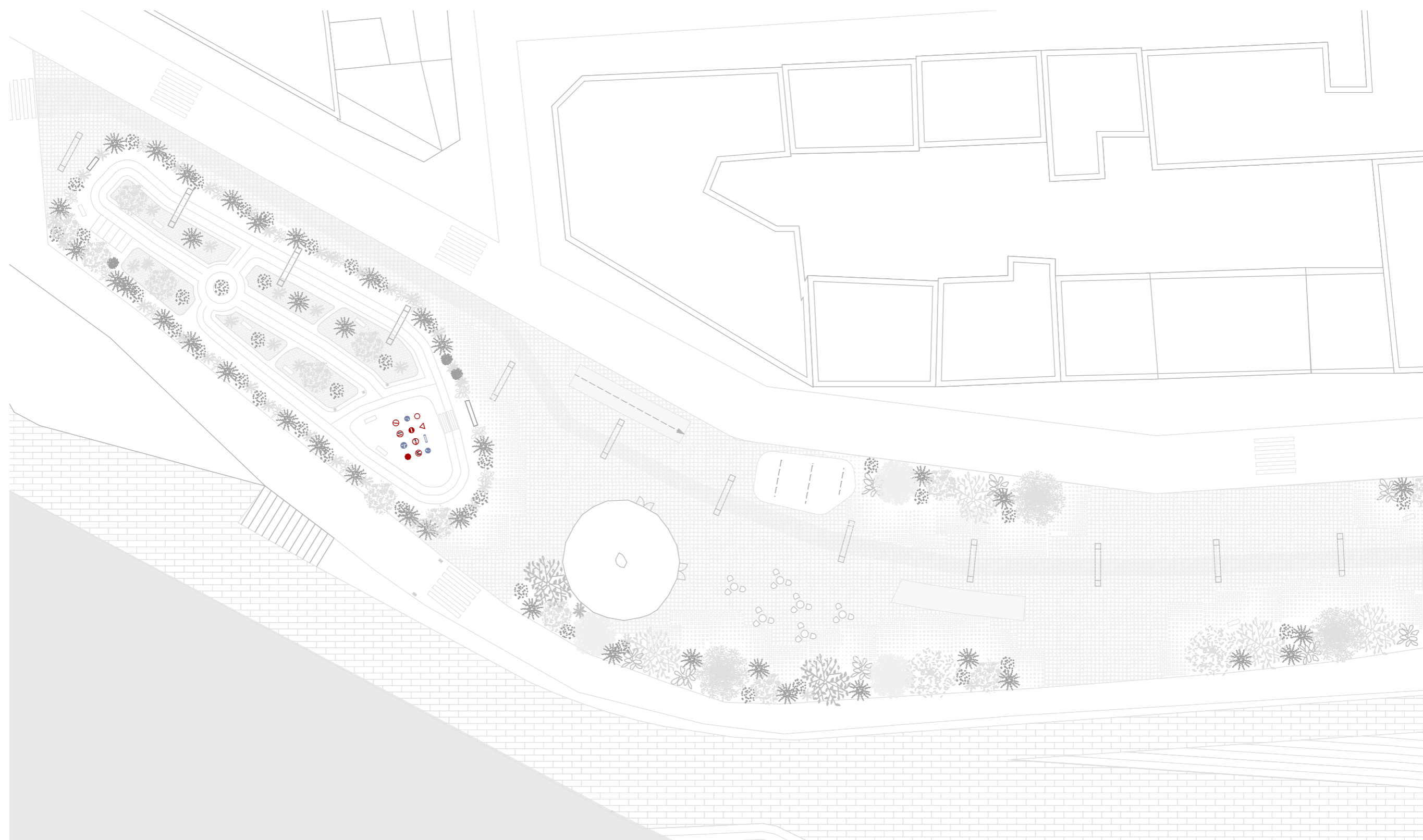

Aufsicht Traffic Park

🕒 M1:500

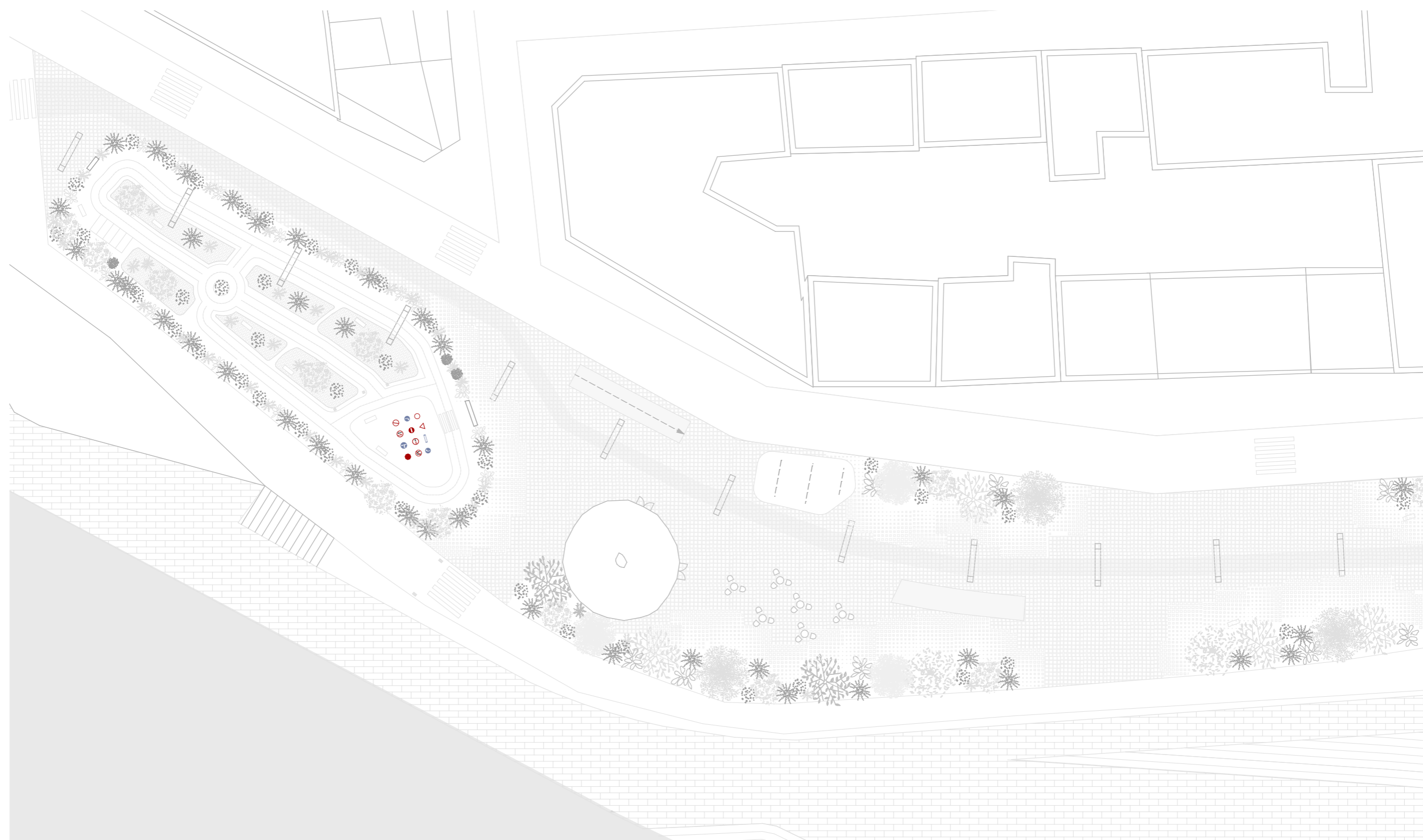

Perspektive Traffic Park



Abfahrt Kreisverkehr

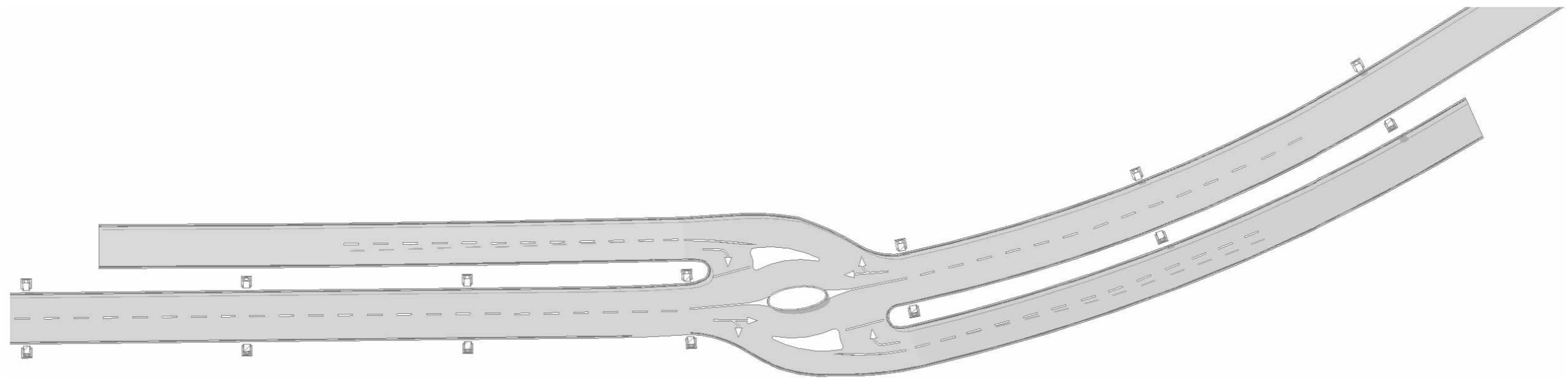
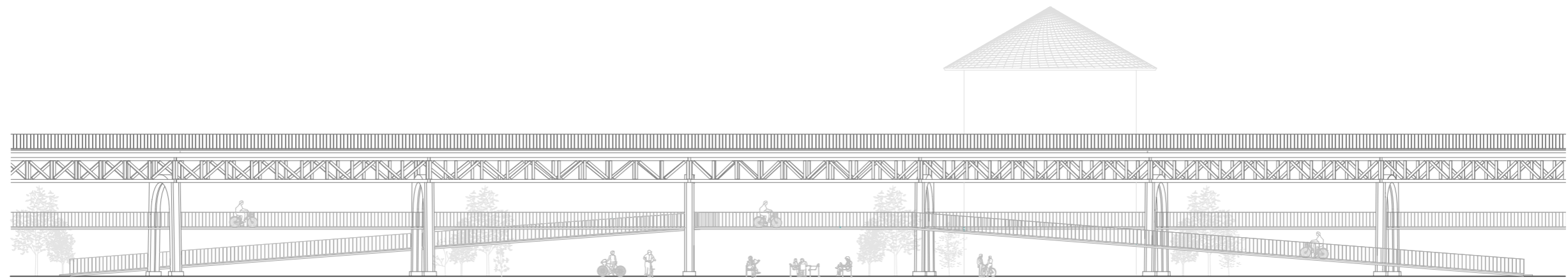

Ansicht Abfahrt

M1:200



Perspektive Kreisverkehr



Grundriss Skatepark

🕒 M1:500

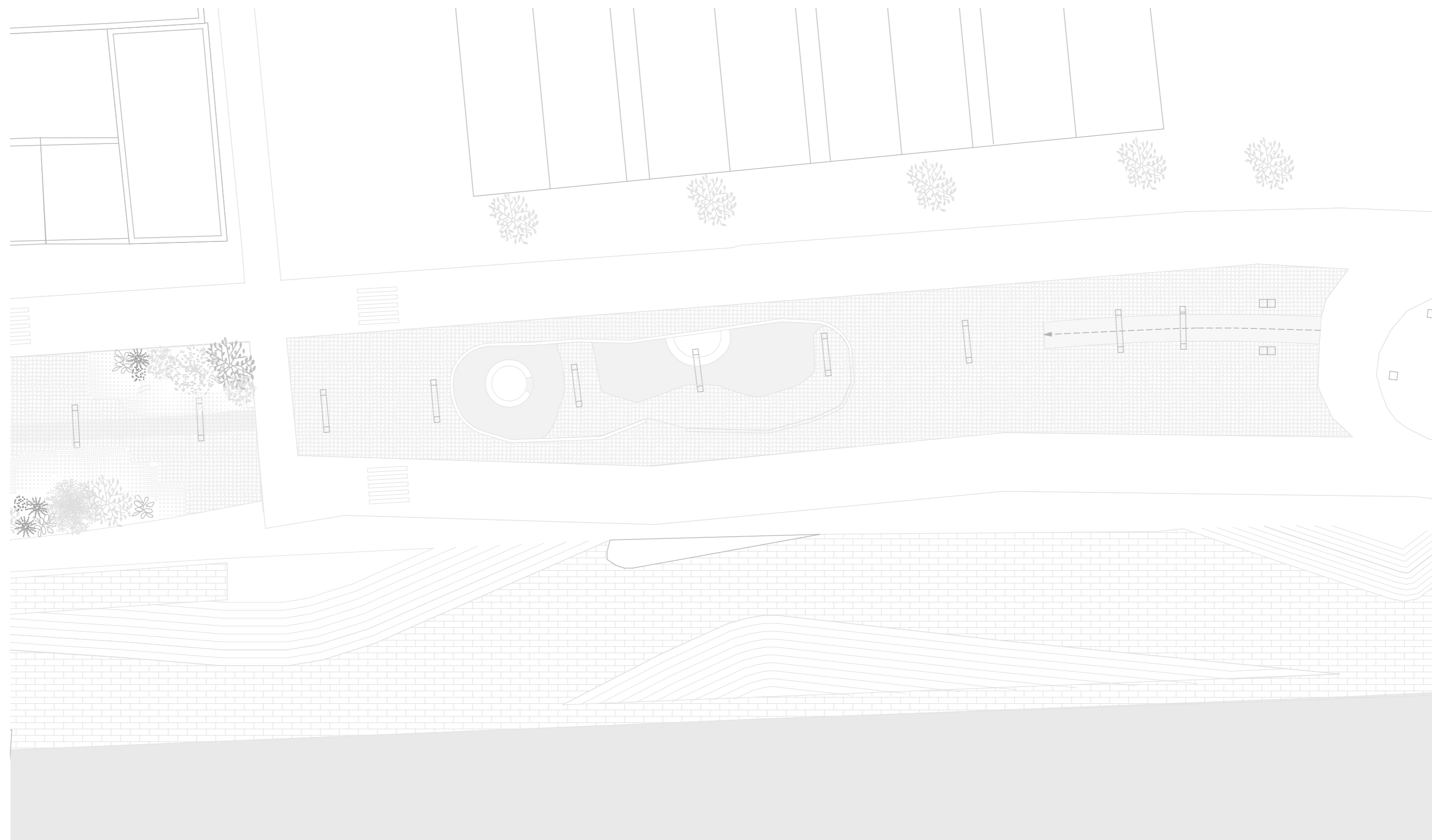

Aufsicht Skatepark

🕒 M1:500

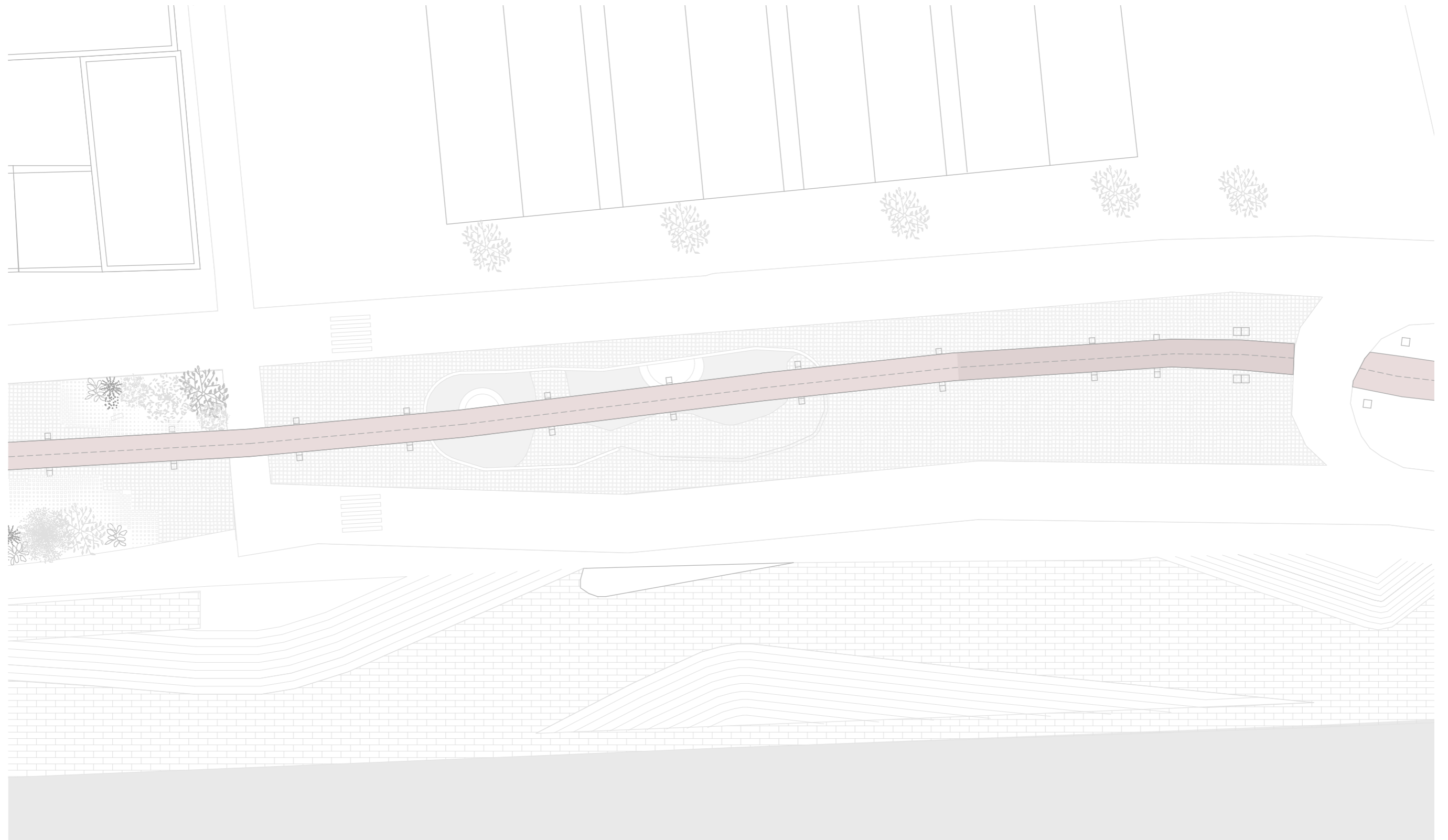

Schnitt Skatepark

M1:100

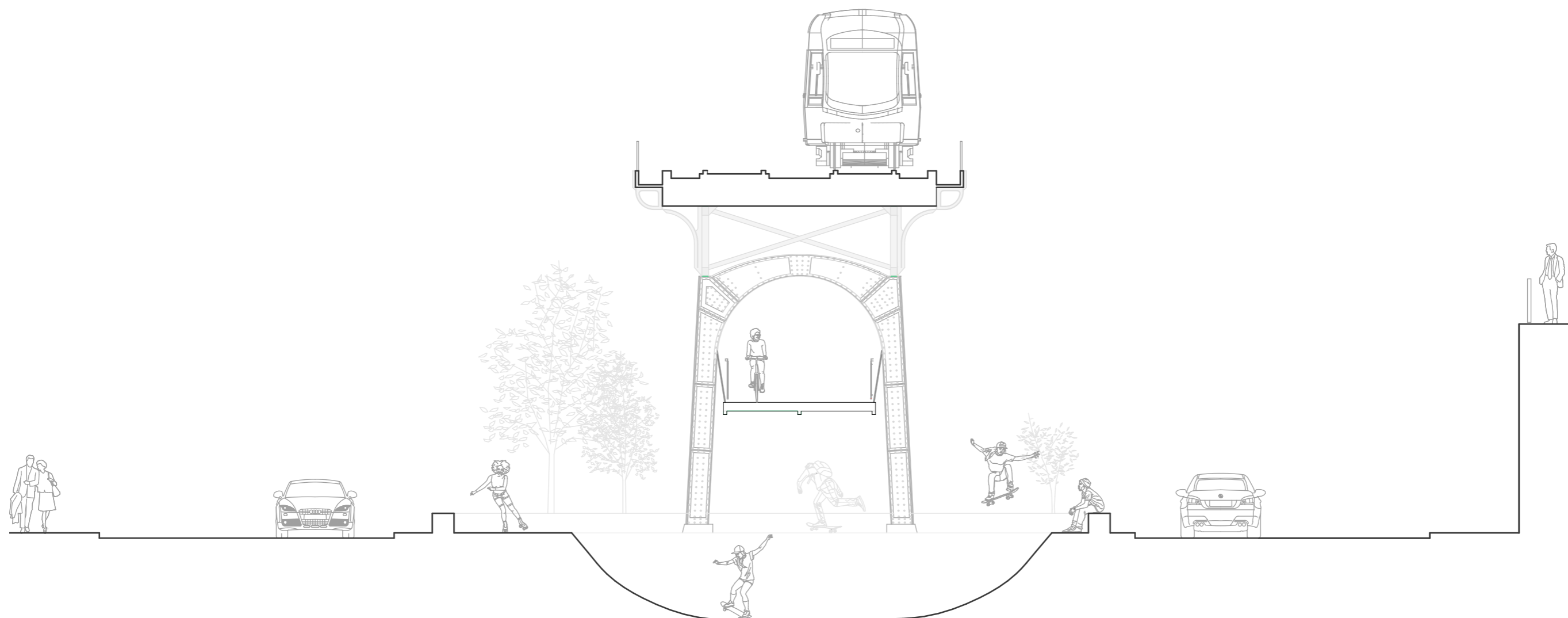

Wasserrückhaltebecken

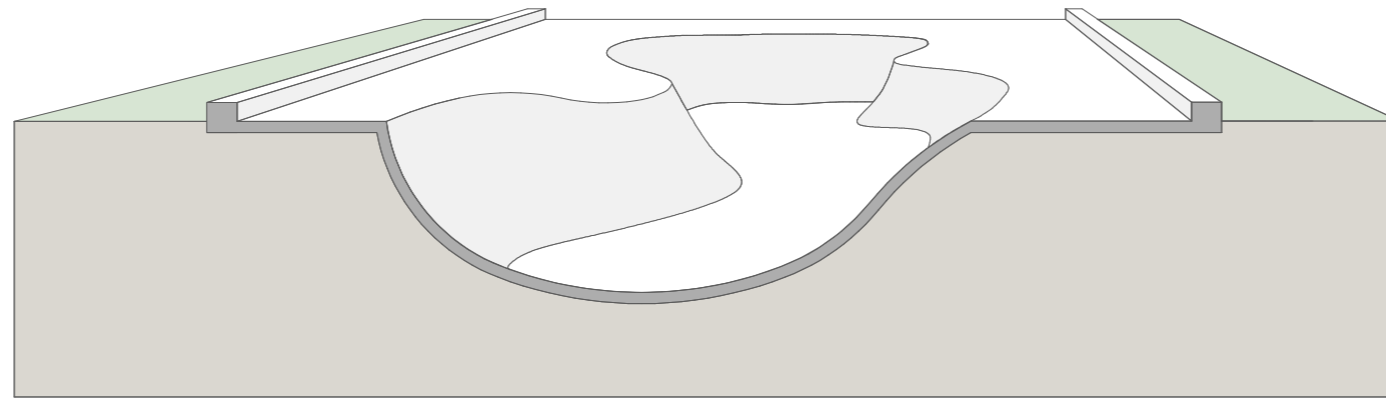

Nutzung 1: Skatepark

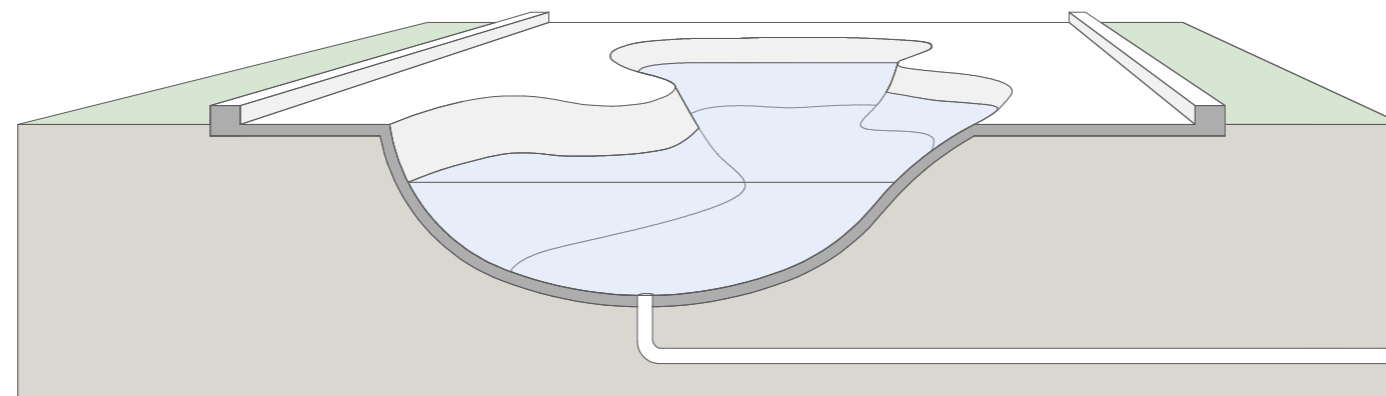

Nutzung 2: Skatepark als Pufferkapazität für Sturzfluten

Grundriss Spannbandbrücke

⌚ M1:500

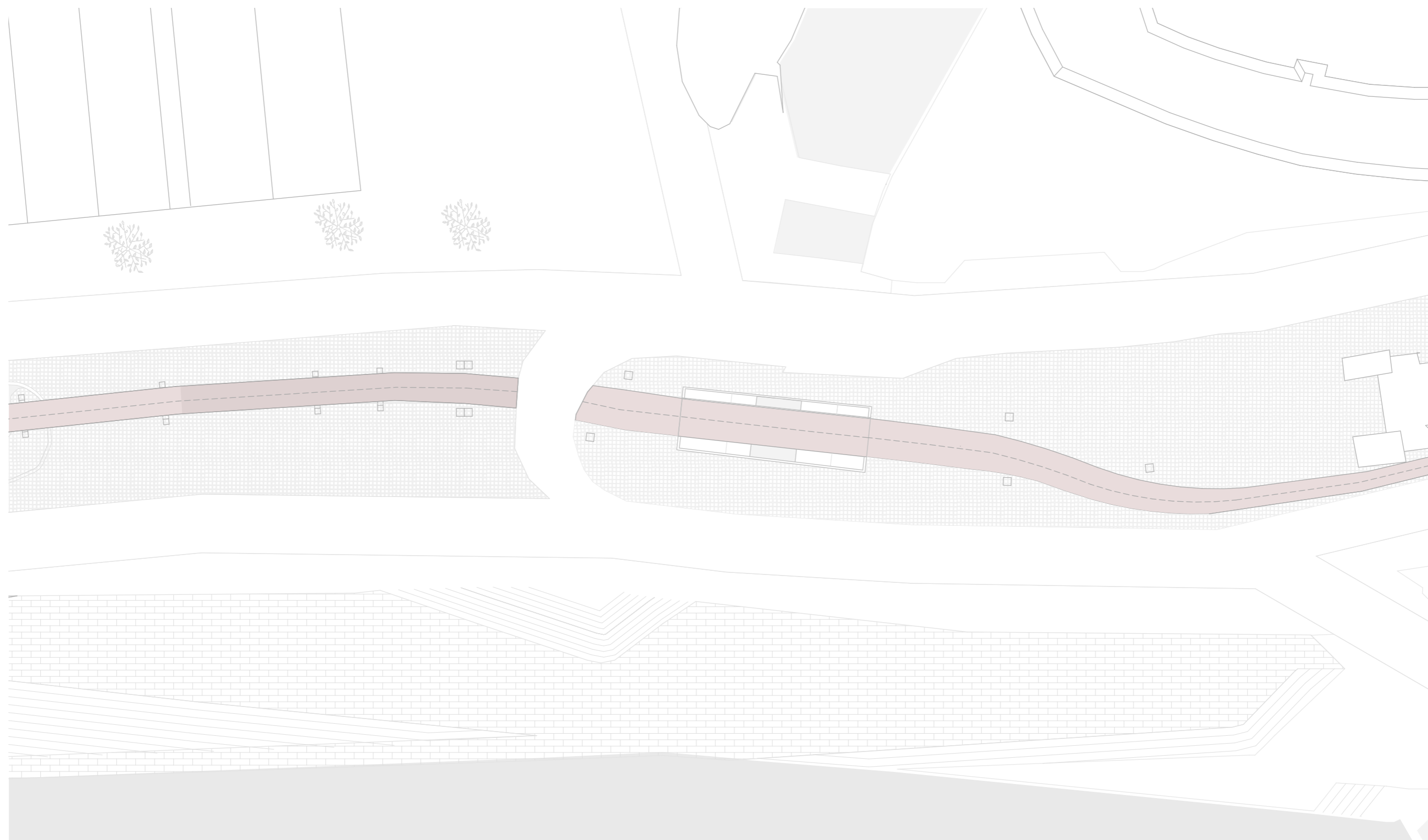

Spannbandbrücke

Detailschnitt M1:200

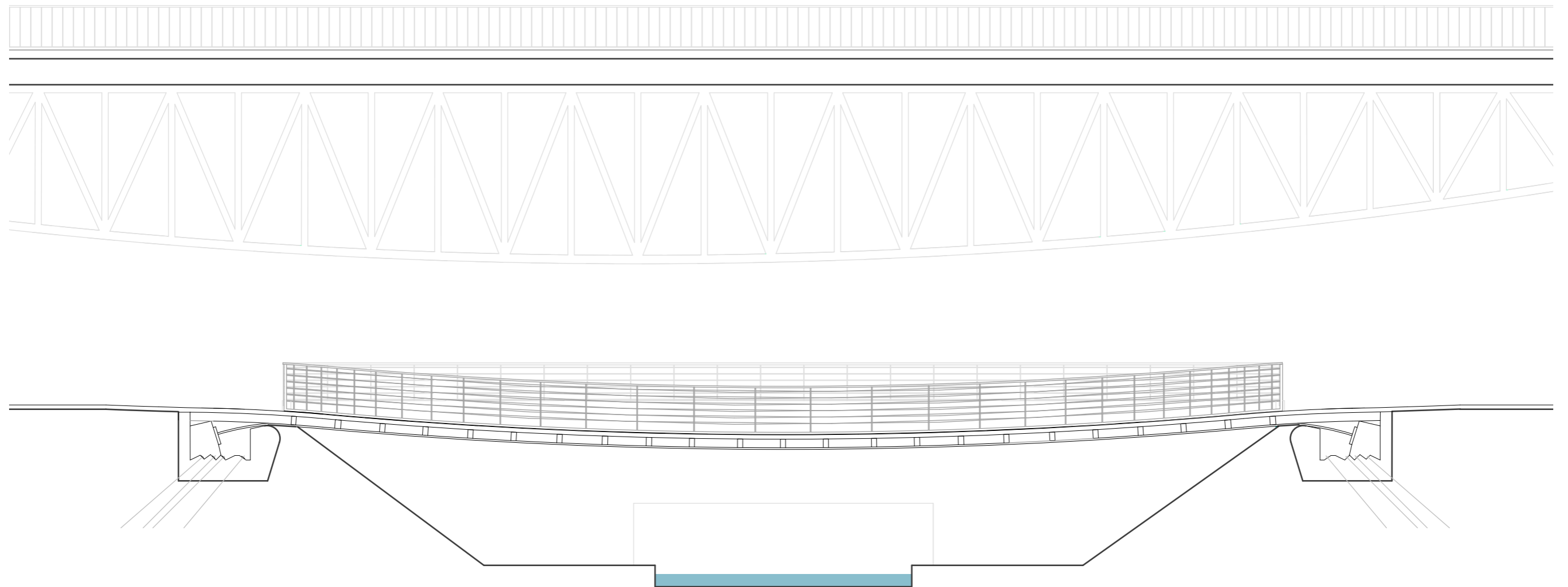

Spannbandbrücke

Schnittperspektive

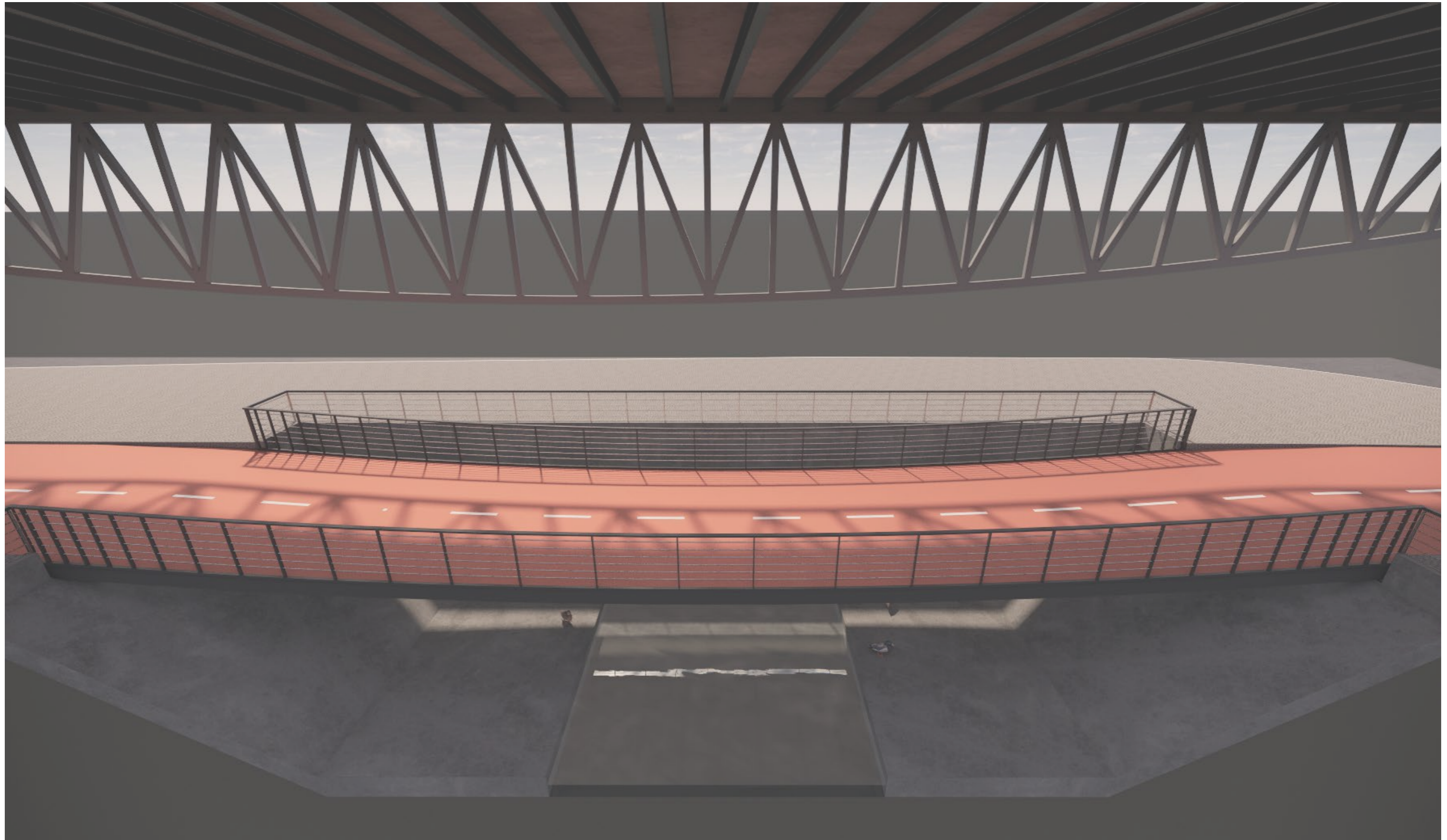

Spannbandbrücke

Perspektive



Schnitt Abschnitt III

M1:100

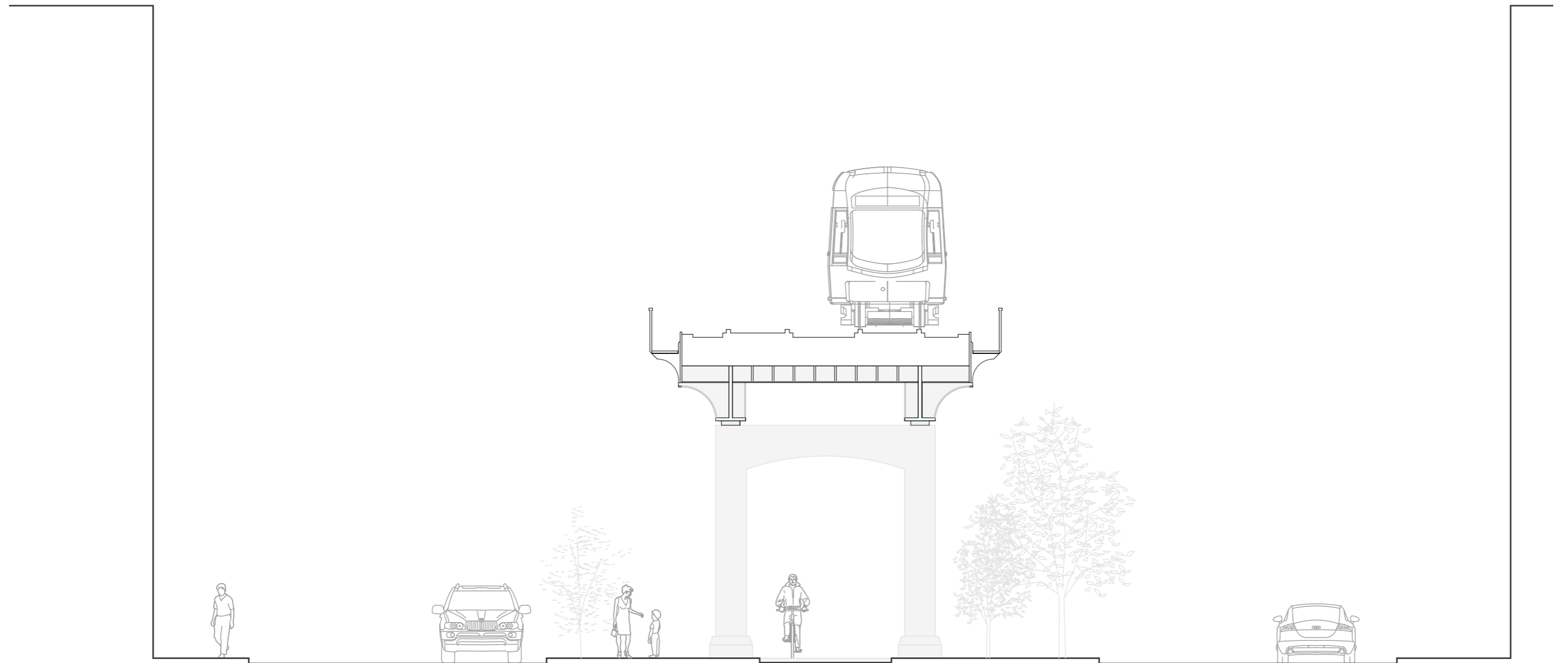

Kreuzung I - Phase 1

⊙ M1:200

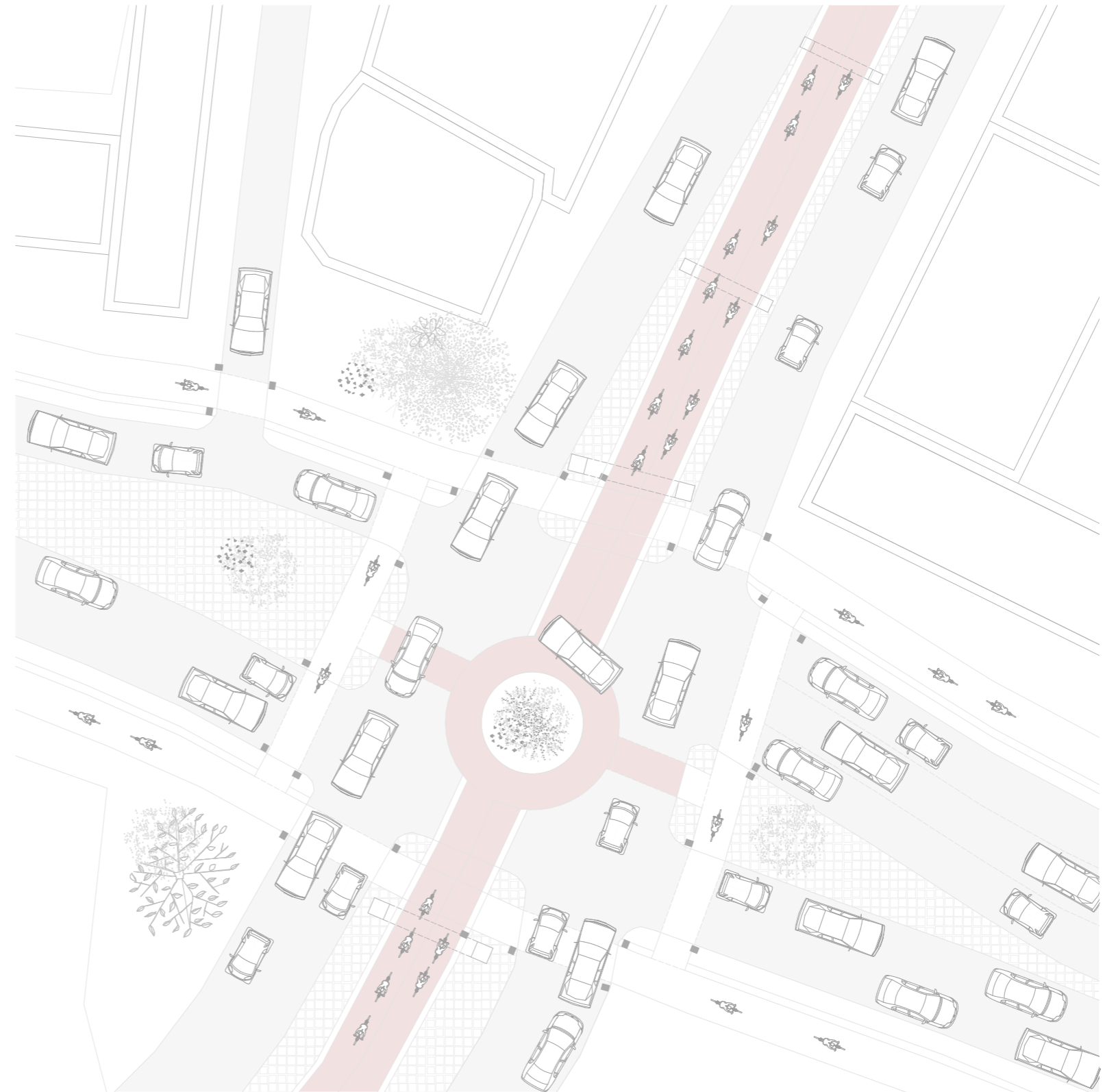

Kreuzung I - Phase 2

⊙ M1:200

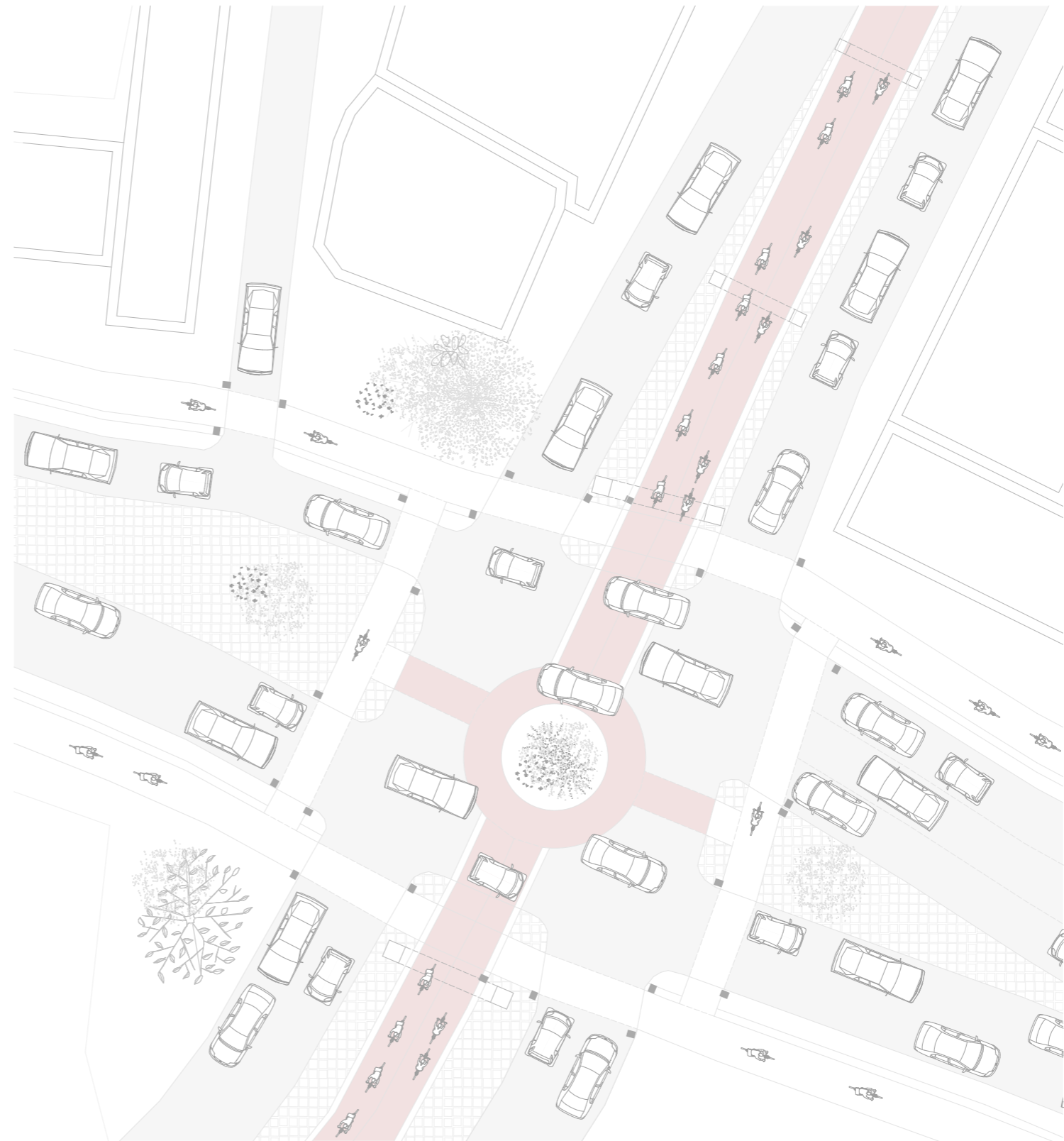

Kreuzung I - Phase 3

⊙ M1:200

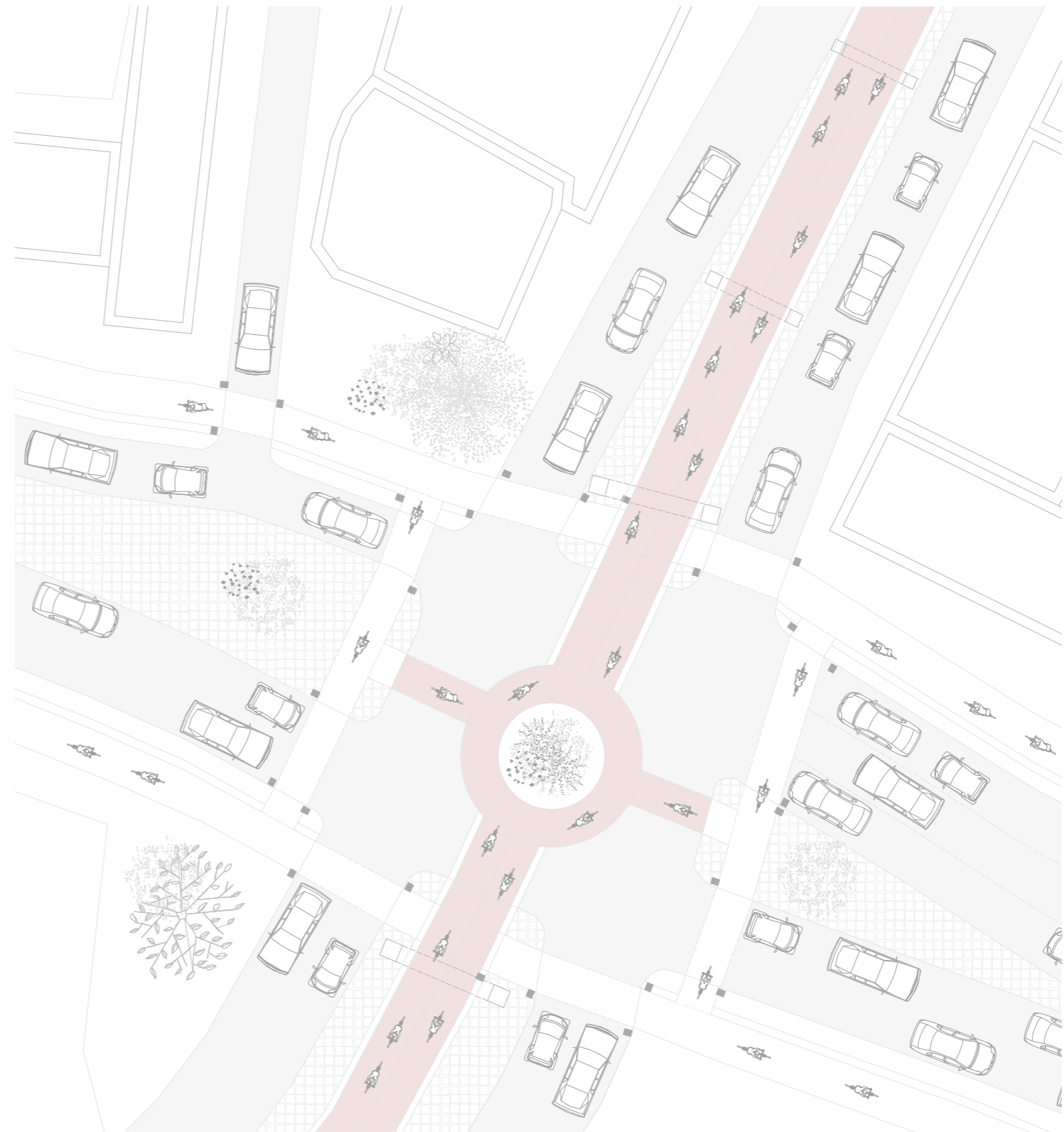
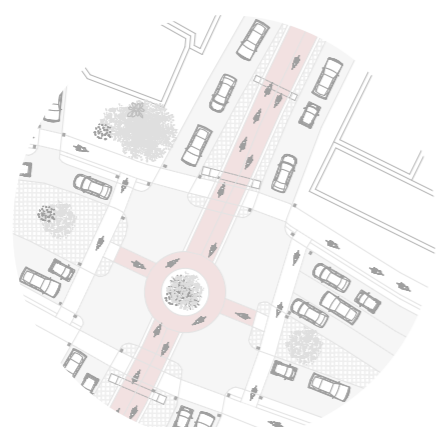

Kreuzung II

⊙ M1:200

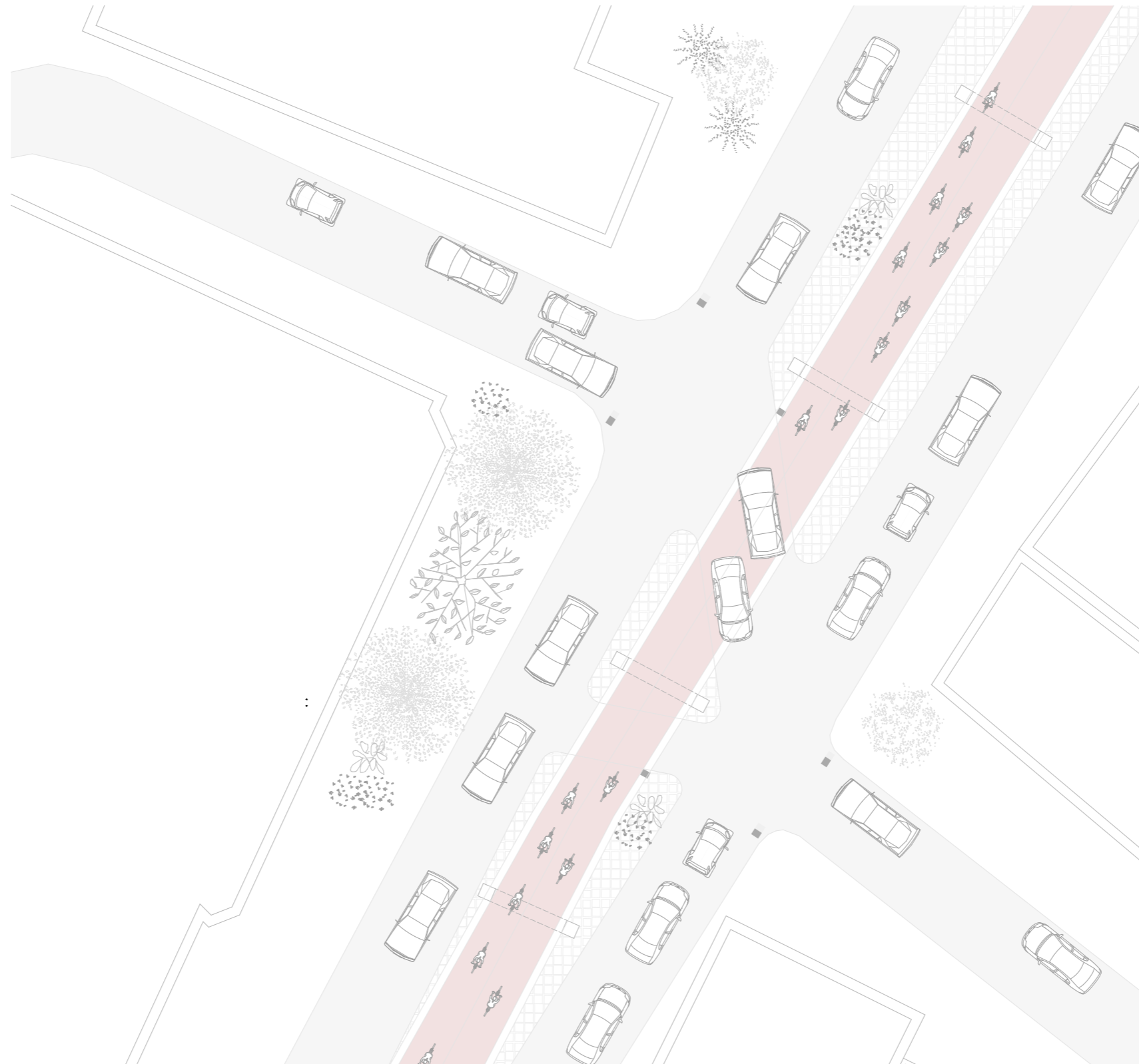

Kreuzung III

Anschluss an Veloroute Ⓞ M1:200



Energiekonzept

