

FLOWING SOUNDS

Fakultät Architektur und Urbanistik
BA Arch | 1. Kernmodul | Weg zur Architektur

Lehrstuhl Bauformenlehre
Prof. DI DD Bernd Rudolf

Lehrstuhl Darstellungsmethodik
Prof. DI Andreas Kästner

Gruppe D
Betreuer Martin Schmidt
Gast Martin Kohlstedt
Tutorin Theresa Unverricht

Entwürfe Stella Barthelmeus, Amelie Brauer, Charlotte Chrzanowski, Pauline Ehrhardt, Ulrike Fiebig, Laura Golling, Paul Henri Hamacher, Daniel Hiebsch, Sophia Humborg, Ida Paula Janzen, Raphael Kopelke, Cormac Mac Reevy, Elena Mertens, Franka Müller, Emily Neuy, Nico Pöhlmann, Jan Luca Reinkober, Thurid Rosebrock, Dorothea Schiesser, Greta Steinbach, Josephine Tomnitz, Malin Wandel, Carla Filippa Wink, Amelie Zillmann



Malin Wandel

Amelie Zillmann

Carla Filippa Wink

Ulrike Fiebig

Jan Luca Reinkober

D FLOWING SOUNDS

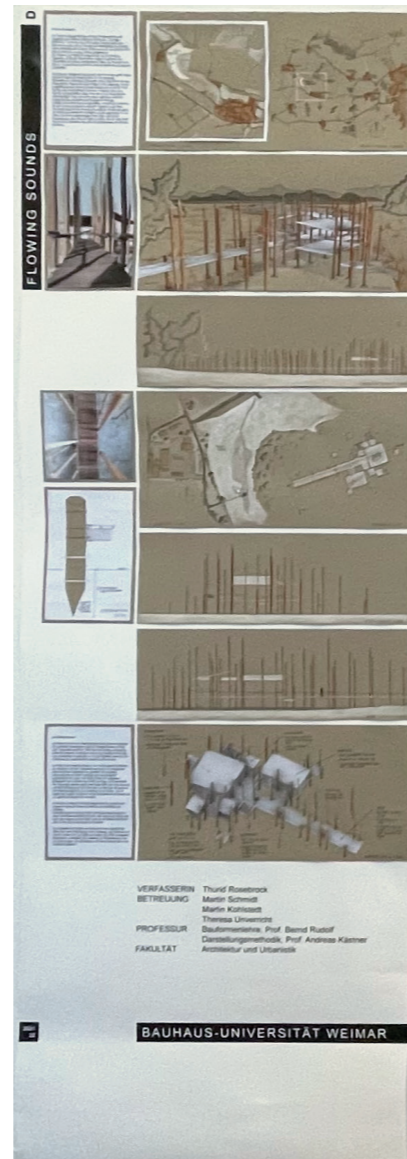

Thuid Rosebrock

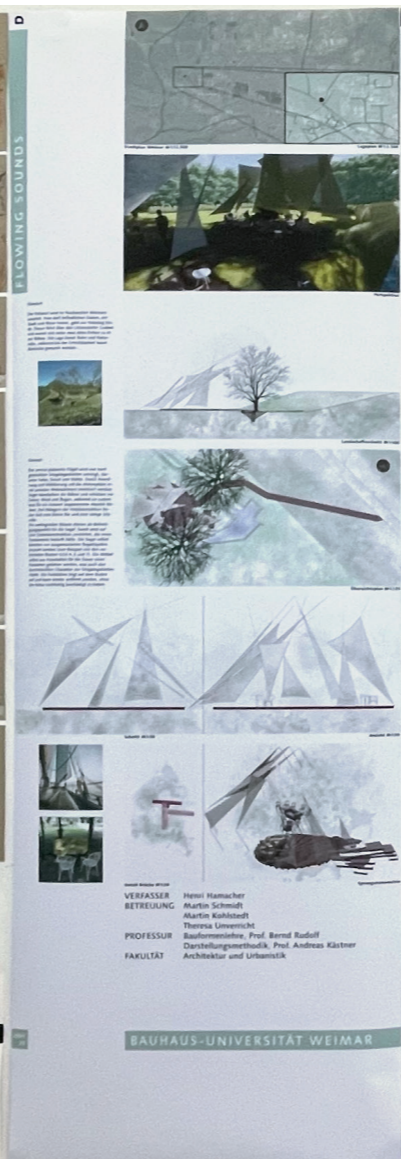

Paul Henri Hamacher



Laura Golling



Cormac Mac Reevy

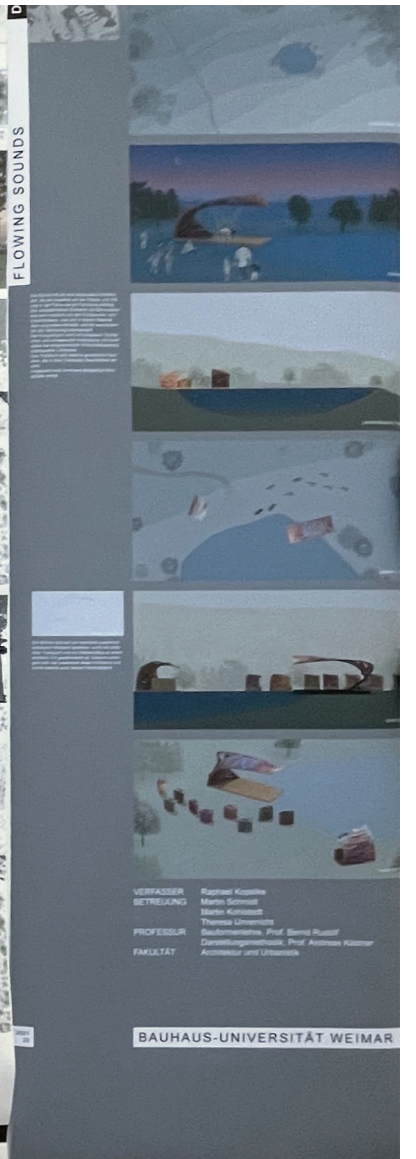

Raphael Kopelke

D FLOWING SOUNDS

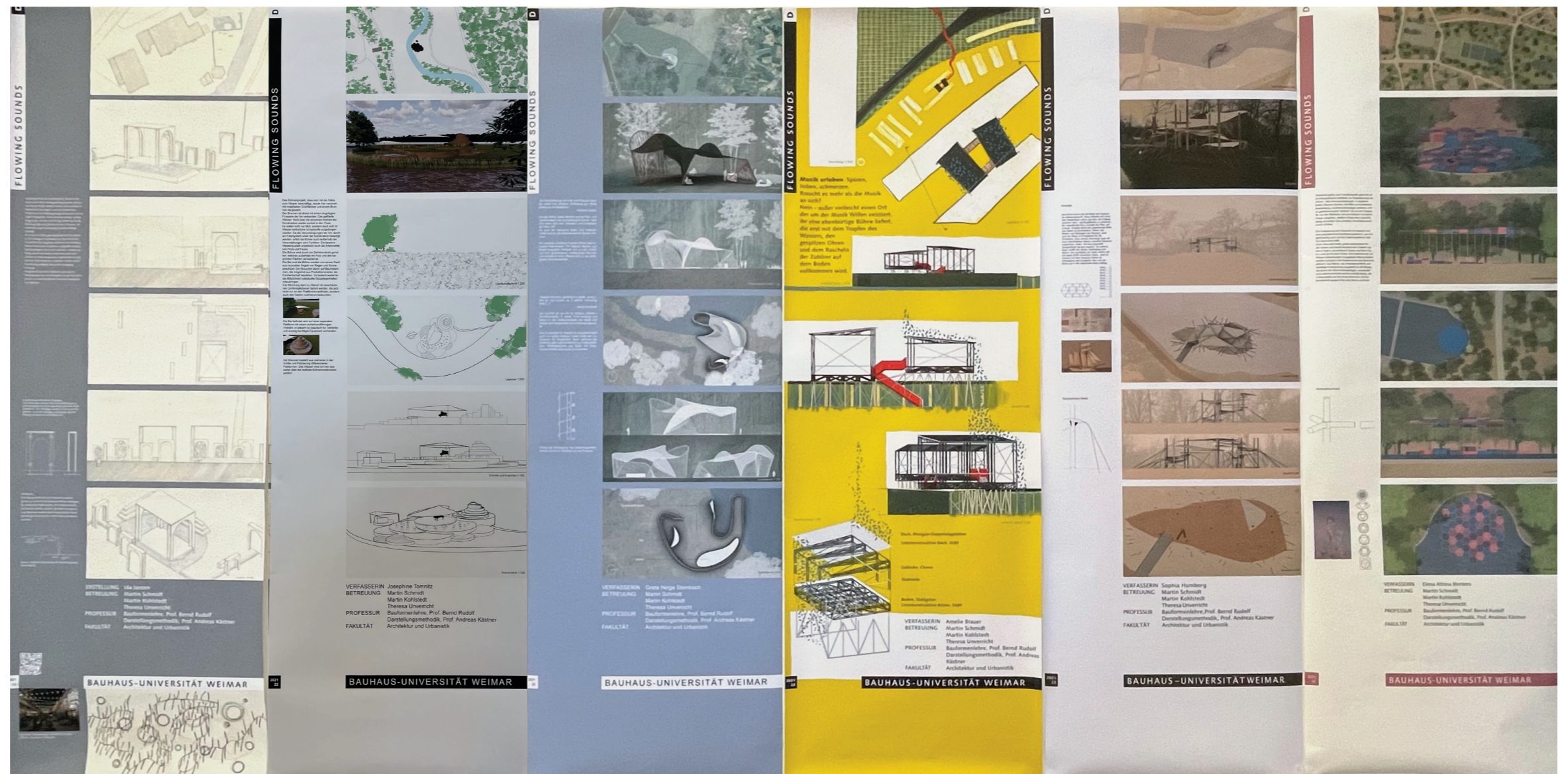

Ida Paula Janzen

Josephine Tomnitz

Greta Steinbach

Amelie Brauer

Sophia Humborg

Elena Mertens

D FLOWING SOUNDS



Nico Pöhlmann

Emily Neuy

Charlotte Chrzanowski

Daniel Hiebsch

Dorothea Schiesser

Franka Müller

Stella Barthelmeus

D FLOWING SOUNDS

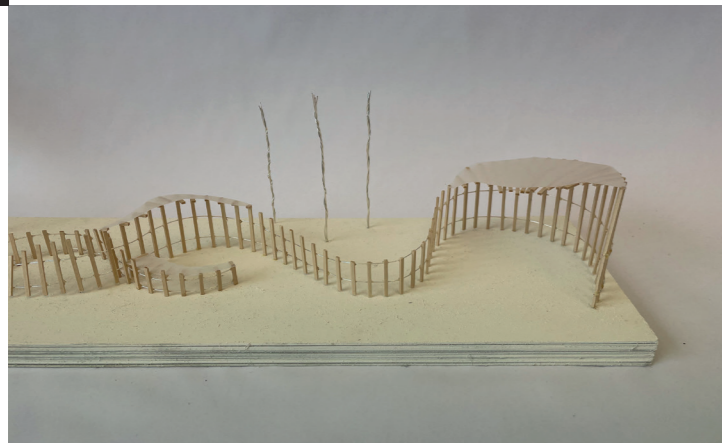

Malin Wandel

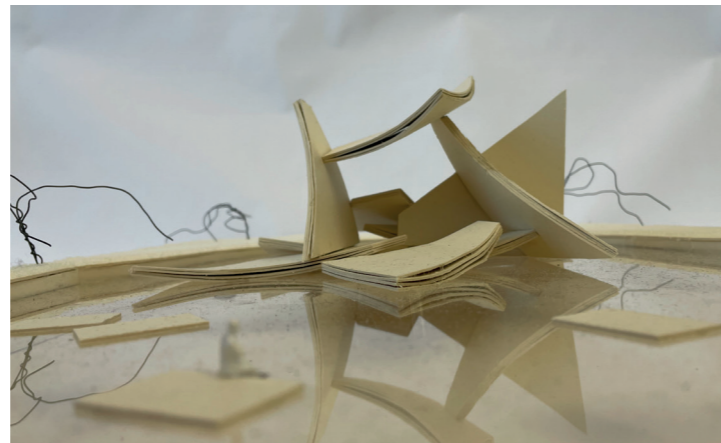

Amelie Zillmann

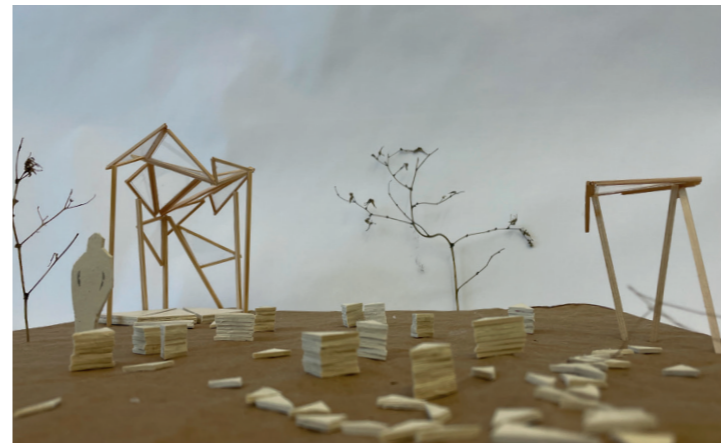

Carla Filippa Wink



Jan Luca Reinkober



Thurid Rosebrock



Paul Henri Hamacher



Laura Golling

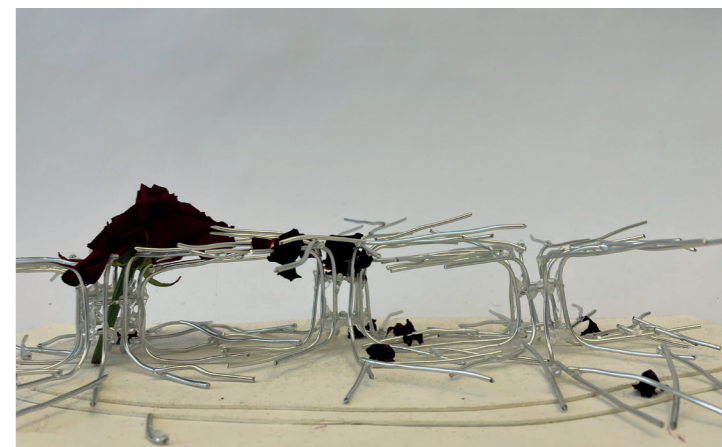

Cormac Mac Reevy

D FLOWING SOUNDS



Raphael Kopelke

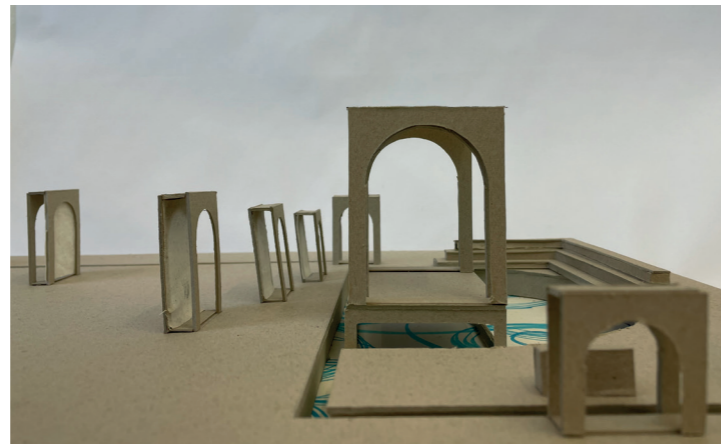

Ida Paula Janzen

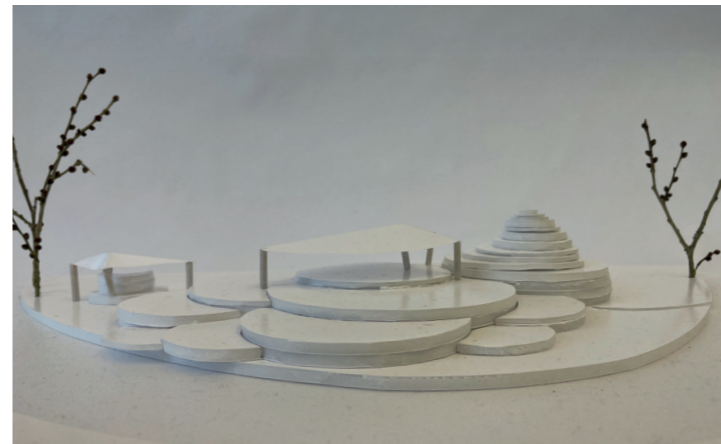

Josephine Tomnitz

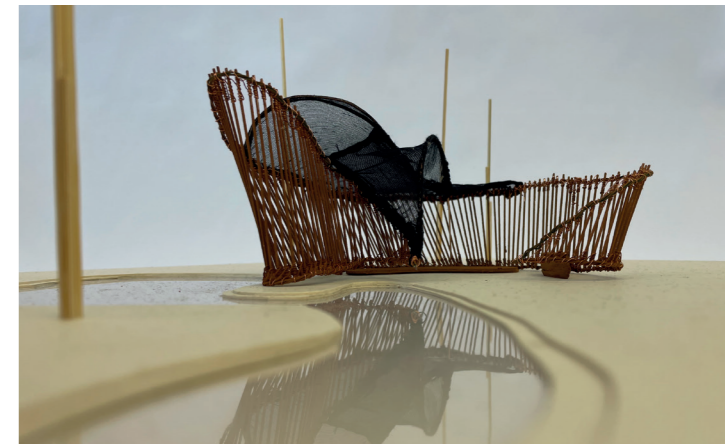

Greta Steinbach

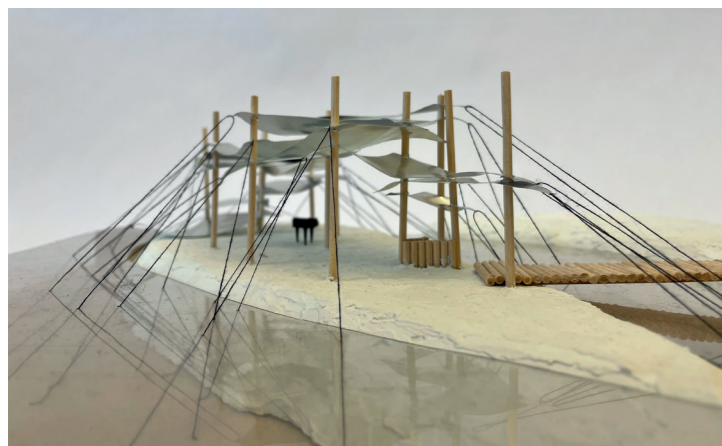

Sophia Humborg



Elena Mertens

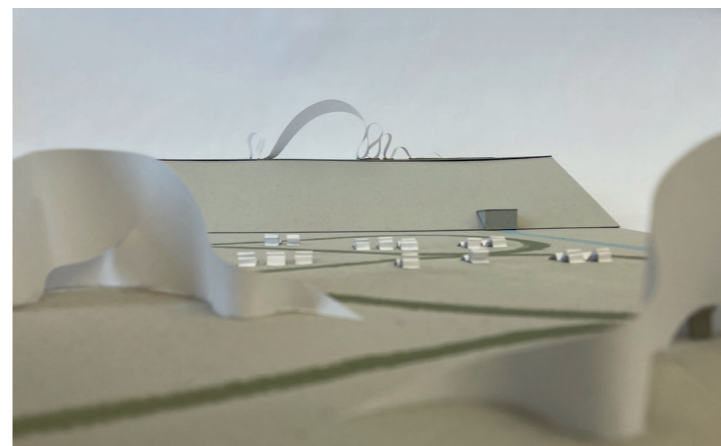

Nico Pöhlmann



Emily Neuy

D FLOWING SOUNDS



Charlotte Chrzanowski

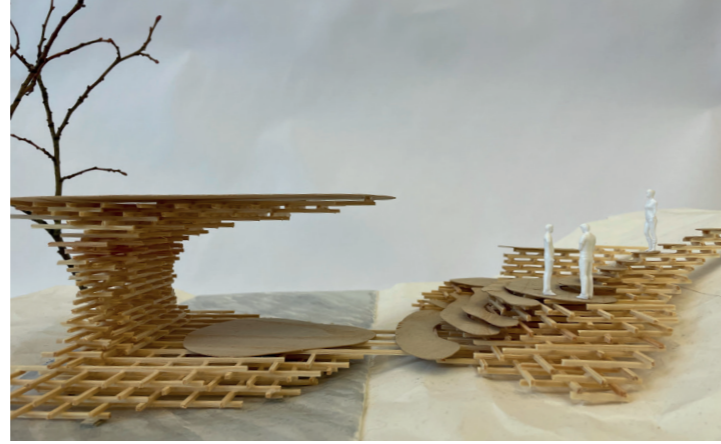

Daniel Hiebsch



Dorothea Schiesser



Franka Müller



Stella Barthelmeus