

Planted PersonaaS

This Project will help you to NOT ONLY pay more attention of your plants, BUT ALSO enjoying more about planting!



Planted Personas

Planted Pesonas?

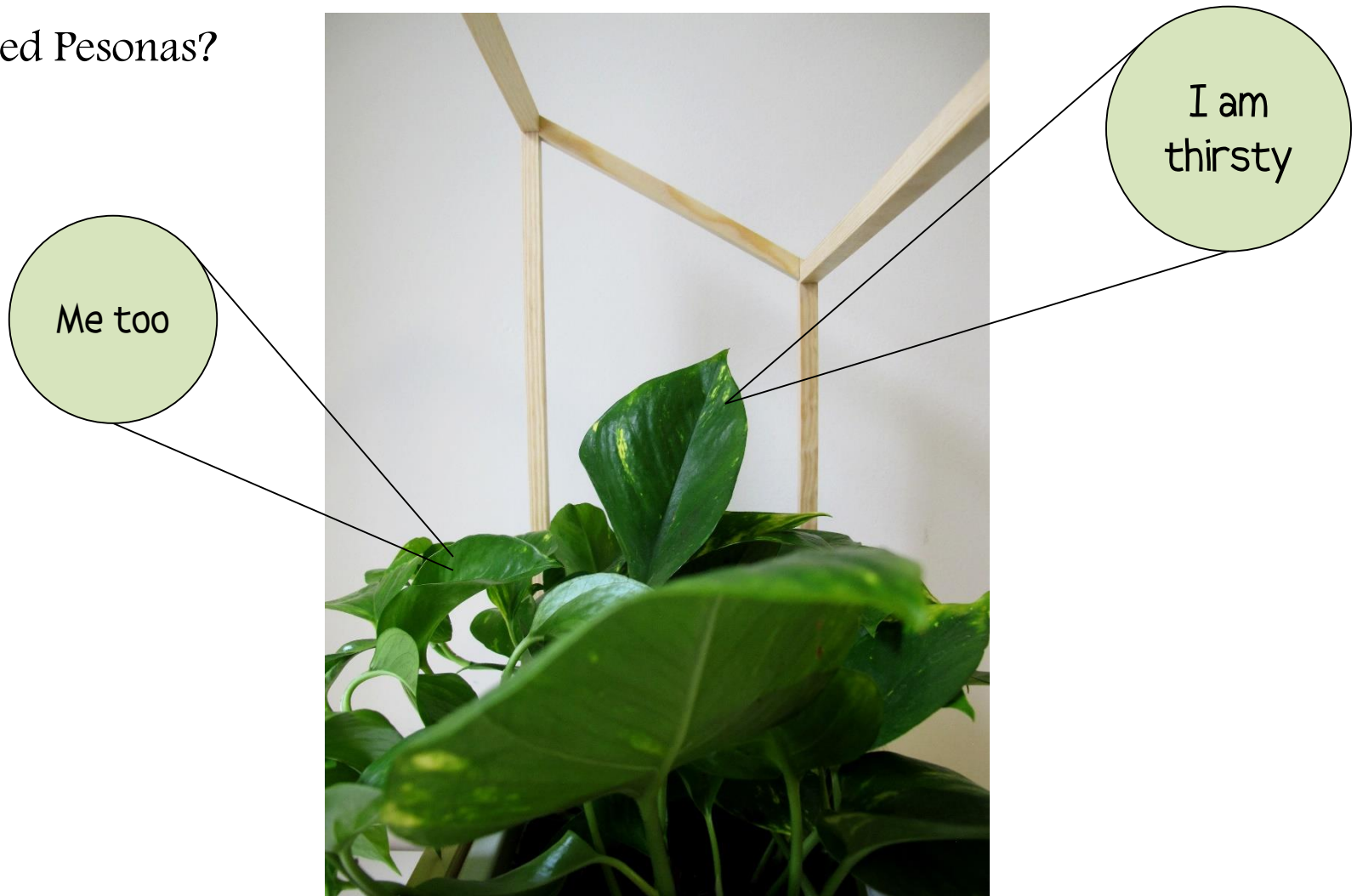

Planted Personas



Planted Personas



Planted PersonaaS



BUT, HOW?



Planted PersonaaS

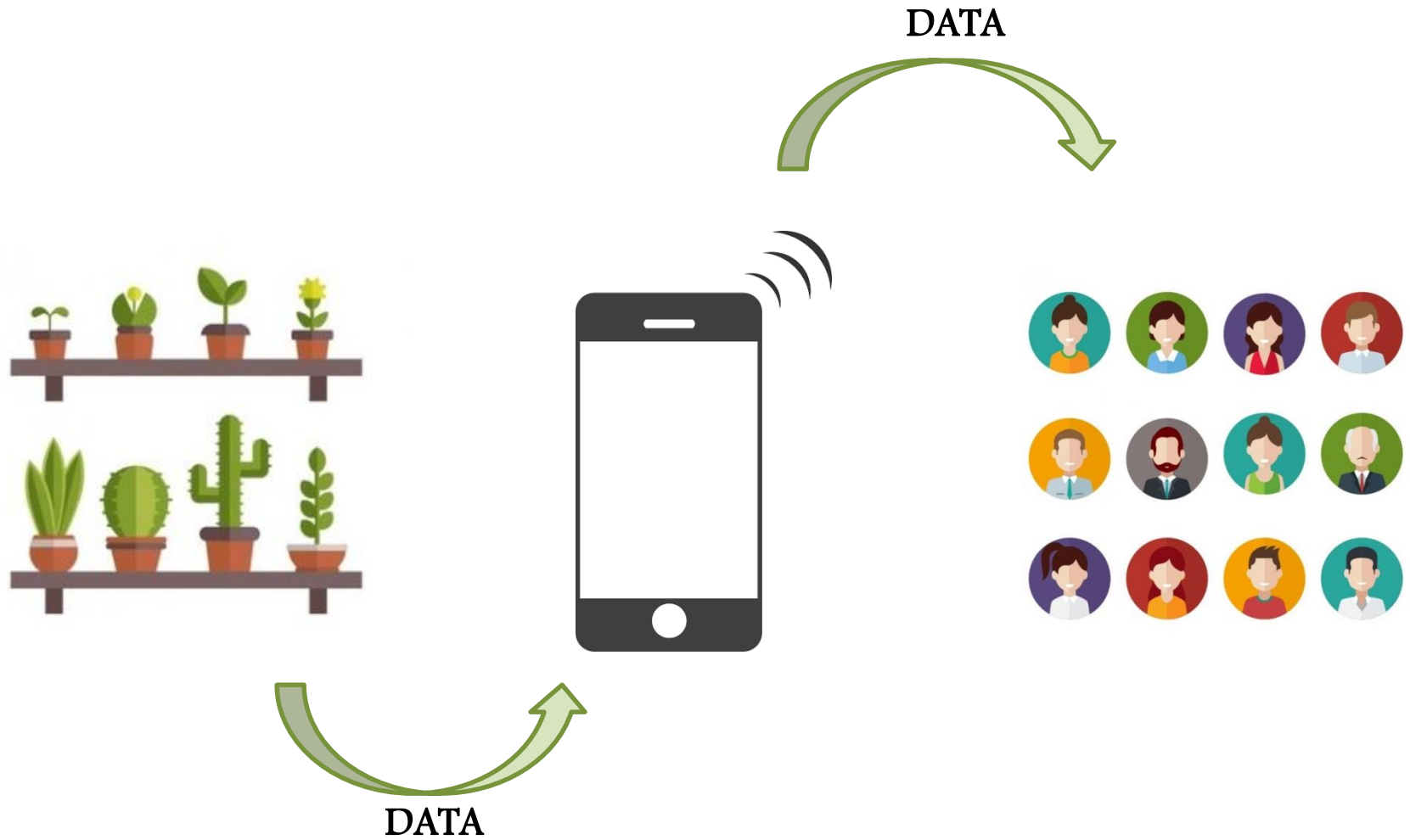

Planted Personas

Modular Design



Planted PersonaaS

Modular Design

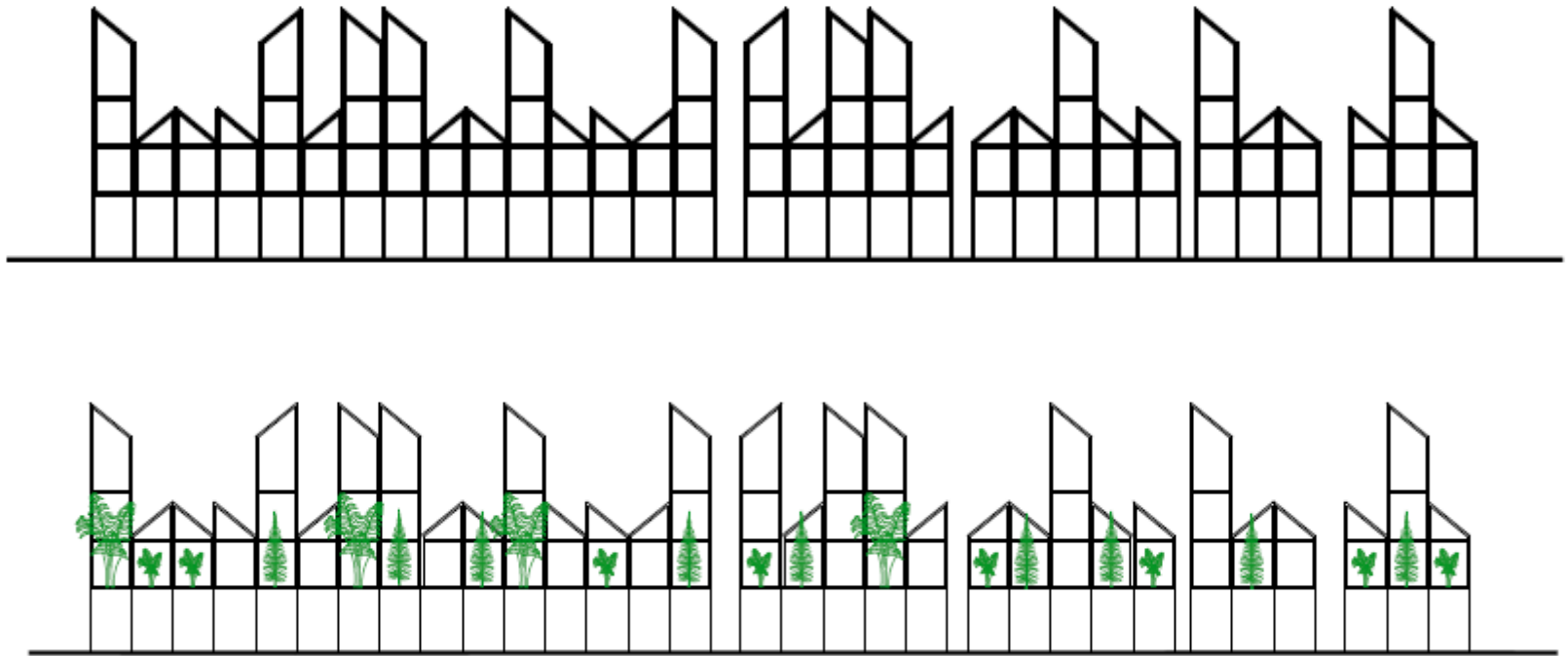

Planted Personas

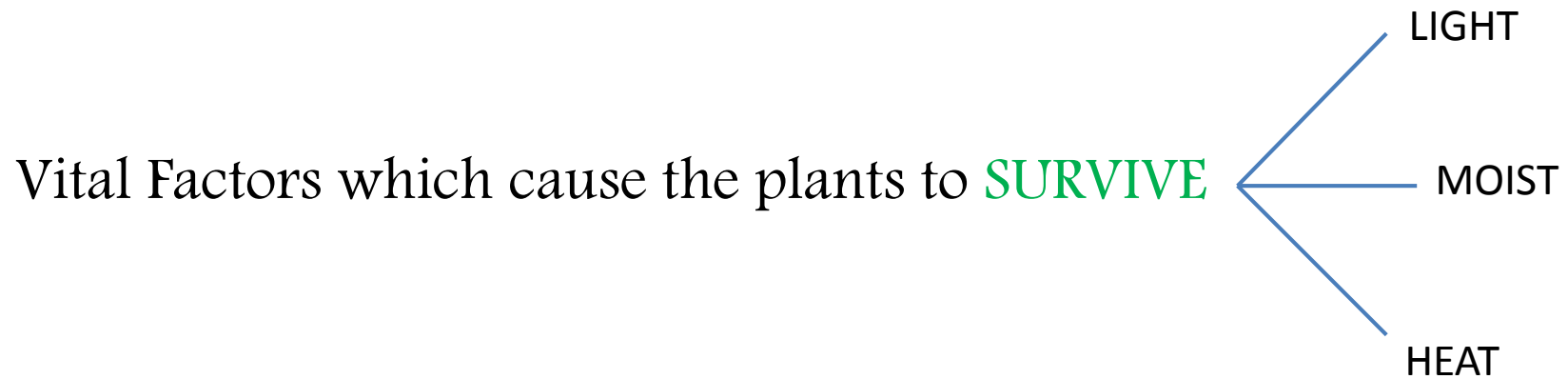

Planted PersonaS

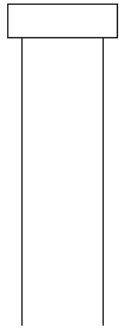

Photoresistor

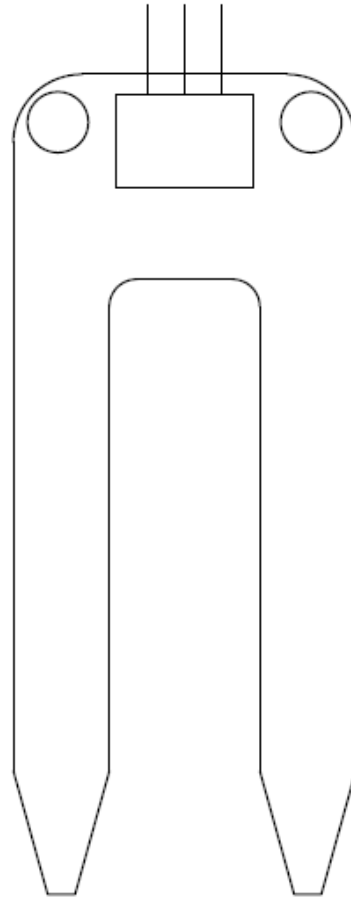

Moisture Sensor

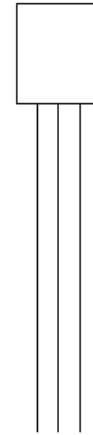

Thermistor

Planted PersonaaS

- 1 The Plant feel unsatisfied with its situation (lack of water, improper heat which is based on the light whether it is day or night).

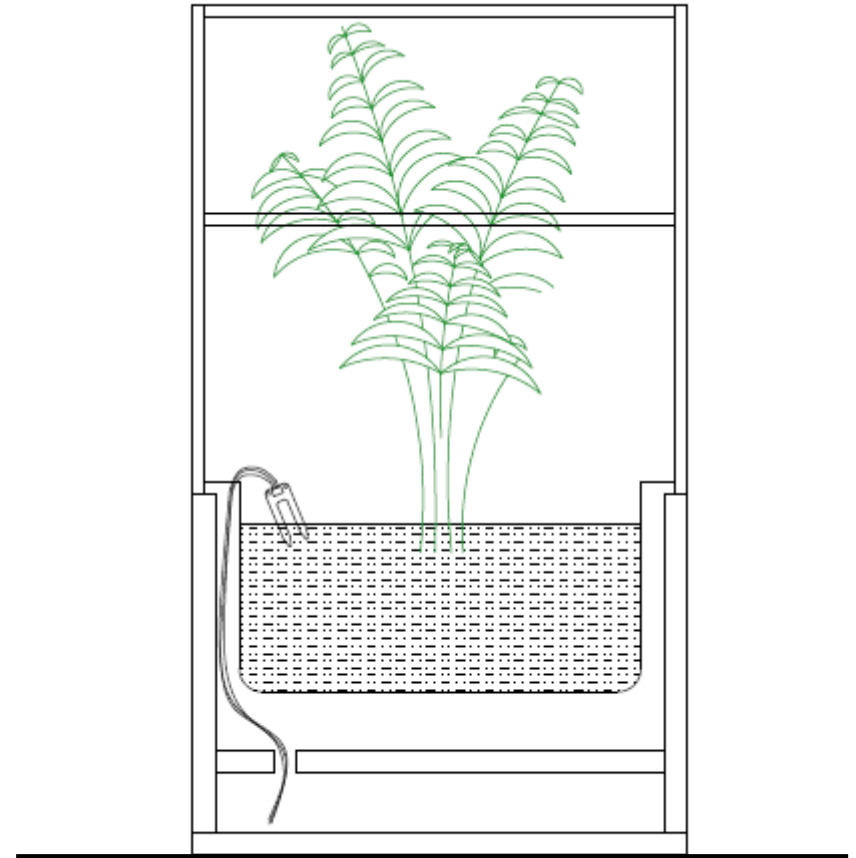

Planted Person a S

- 1 The Plant feel unsatisfied with its situation (lack of water, improper heat which is based on the light whether it is day or night).
- 2 Moisture sensor, Thermistor and Photo Resistor notice it and send this information to the Arduino which is in the tray .

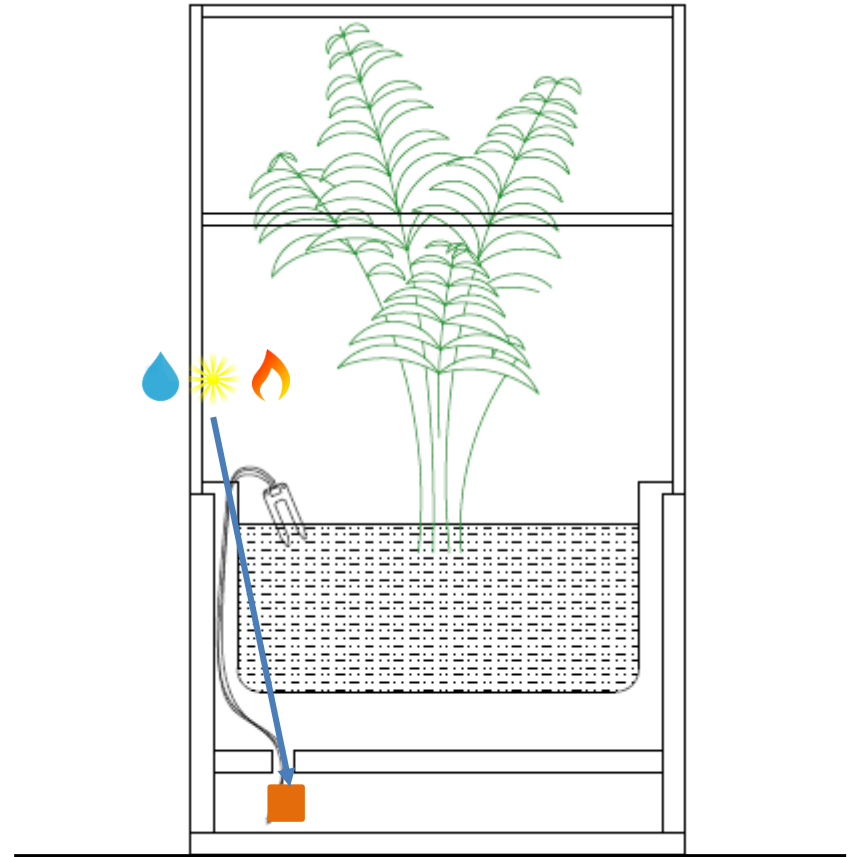

Planted Person aS

- 1 The Plant feel unsatisfied with its situation (lack of water, improper heat which is based on the light whether it is day or night).
- 2 Moisture sensor, Thermistor, Photo Resistor notices it and sends this information to the Arduino which is in the tray . 
- 3 The Arduino sends this Data to the two LEDs with colors of blue and light respectively for moisture sensor and light sensor which are on the façade of the green house. So they will light up as a signal.

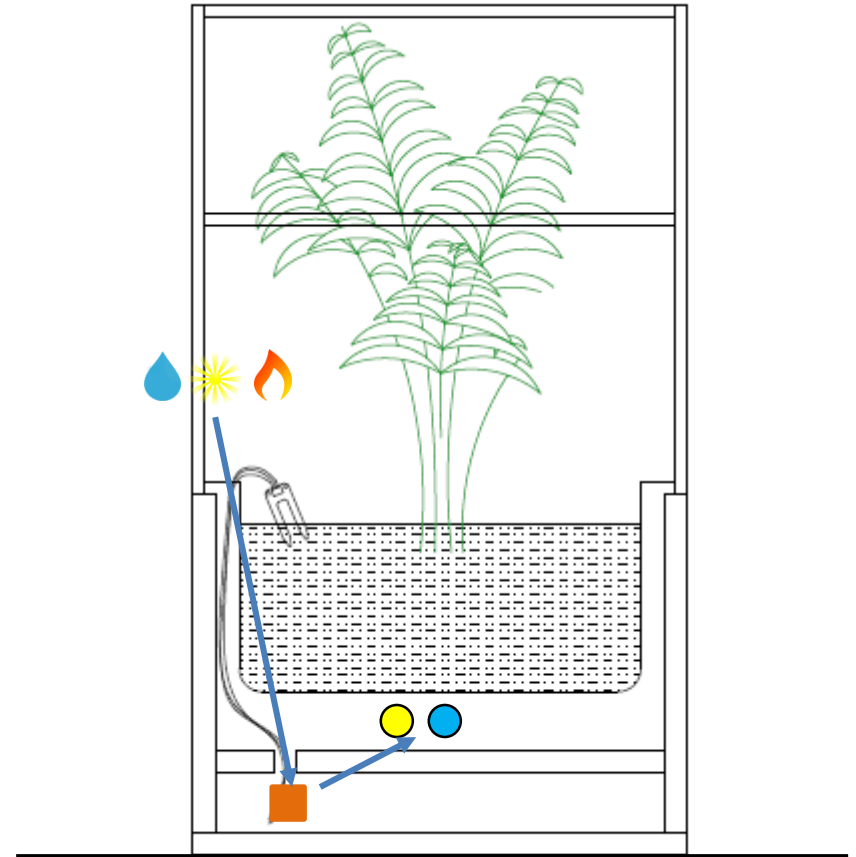

Planted PersonaaS

But, what if you are not home and can not see the signals?
Then, your plant will send you SMS.

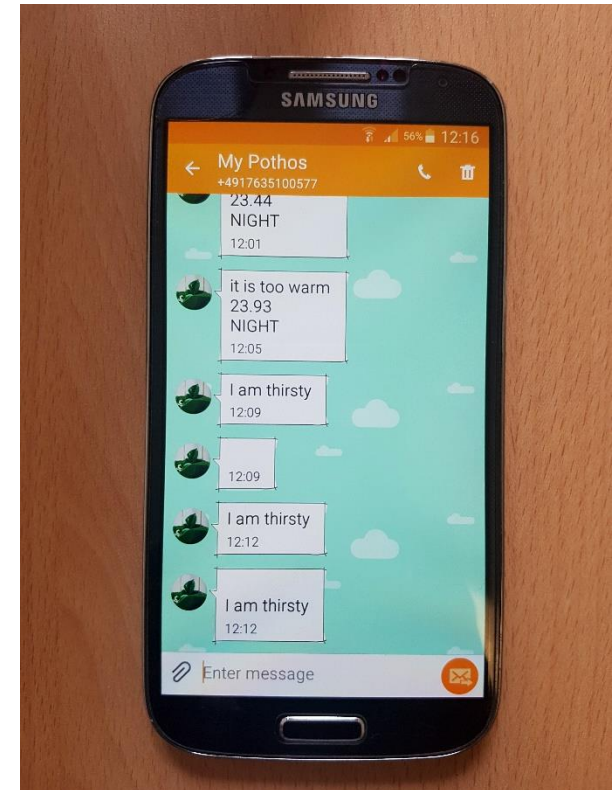

Planted Person aS

- 4 The Arduino sends the Data to the Bluetooth Module which is in the tray.

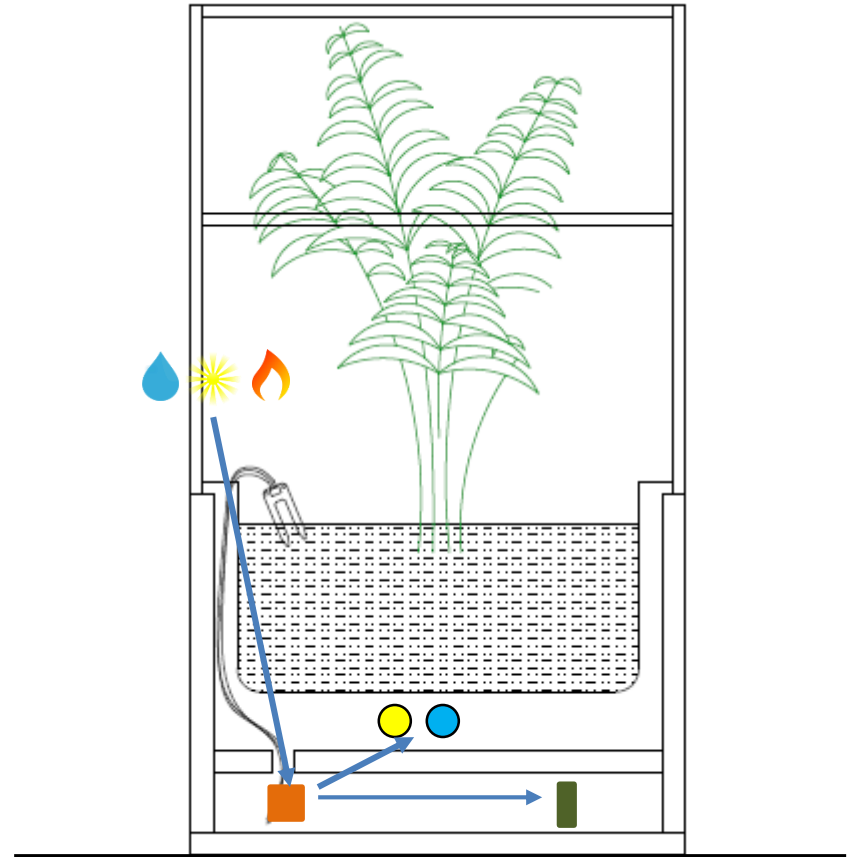

Planted PersonaS

- 4 The Arduino sends the Data to the Bluetooth Module which is in the tray.



- 5 Bluetooth Module sends the Data to the Bluetooth module which is on the central frame.

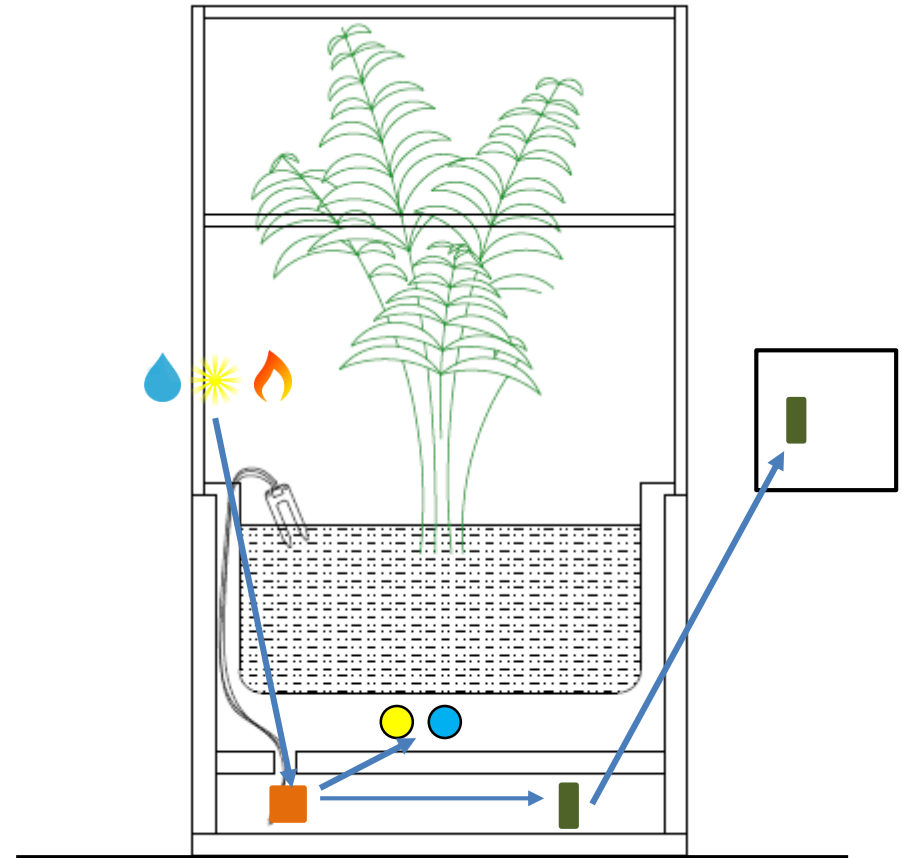

Planted Person a S

4 The Arduino sends the Data to the Bluetooth Module which is in the tray.



5 Bluetooth Module sends the Data to the Bluetooth module which is on the central frame.



6 Bluetooth Module sends the Data to GSM shield on the central frame.

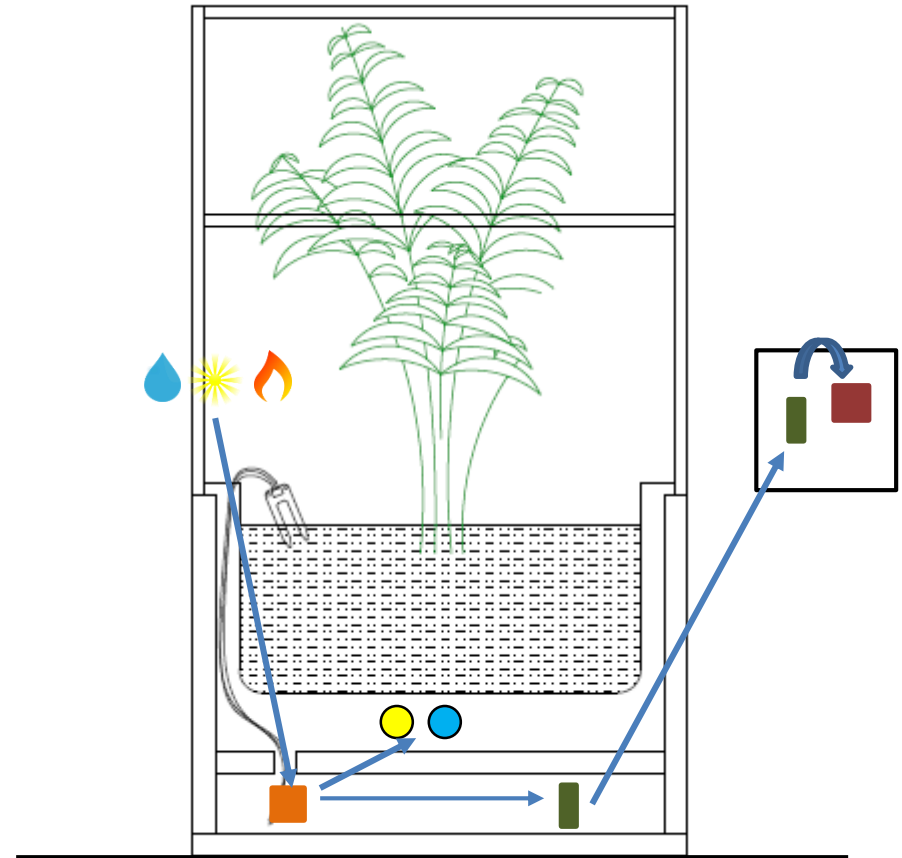

Planted Person aS

- 4 The Arduino sends the Data to the Bluetooth Module which is in the tray.



- 5 Bluetooth Module sends the Data to the Bluetooth module which is on the central frame.



- 6 Bluetooth Module sends the Data to GSM shield on the central frame.



- 7 GSM shield sends SMS to your Phone.

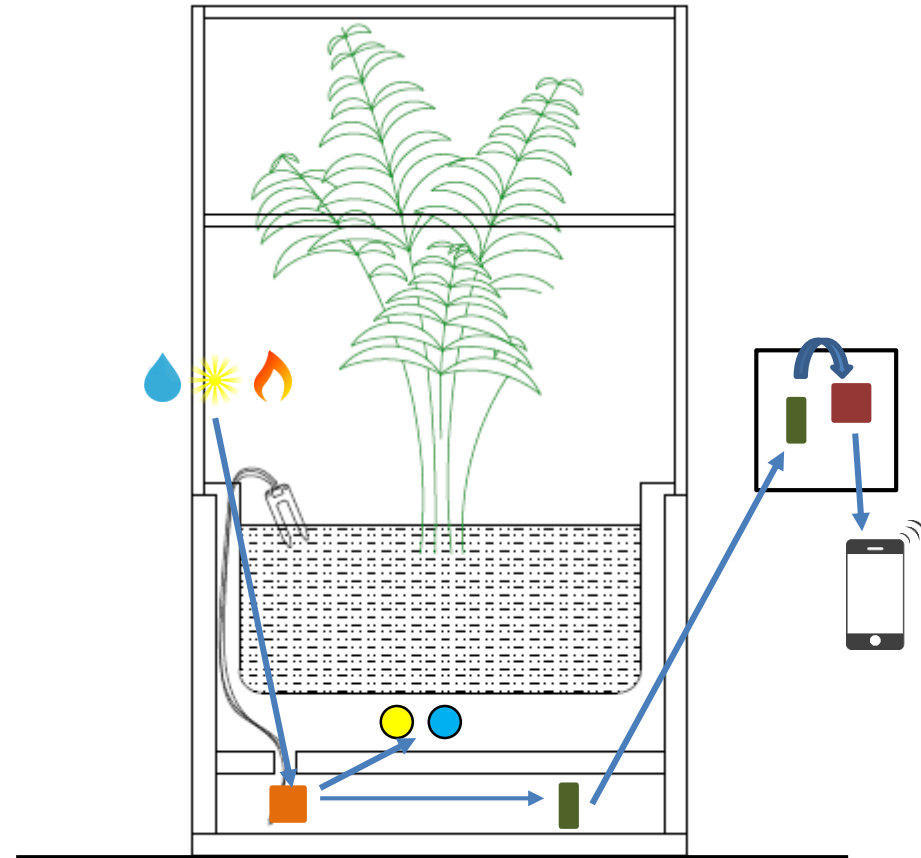

Planted PersonaaS

8 Now, you are aware of your plant's requirements.

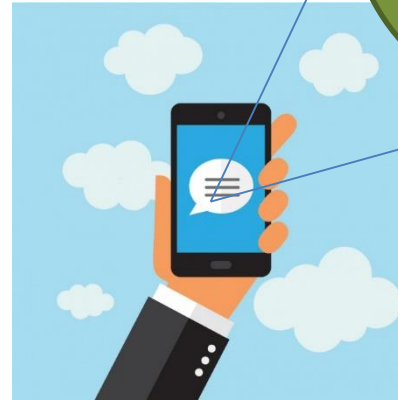

Planted PersonaaS

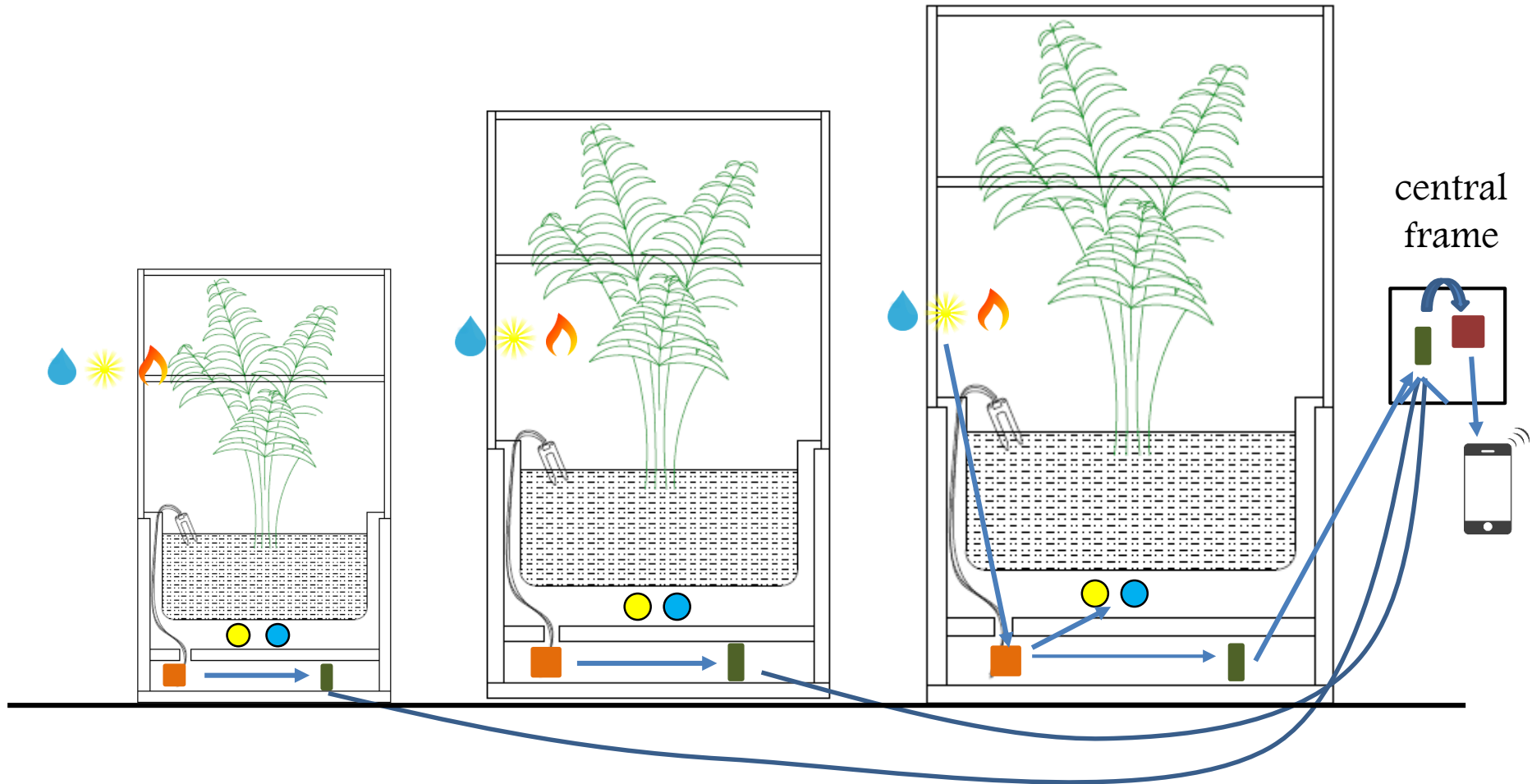

Planted PersonaaS

Technology

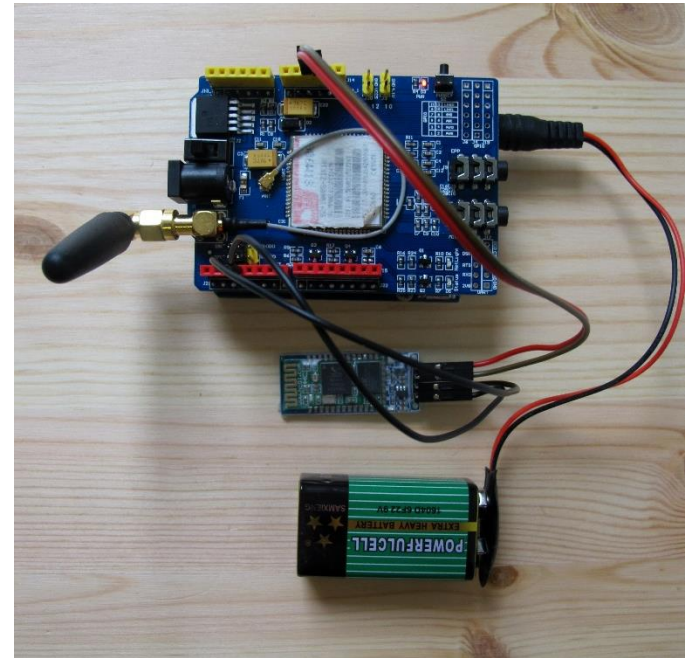
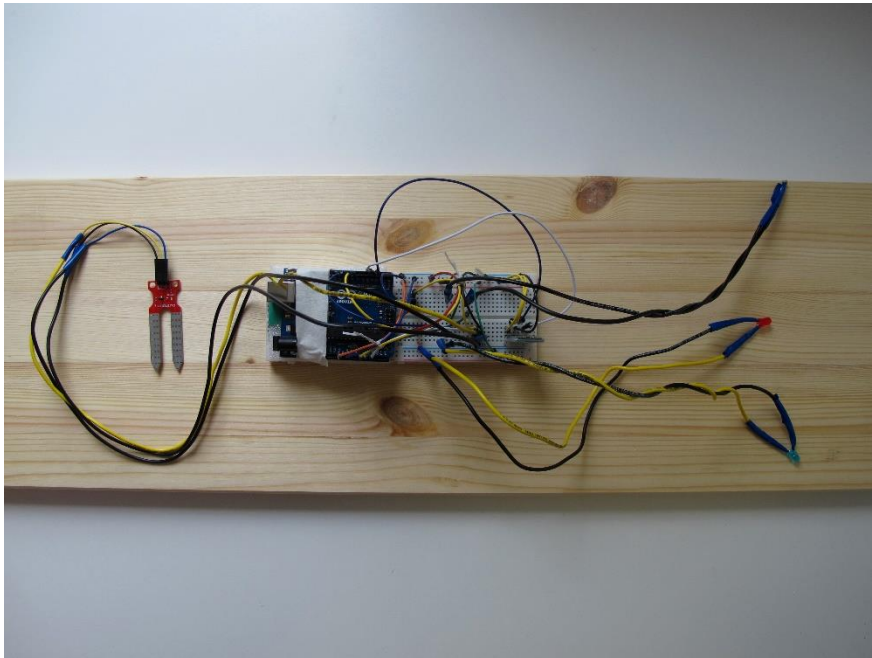

Planted PersonaaS

Technology

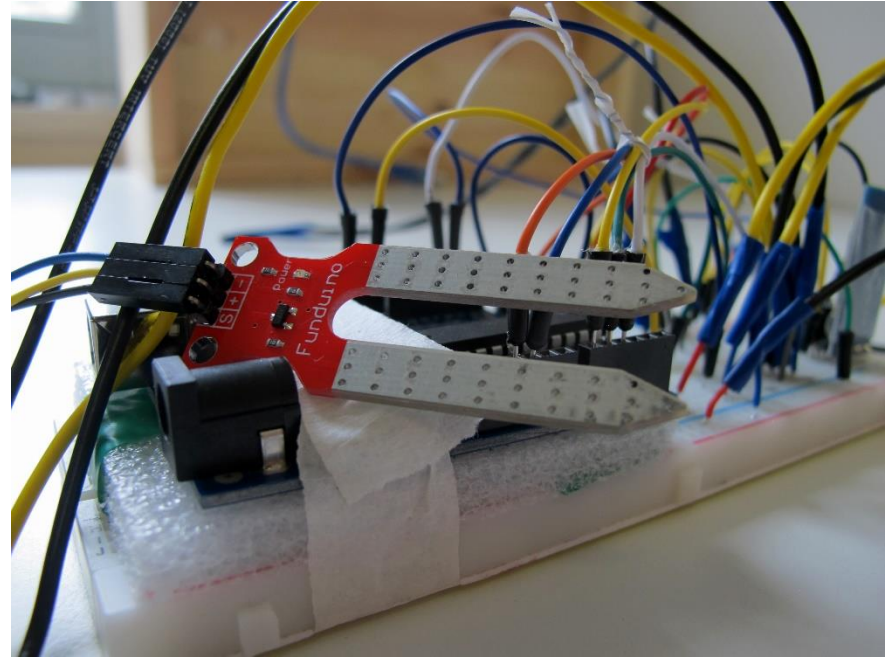
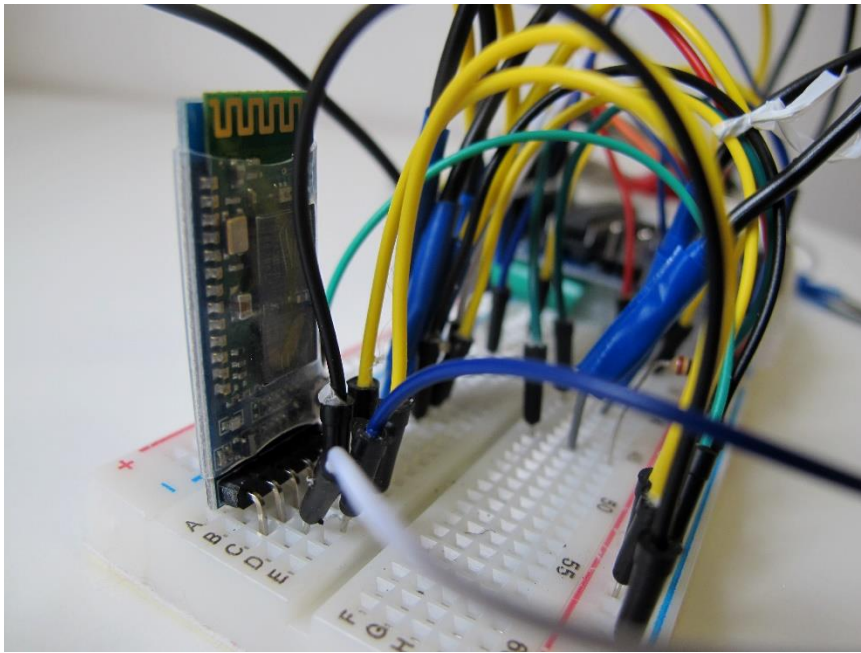

Planted PersonaaS

Technology

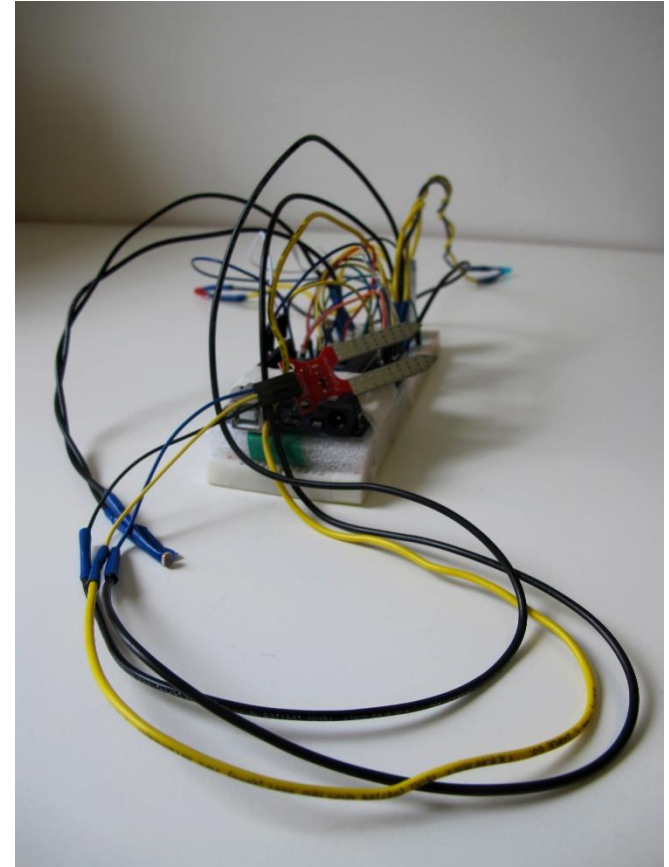
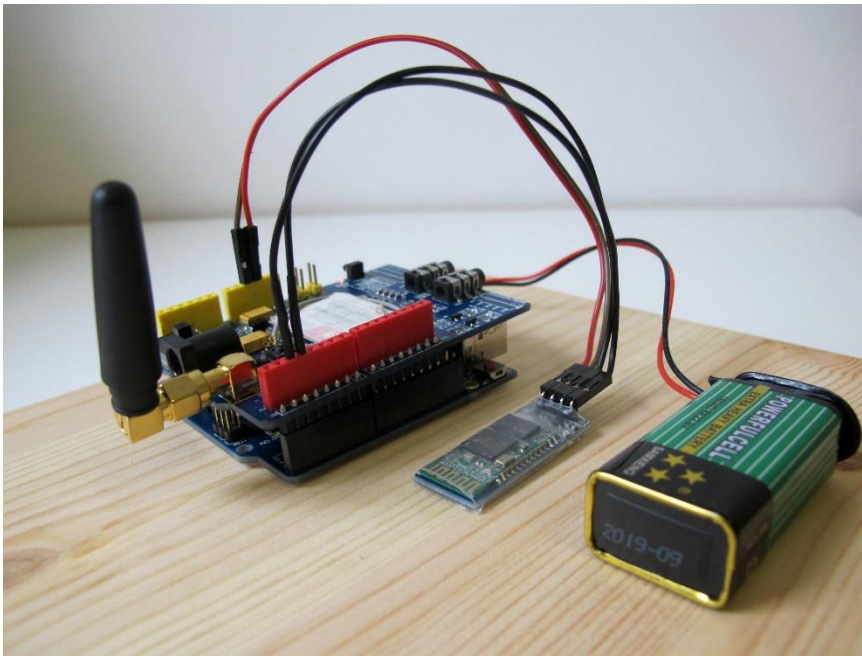

Planted PersonaaS

Finally

