



— FIELD JOURNAL OF —

*Christiane Schütter*

*28/06/12 - 07/07/12*

0

1/2

1

1/2

2

1/2

3

1/2

4

1/2

5

## WELCOME

Welcome to Mildred's Lane Comportment Project, an ongoing corporeal practice and discourse on how we exist as cultural producers on this planet in diverse environments with intercultural courtesies.

We hope that you will graciously contribute to this project's concern as a dialogue that will affect your future comportment in all earthly engagements.

At Mildred's Lane, we feel that education should be principally involved in the development of modes of life – what we are calling workstyles. In this attempt to collectively create new modes of being in the world – this idea incorporates questions of our relation to people, to the environment, systems of labor, forms of dwelling, and clothing apparatuses – all of which encompass an ethics of comportment – all are embodied in what we call workstyles.

Workstyles is any practitioner's autobiographical and experiential making-doing-thinking process that is inter- and intra-relational – active system thinking. It involves a highly intuitive aestheticism and understanding of how things influence each other within a whole, through “cyclical thinking and doing rather than linear intentions and outcomes.” One attains workstyles by being creatively engaged with the surrounding environment of things and others at all times.

These relations grow out of the materially complex discipline of installation art, but remain theoretically rich and grounded in the quotidian tactics of "getting by." Reassembling is a way to rethink with what we have and what can be done with what is at hand. With an emphasis on caring for each other and about the topics that drive us, our comportment brings us more closely together in all areas of our lives.

Why is this all so important? So many people come in and out of Mildred's Lane and these courtesies toward each other are paramount in helping you make this a shared experience.

The international participants of Mildred's Lane, who come from all disciplines, are constantly learning and sharing workstyles centered on highly charged collective topics that are addressed throughout the year. The topics are prompted by artist projects, discourses on expanding notions of dwelling and sustainability, transhistorical and philosophical musings, and this occurs all at once. These short and dense discursive intensives, called sessions, usually feature small groups of students from some of the most outstanding institutions in the world. The students, referred to as Fellows, coevolve workstyling with lecturers and guests throughout the session.

Importantly, please be mindful that this is the Dion/Puett family home – not an institution. Thank you for your sensitive behavior toward the people, their children and our little wilderness.

## COMPORTMENT AS COMMONS

Comportment here means a consideration of our behavior as a constant negotiation with the environment – things and space, human and nonhuman. Rethinking our involvement with all everyday habits – fooding, shopping, making, cleaning, gaming, sleeping, reading, thinking, and doing – we make each gesture a sensitive and sustainable one. This attitude entails attention to what and who is before you, and after, making way for the next gesture and requiring generosity at all times. Such workstyling has no beginning and no end – they make up our lives.

Comportment as commons offers us a way to navigate everyday experience. The term commons is conceptualized as belonging to or affecting a whole community. The turbulent multiplicities of deportment, ethics, etiquette, criticality, and, above all, hospitality allow for comfort and freedom, opening up possibilities for new types of exchange – a new commons.

In parallel to and co-evolving with every research session will be the intensive reconsideration of workstyles. The total space of the domestic will be part of this course of study – we collectively work on the full spectrum of our system of engagements via doing, making, and researching. There are visits to alternative farms, discussions around food and cooking; cleaning and maintenance; and most of all, slowing down the pace with grace in the everyday.

This site is a living, breathing contemporary art complex(ity), and all things, (no matter how banal) are interconnected pieces of other projects, or someone's personal belongings, so please take great care with all things you may come across. Please do not take things away from Mildred's Lane and do not use a thing for something without investigating its purpose first. Most staff members are familiar with all things.

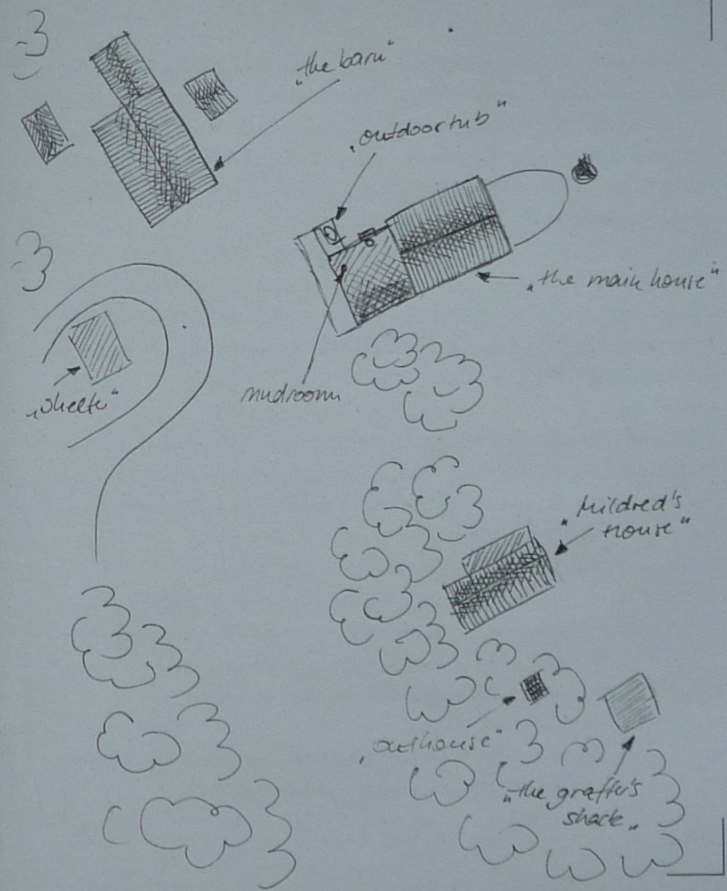
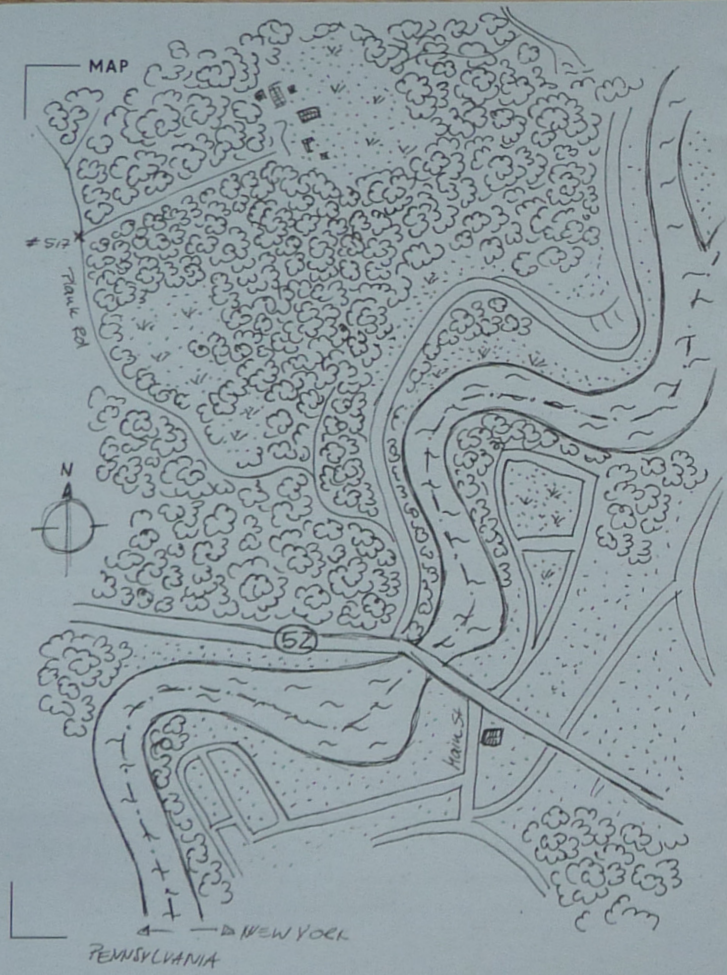

## LEAVE NO TRACE

A day at Mildred's Lane requires negotiating a "leave no trace" policy similar to that of the National Park Service, while at the same time encouraging interaction with both human and nonhuman elements. This sensitivity applies not only to the landscape but also to people, animals, outbuildings, and objects/things. One is asked to seek new balance and relationships through the ongoing activation of workstyles.

Living on 95 plus acres means everything takes longer than usual; so, just slow yourself down. Take ease and time in every task and attempt to make another experience with care and consideration of most things. Here, every task takes twice or thrice as long.

Make an effort to try walking and doing as a mindful 'as you go' experience. Grab a task along the way, clean and tidy a space as you pass through it. Help each other. Relax into each chore, making it a thorough and pleasurable event.

- ✘ Smoking inside any of the buildings, or in the common areas is prohibited. If you must smoke, please manage your cigarette butts carefully; do not put them on the grounds, use the sand buckets and trash places around the grounds.
- ✘ Be mindful of the small trees planted around the premises, marked by green pipes or small blue flags.

- ✘ Please make fires in designated fire areas only. Be sure that there are absolutely no fires in the woods. Always stay with a fire — do not leave it unattended, (especially if at the wooded camps), and make sure it is put out at the end of your enjoyment.
- ✘ Never leave candles or lanterns unattended.
- ✘ There is a no shoes policy in all the buildings, except the barn. Please take your shoes off at the door. Kindly do not leave them in the entrance hallway where they quickly populate and become obstacles. If it is raining, there is a mudroom just inside where you can unload your coats, boots, and bags upon entering the building.
- ✘ The main house is where the family and visiting artists live. Please treat it as if you were a loving guest, and respect the privacy of all. Kindly do not make noise after hours, rather use the barn for festive nights.
- ✘ The library is also a WIFI designated computer area. The Barn office is wireless also. Do not leave your computers and personal belongings unattended. Please keep these things in your sleeping quarters or in the mudroom when not being used.

- ✘ Look after your belongings. It's best to take your personal items to your sleeping quarters and keep them there rather than leaving them around in the buildings. If you are not using your equipment, put it away and remove your bags from the common area so that someone else may occupy the place.
- ✘ Always keep your bags, jackets, hats and other belongings in the mudroom at all times.
- ✘ Please treat all the building installations respectfully: knock before you enter a space, mind the tidiness, return borrowed things, etc.
- ✘ A telephone is in the barn office/studio. Although some cell servers do work here, and if you are having trouble getting a signal try the parking area, or the high point halfway up the lane. If you need to use our phone to make a lot of calls you may want to get a phone card for this.

## BATHING

- ✘ We will provide a basket for your personal toiletries so that we don't have overly cluttered bathrooms. Please keep your things in your room.
- ✘ Please be frugal with hot water and keep in mind that several of us want to bathe at once. Take quick hot water baths or showers. Please clean up each area after use for the next person and always remove your belongings—leave no trace.
- ✘ There is an outdoor tub and shower on the deck outside the northwest (NW) toilet. The outdoor facilities are available at all times. If you would like a lovely bathing experience there, we can provide a bathing linen to line the tub. This is a grey water system, so please use biodegradable products only.
- ✘ You do not have to remove your shoes for the northwest corner toilet room as you come from outside, but please always leave it tidy for the next guest.
- ✘ The ground bathroom is a roomy shower, however, it has a slow drain that makes it high maintenance. Please squeegee the basin after showering, and please do not shave in this area—the nature of the basin is rough and would be impossible to get hair off and out of the drain. It is important to pick your hair up from the drain during the clean up so that the water may drain and to clear it for the next person.

- ✘ If you do need a towel, they are kept in the ground bathroom, and you may take one and keep track of it during your stay.
- ✘ The upstairs oversize tub fits at least two people. Be mindful that it has no over-flow, so do not leave it filling unattended or do not fill it too full.
- ✘ Again, for all bathrooms, please leave the facilities clean for the next guests use. There are cleaning agents in all areas, and if not, please ask.
- ✘ We keep additional cleaning agents in the cabinet in the boiler room on the ground floor.
- ✘ We also have an adorable outhouse behind the Mildred's House, (Mildred's Heads); it seats two. Please sprinkle the lime in the hole after each use. You may also use the woods discreetly, but please make sure you are off any paths and use a shovel to bury your territorial markings.
- ✘ For those more adventurous, there is a lovely swimming hole at the stream. You can bathe there as long as you use biodegradable products.

## FOOD

- ✘ Everyone helps to cook and clean and we welcome your artful involvement.
- ✘ Some people put meat or oil products in the compost, but we do not, and this is mostly because that attracts more varmints. We have plenty as it is.
- ✘ In the kitchen, people need all surfaces to prepare food on and to eat from; so your computers will only be in the way if they are there, not to mention the possibility for accidents to happen.



## ANIMALS

- ✘ Please keep all out building (screen) doors shut, especially at night, when the varmints, moths and mosquitoes are out.
- ✘ It is paramount that no food or garbage be left outside or uncovered in your camps or buildings. We have bear and other rascals, and they are quite bold in the hunt for snacks. We must leave the barn doors shut and place dry foods in hanging baskets. All food must be cleaned and put away promptly after each meal or snack.
- ✘ Also, please shut the kitchen recycling window each night so the raccoons don't climb into the house.
- ✘ We encourage bats, as they are now endangered. Please be mindful that there are bats living everywhere, and mostly in the barn during the summer months, so it needs to be swept up daily for all our comfort. Everyone is welcome to take a hand in this activity. The guano is great fertilizer for the garden, so place the dustings in the compost buckets.

Thank you for caring for Mildred's Lane for all others who visit. With your help we hope to continue to build this site becoming.

- Mildred's House -



28/06/12

18:30 Ankunft in Mildred's Lane  
Einzug in das historische Mildred's  
House, 1. Etage mit Tina  
Abendessen mit Morgan & Fellows

29/06/12

8:00 duschen und/oder Außendusche bei  
Sonnenaufgang, danach Frühstück  
Workshop mit Pablo Helgnesa im  
Morgan's Atelier/Schneiderei mit Fellows

30/06/12

Frühstück auf Veranda, Probe mit Pablo  
Vorbereitungen für Social Saturday  
Gastauftritt bei „The Greater American Play“  
anschließend gemeinsames Essen

30/06/12

- Attila-Würmchen -



♀ 8-10mm

31 / 06 / 12

Frühstück auf der Veranda  
Erkundungstour - Steam-  
Vortrag Carolin in der Scheune  
Entspannen am Sonntag

01 / 07 / 12

Frühstück auf der Veranda  
Umzug vom historischen Mildred's  
House ins Haupthaus „Puppenstube“  
Vortrag Felix & Bauhaus Sauna

02 / 07 / 12

Frühstück auf Veranda  
Vortrag in der Scheune Christine  
Vorbereitungen Vortrag unserer Projekte  
Ausflug Burger Essen

01 / 07 / 12



03./07/12

Frühstück auf der Veranda  
Vortrag mit Tina & Katharina  
Ausflug nach Narrowsburg  
Karten schreiben

04/07/12

Independence Day  
Hot Dog Party & Lagerfeuer  
Sauna bauen am Steam  
Vortrag David Wood

05/07/12

Frühstück auf Veranda  
Ausflug nach Monticello zu jüdischer  
Bäckerei, Staples & Wollmatt  
Vortrag Christina Lindem

Hot Dog Party

03/07/12



07/07/12

Abfahrt von Mildred's Lane  
Besuch Eugene in New Jersey  
Shopping bei Anthropology  
Abflug in die Heimat

"the lost german bureaucrat"

Everything packed?  
Did you forget something?  
Why a fake? In what way?  
What do you mean?  
What is it?  
What the hell do you know about it?  
They! Who's "they"?

Crazy!

Crafts Shack

07/07/12



[www.mildredslane.com](http://www.mildredslane.com)

town {project space/storefront};

**THE MILDRED COMPLEX(ity)**

PO Box 454

Narrowsburg Mews

Narrowsburg, NY

USA 12764

#845 252 3554

and country {projects};

**MILDRED'S LANE**

517 Plank Road

Beach Lake, PA.

USA 18405

#570 729 0129

LAHLE U'EMBAKHUJEMENI  
BOARDING PASS

AIRFRANCE 

SCHLUTTER/CHRISTIAN

EMBARQUEMENT/BOARDING	CLASSE	SIÈGE	SEG
PORTE	HEURE	SEAT	
GATE	TIME		
D74	05H 10	<b>06C</b>	070

N  
M  
IDAM

TKNE 0069545011209

