

people in space



























*how can people come
back to the city?*

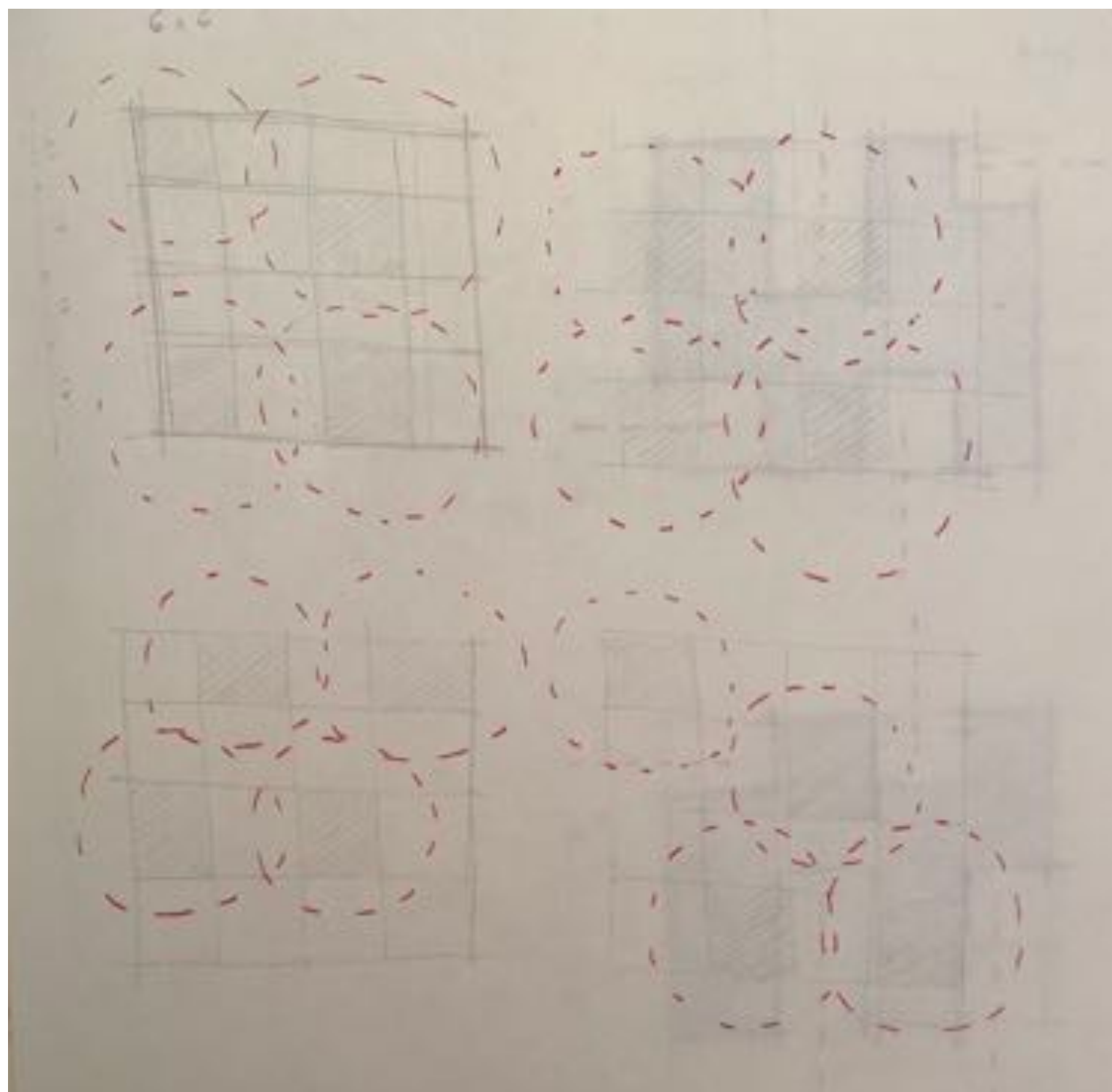

6 x 6 m
grid: 4 x 4
4 people

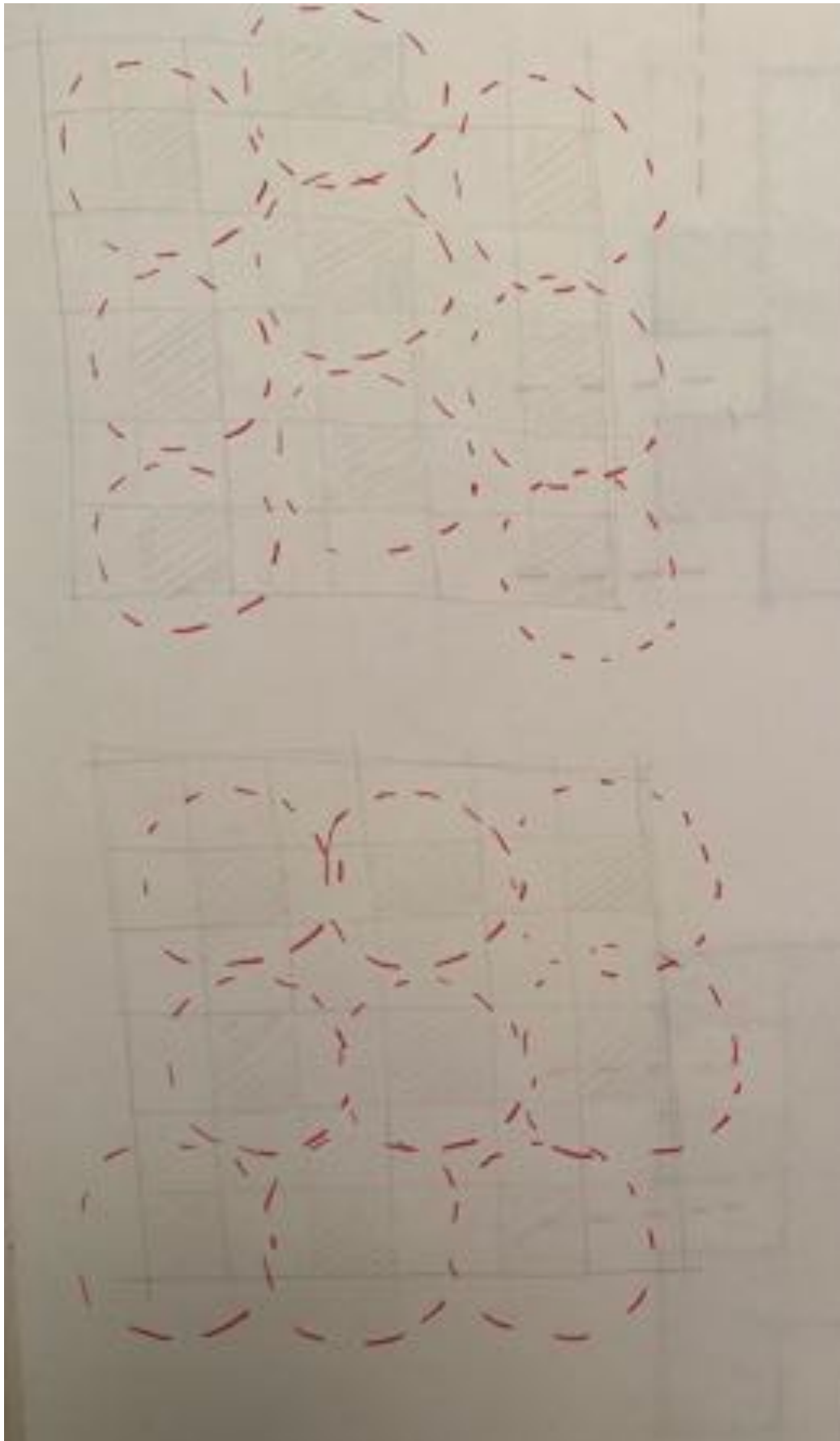

9 x 9 m
grid: 6 x 6
9 people

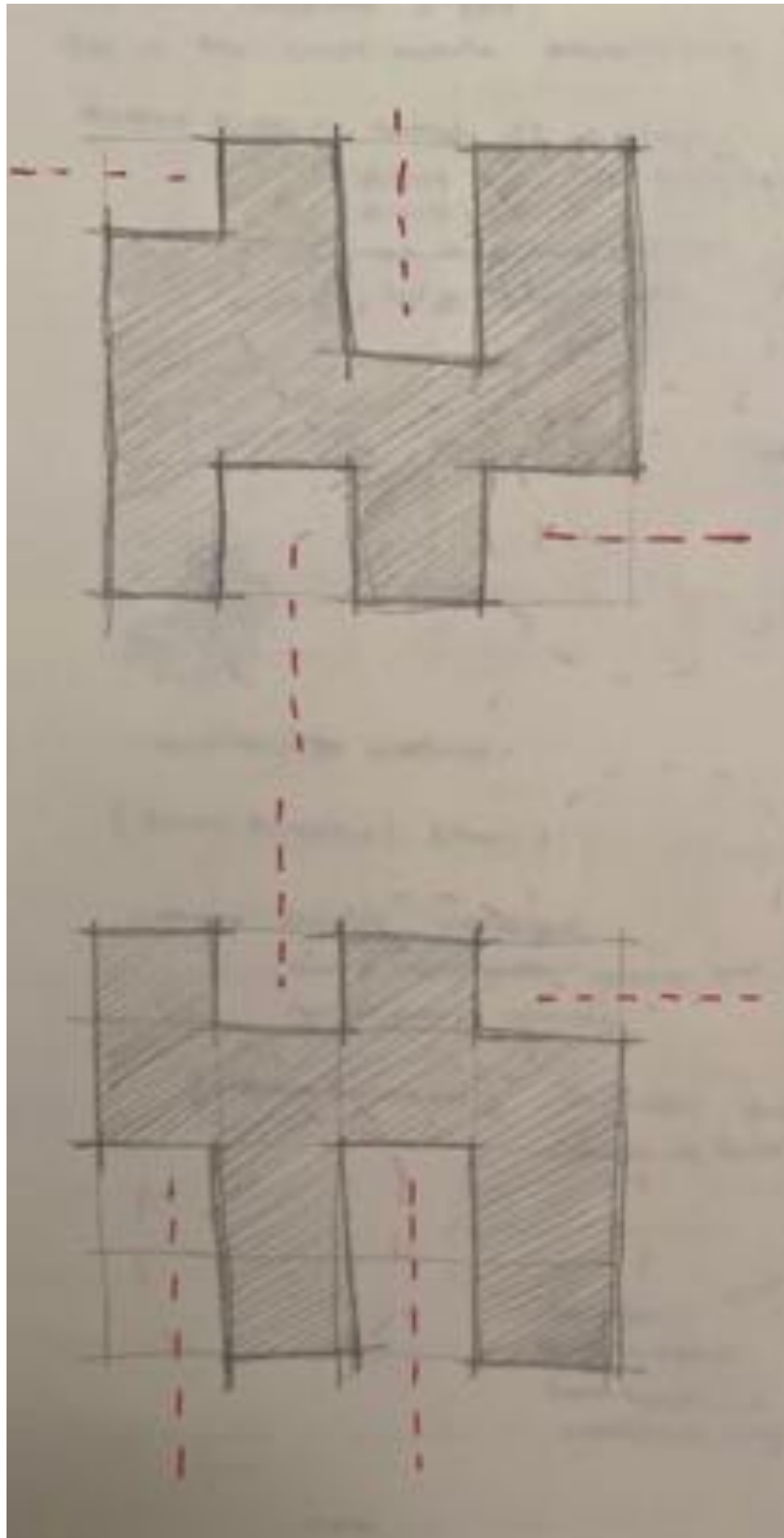

6 x 6 m
grid: 4 x 4
4 people

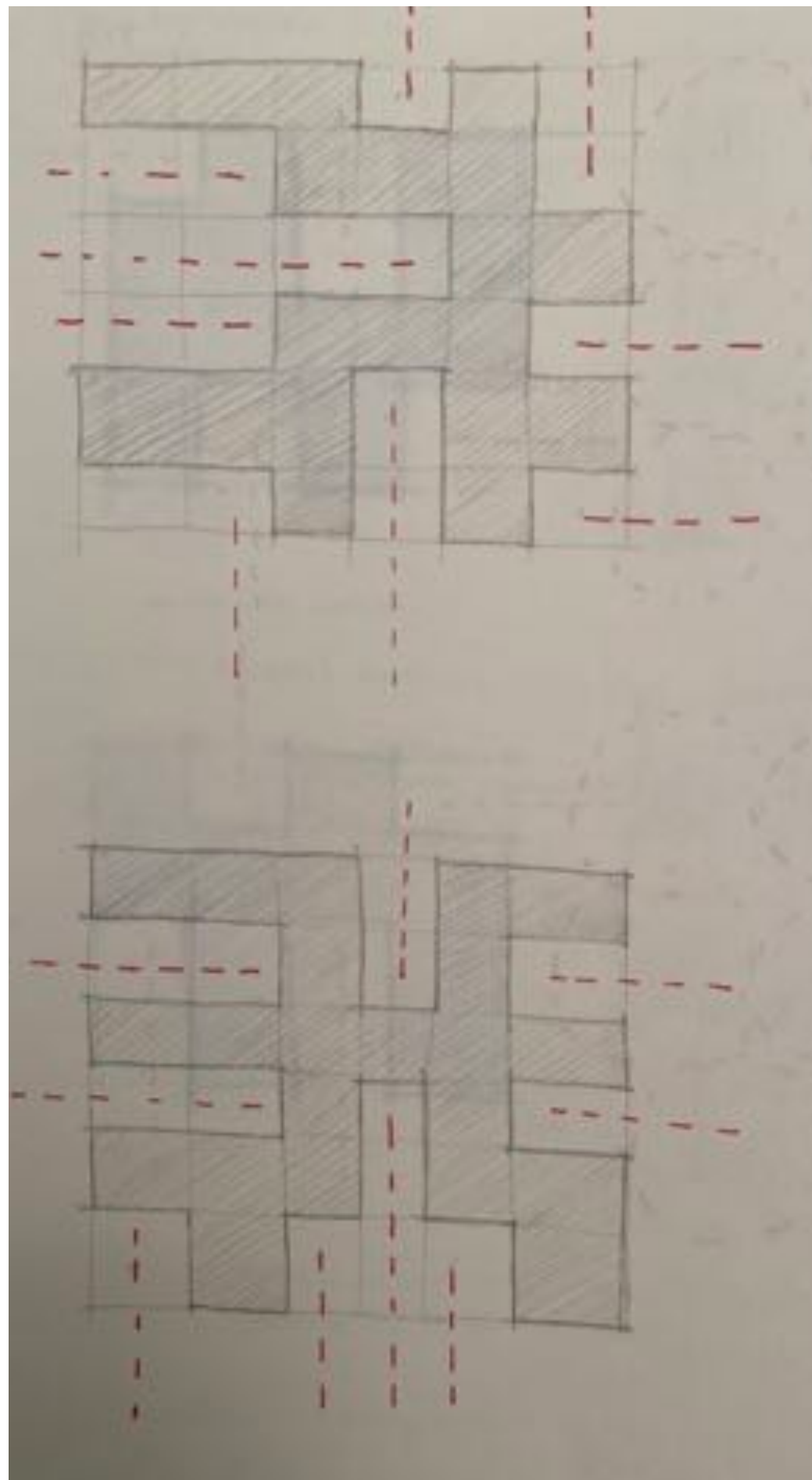

9 x 9 m
grid: 6 x 6
9 people

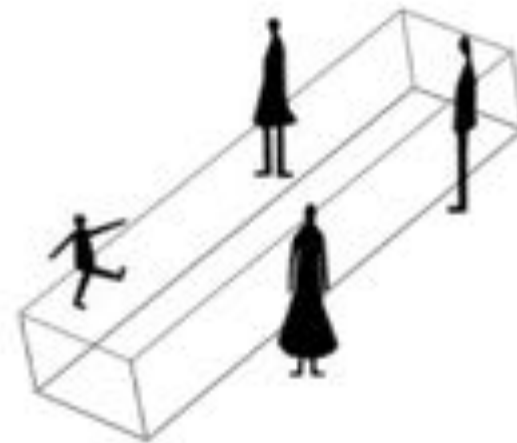

a space for 4 people

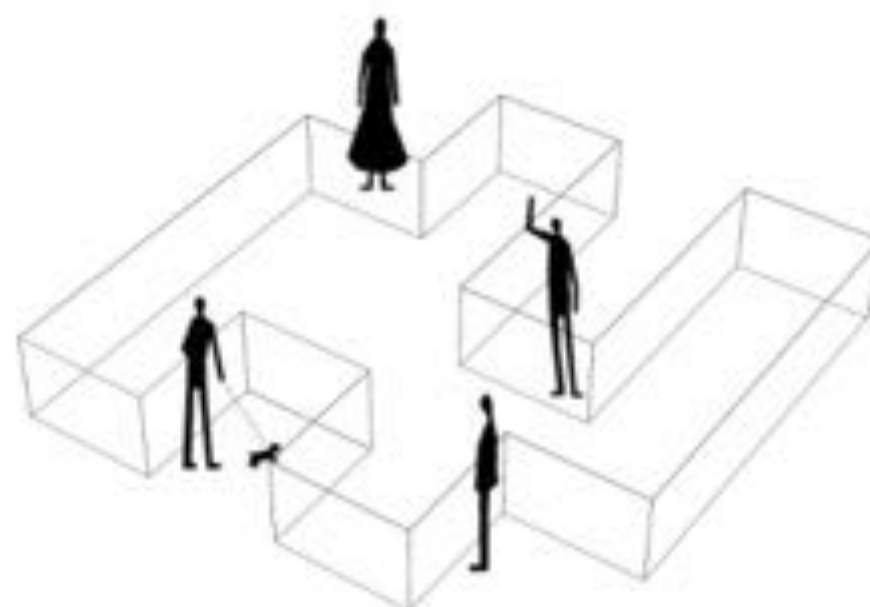
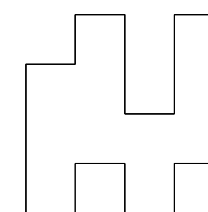

a space for 4 people

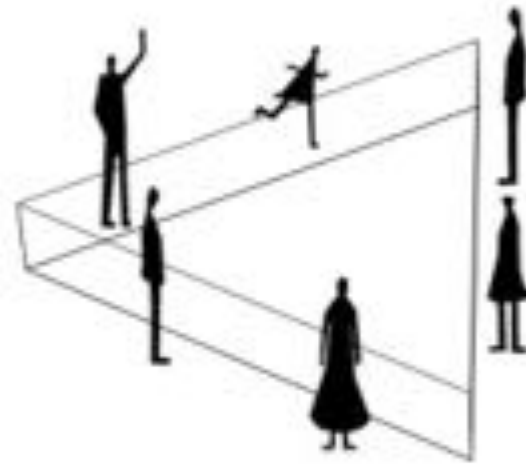
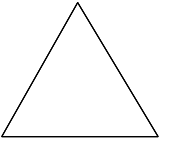

a space for 6 people

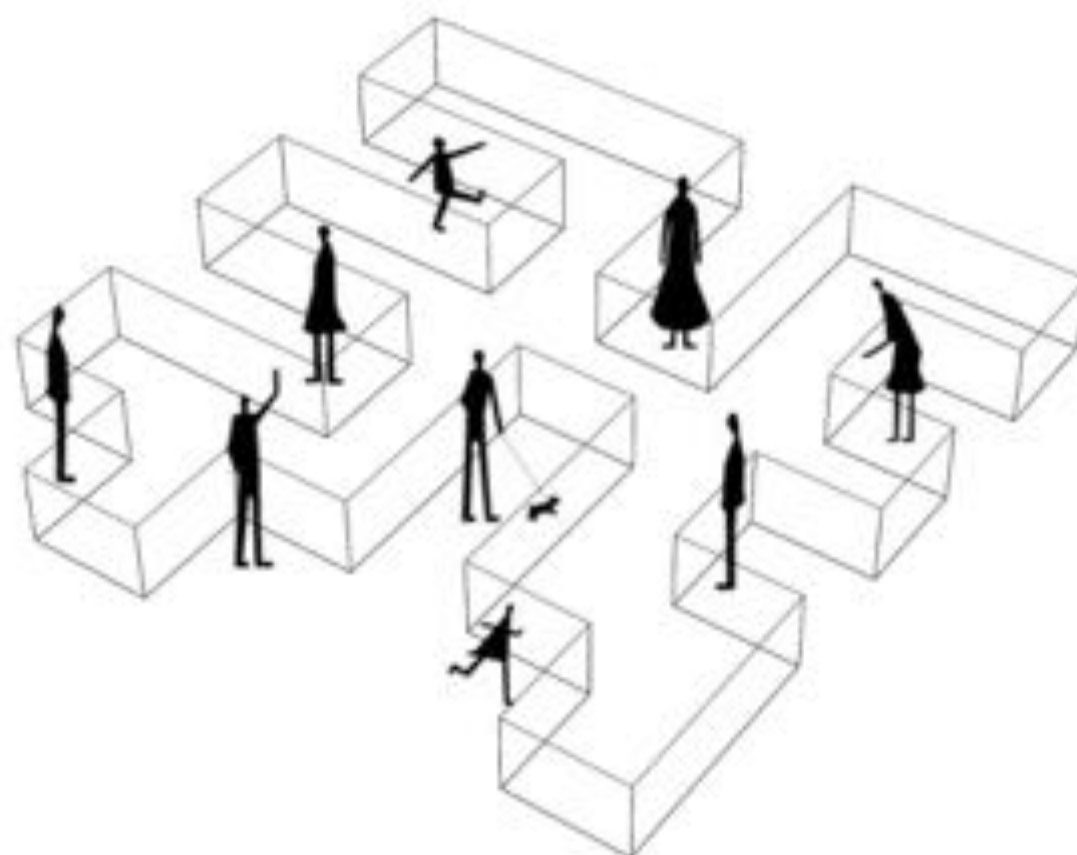
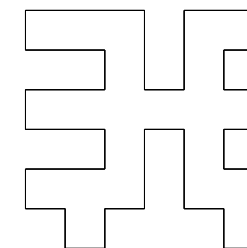

a space for 9 people

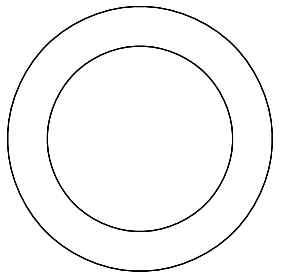

a space for 11 people

Placid small thought no 1

Any cat-owner will rightly tell you that cats inhabit houses much better than people do. Even in the most dreadfully square spaces, they know how to find favourable corners.

Pieces of Spaces, Georges Perec

*how do people
inhabit places?*



STATIC / DYNAMIC

bench/café

stairs

fountain

tower

monument

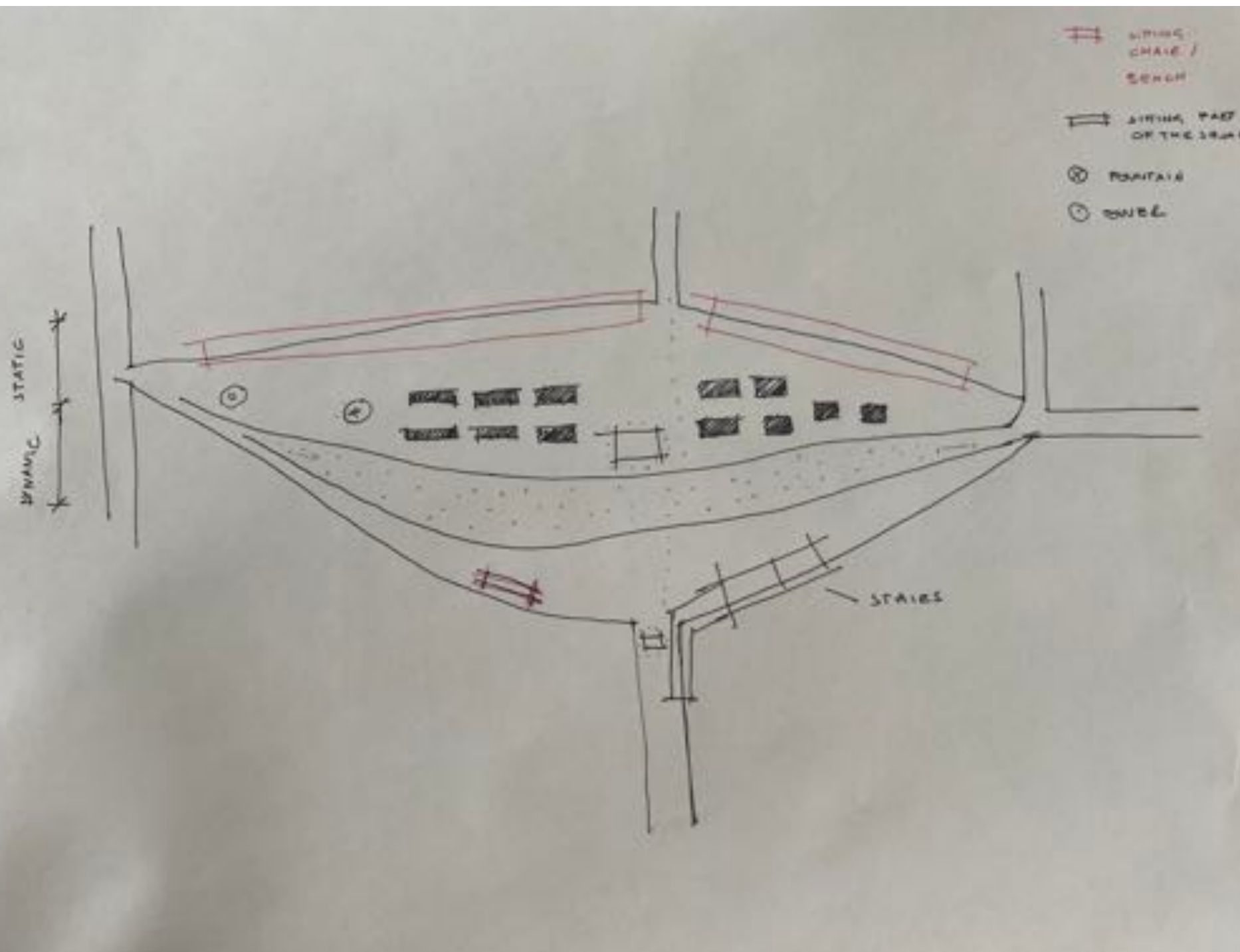



stairs



fountain



monument



monument

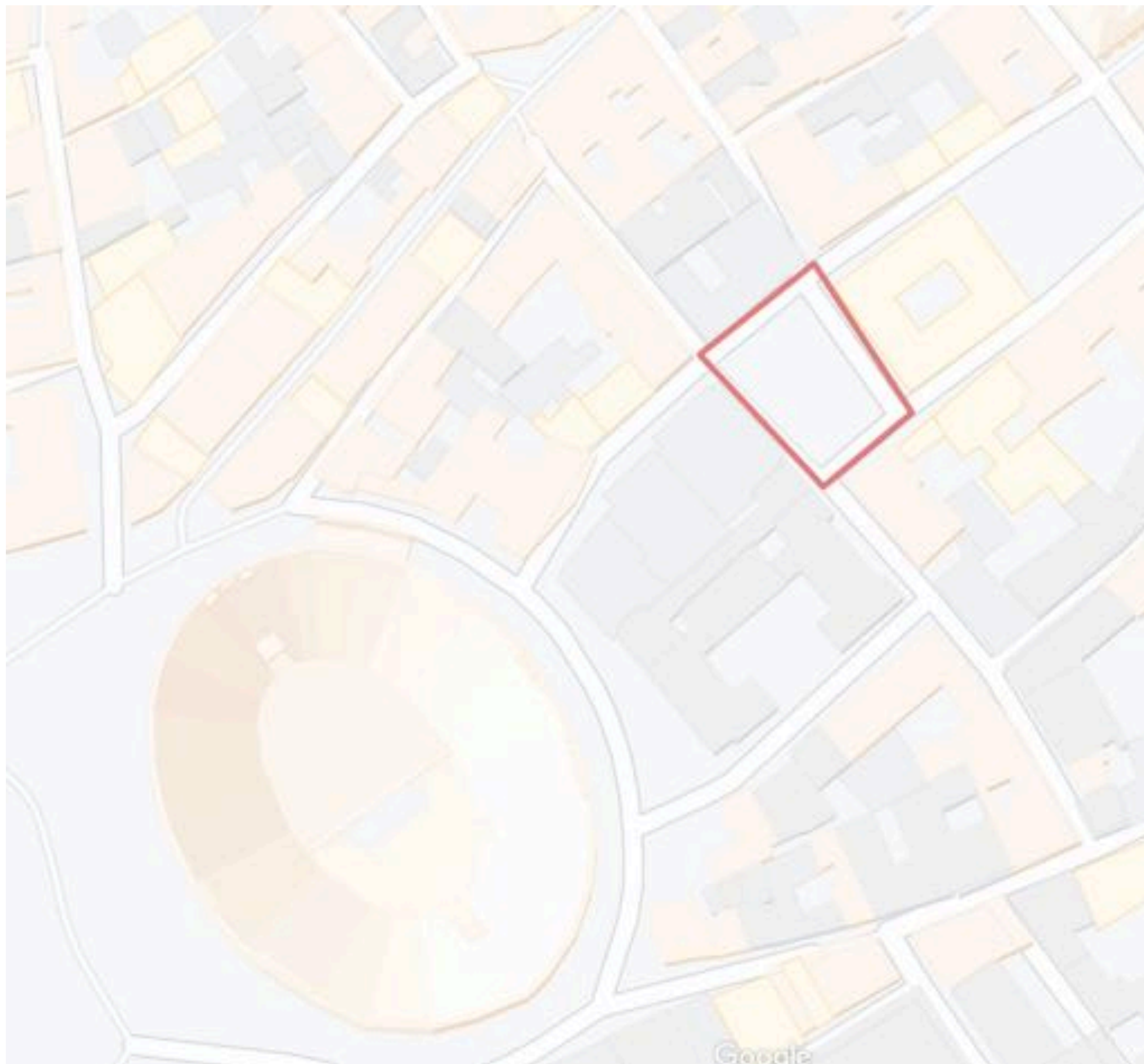

STATIC / DYNAMIC

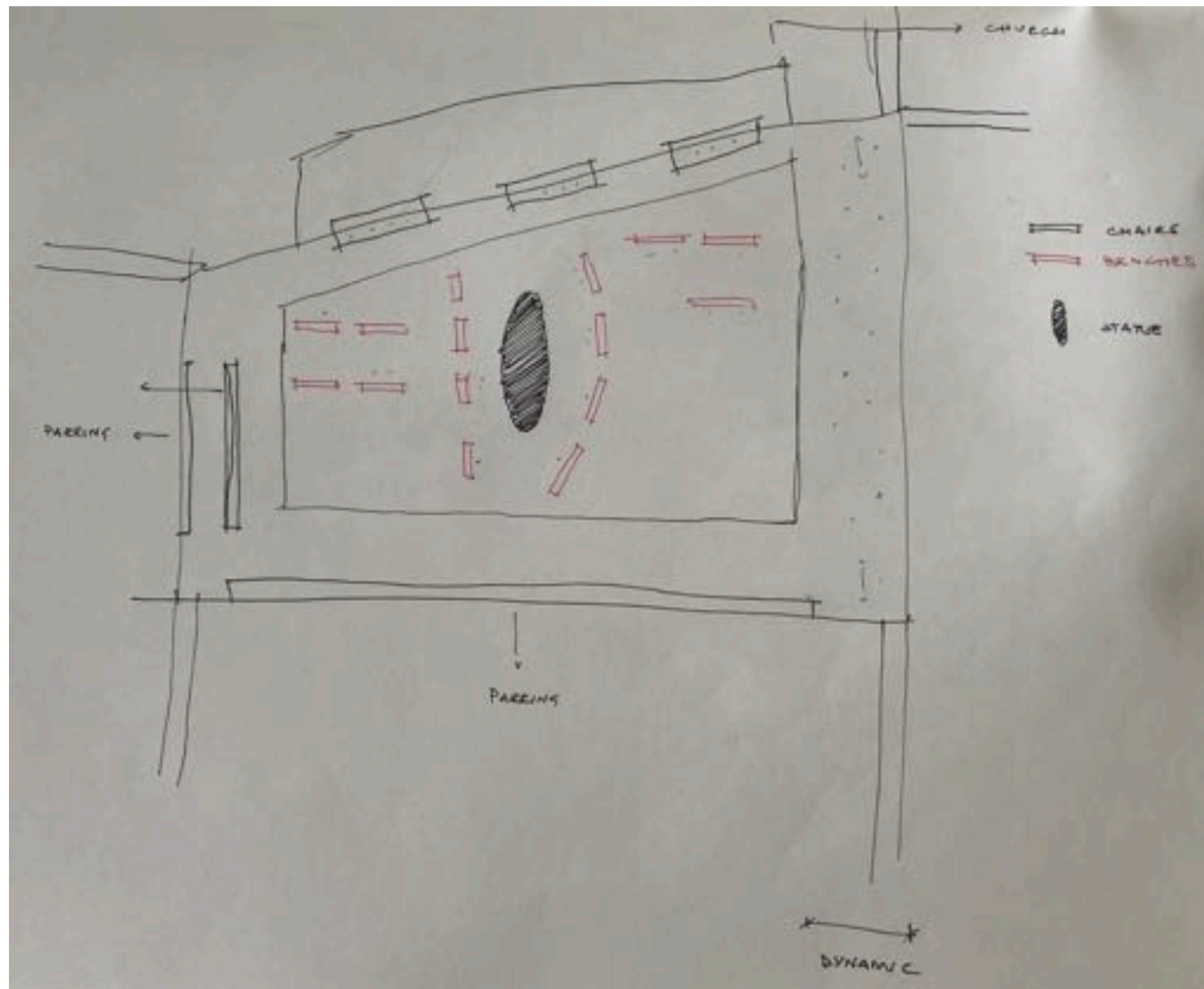

bench

church stairs

statue



bench



church stairs



STATIC / DYNAMIC LIGHT / SHADOW

bench/café
stairs
statue

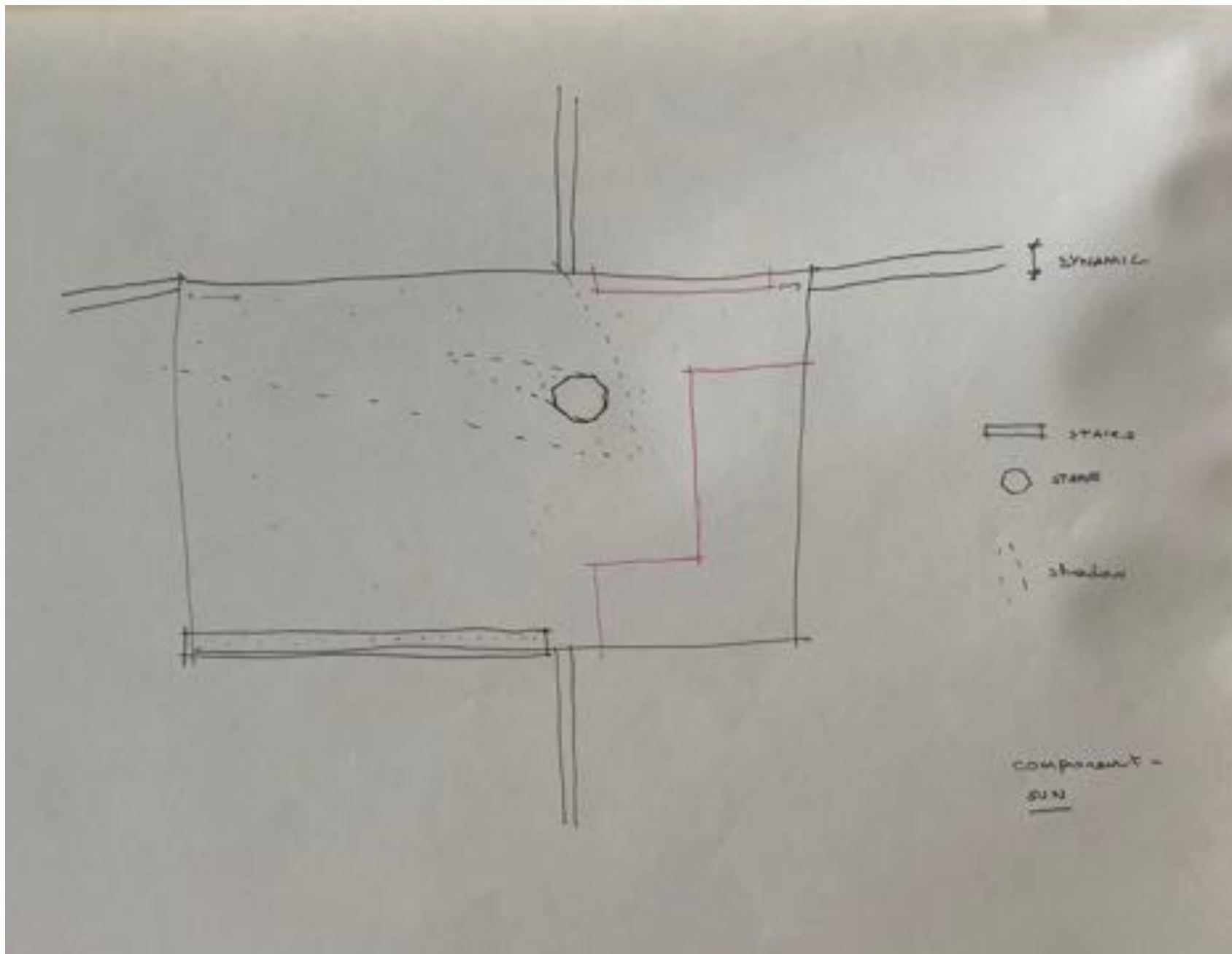



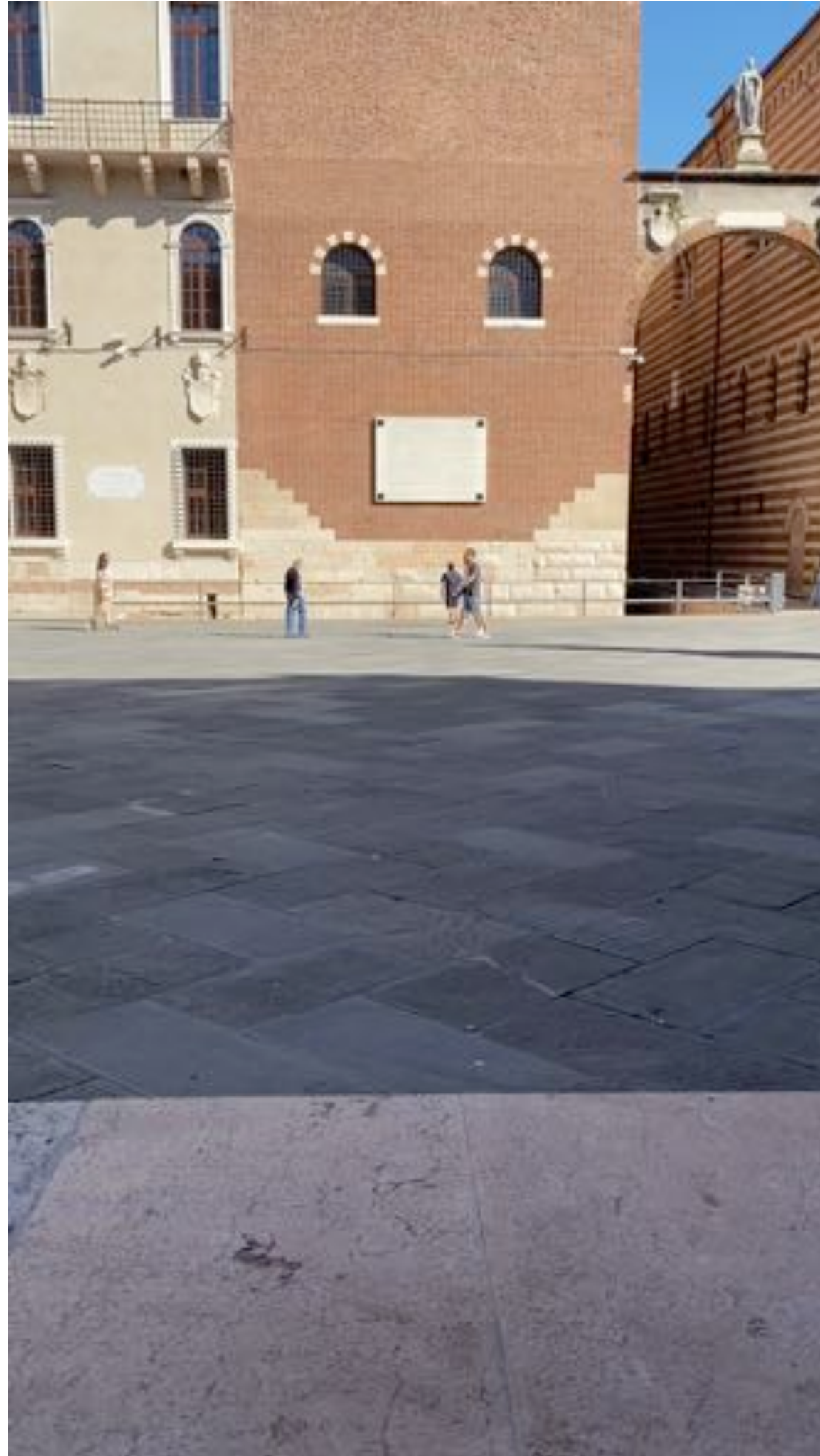



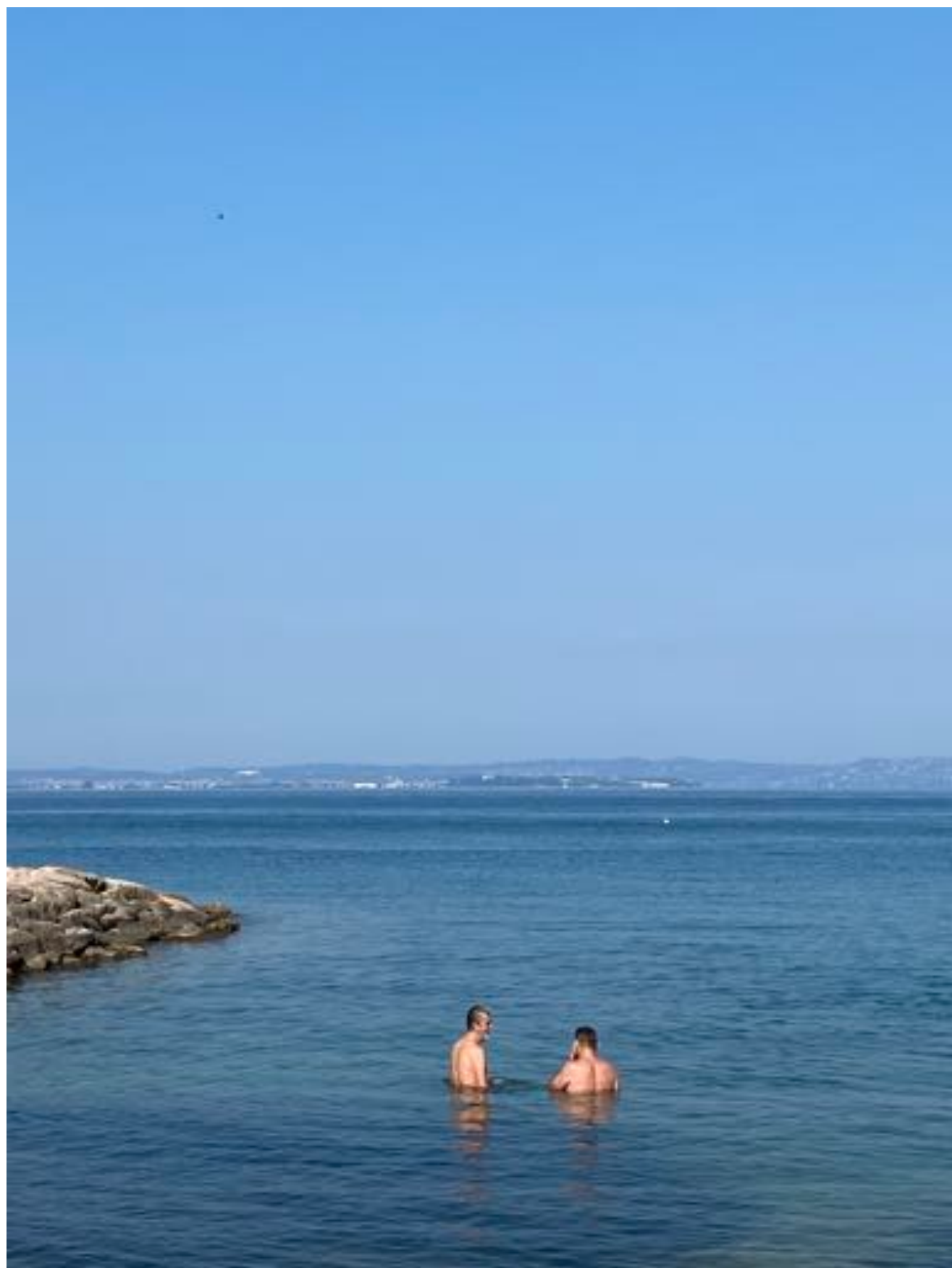











*where do these
assumptions lead
me?*