

---

---

# Introduction to Moodle for Students

— Anh Phuong Le, Michael Völske —

---

---

# Moodle Enrolment

- [Link](#) to the course on Moodle

`https://moodle.uni-weimar.de/enrol/index.php?id=16431`

- Enrolment key: **MachineLearning1920**

# Overview

- Questionnaire
- Group selection
- Exercise submission
- Receive grade

## Introduction to Machine Learning WiSe2019



Nachrichten: Dozent/in an Studierende



jupyter test



Students' Information

Group selection

**Exercise 0**

Exercise 1

Exercise 2

Exercise 3

Exercise 4

Exercise 5

Exercise 6



Submission to Exercise 0



Discussion

# Questionnaire

- We need your information for grading of the exercises
- Please answer these questionnaire soon

## Students' Information

**1 \*** Your Name

**2 \*** Your matriculation number

*Do not use thousands separators.*

**3 \*** How many credits do you need?

☐ 4.5

☐ 6

**4 \*** Your Program

☐ CS4DM

☐ MI

☐ CSM

☐ HCI (2018 or earlier)

☐ DE

☐ HCI (2019 or after)

☐ Other

# Group selections

- Work in groups of up to 3 students to submit assignment
- Select your group
- **All group members should have the same ECTS**
- Deadline for joining the group: **25 Nov**

Group selection Exercise 1 Exercise 2 Exercise 3 Exercise 4 Exercise 5 Exercise 6

Please select one of the available groups!

All course assignments should be completed in **small groups of 3 course participants**.

You can **change your group until 10 am on Nov 25**, i.e before submitting the second assignment

 Available groups



Available groups

Choice	Group	Show descriptions	Members / Capacity	Group members	St
<input type="radio"/>	01		0 / 3		
<input type="radio"/>	02		0 / 3		
<input type="radio"/>	03		0 / 3		
<input type="radio"/>	04		0 / 3		
<input type="radio"/>	05		0 / 3		
<input type="radio"/>	06		0 / 3		
<input type="radio"/>	07		0 / 3		
<input type="radio"/>	08		0 / 3		
<input type="radio"/>	09		0 / 3		
<input type="radio"/>	10		0 / 3		
<input type="radio"/>	11		0 / 3		
<input type="radio"/>	12		0 / 3		
<input type="radio"/>	13		0 / 3		
<input type="radio"/>	14		0 / 3		

Available groups

Your choice has been saved

Your selection: 01

Choice	Group	Show descriptions	Members / Capacity	Group members	Hide Group Members
<input checked="" type="radio"/>	01		1 / 3	Le, Anh Phuong	
<input type="radio"/>	02		0 / 3		
<input type="radio"/>	03		0 / 3		
<input type="radio"/>	04		0 / 3		

Remove my choice

# Exercise Instructions

- **Create and run jupyter notebooks using jupyter server on Moodle**
- **Submit 1 pdf file and 1 jupyter notebook**
  - Submitted jupyter notebook should be runnable on Moodle Jupyter Server
- **Comment and document programming exercises extensively**
- **No plagiarism, please!**

# Submission

- Create draft
- Edit draft if necessary
- Submit the (final) solution for grading
- Once submitted, no more changes can be made!

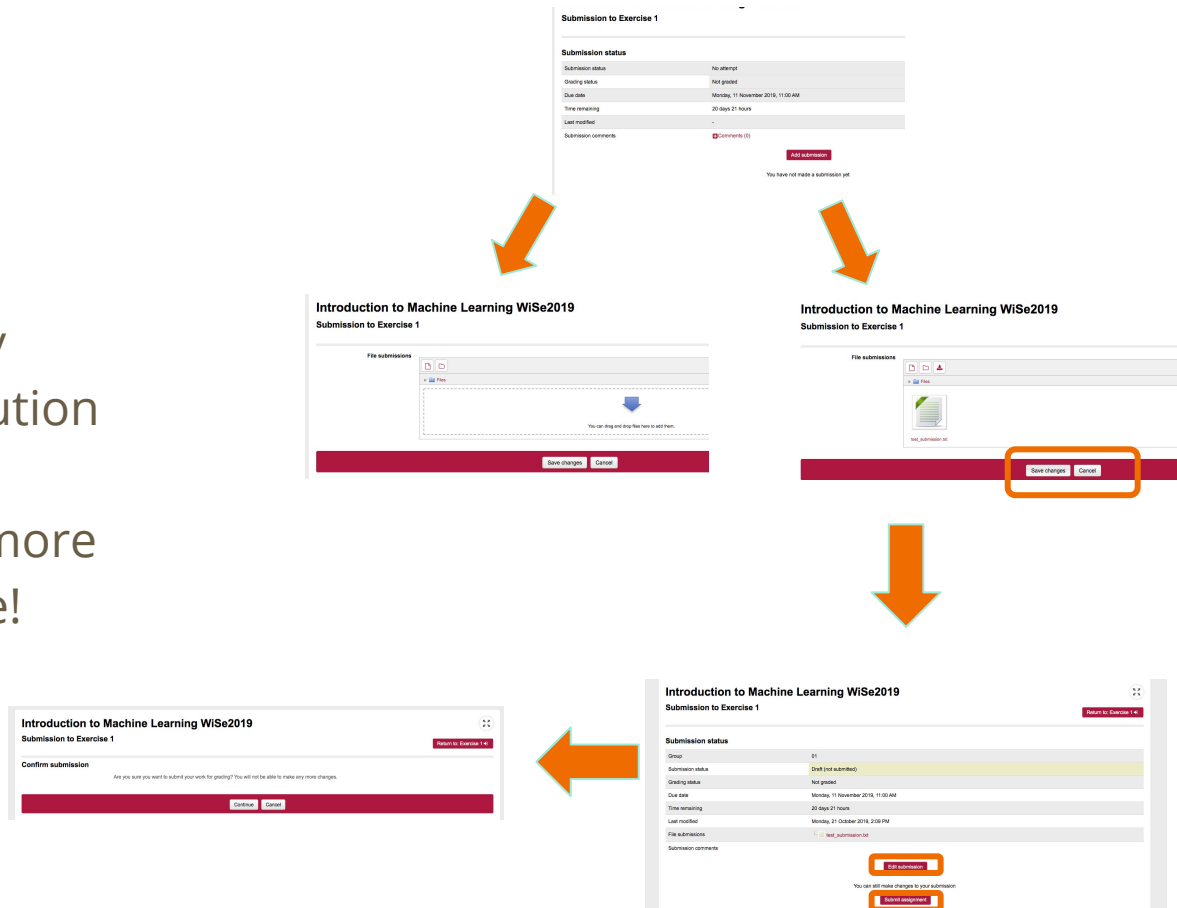

# Receive grades

- When grade is given, an email will be sent to you
- You need  $\frac{2}{3}$  of the maximum (overall grades) for admission to the exam

Introduction to Machine Learning WiSe2019	
Submission to Exercise 1	
Submission status	
Group	01
Submission status	Submitted for grading
Grading status	Not graded
Due date	Monday, 11 November 2019, 11:00 AM
Time remaining	20 days 20 hours
Last modified	Monday, 21 October 2019, 3:10 PM
File submissions	<a href="#">test_submission.txt</a>
Submission comments	<a href="#">Comments (0)</a>



Introduction to Machine Learning WiSe2019	
Submission to Exercise 1	
Submission status	
Group	01
Submission status	Submitted for grading
Grading status	Graded
Due date	Monday, 11 November 2019, 11:00 AM
Time remaining	20 days 20 hours
Last modified	Monday, 21 October 2019, 3:10 PM
File submissions	<a href="#">test_submission.txt</a>
Submission comments	<a href="#">Comments (0)</a>
Feedback	
Grade	20.00 / 30.00
Graded on	Monday, 21 October 2019, 3:11 PM
Graded by	 Anh Phuong Le
Feedback comments	<a href="#">test feedback</a>



# Grades overview

- You can see all grades in the overview

## Introduction to Machine Learning WiSe2019: View: User report

User report

User report - Student Name

Grade item	Calculated weight	Grade	Range	Percentage	Feedback	Contribution to course total
Introduction to Machine Learning WiSe2019						
Submission to Exercise 1	100.00 %	20.00	0-30	66.67 %	test feedback	66.67 %
Σ Course total	-	20.00	0-30	66.67 %		-

### ADMINISTRATION

Grade administration

Overview report

User report